



*jordanfishwick*

GREEN LANE  
Chinley, High Peak





**25 Green Lane, Chinley, High Peak, Derbyshire SK23 6ET**  
**£219,950**



## The Property

\*\*\*WATCH THE VIDEO TOUR\*\*\* Located in the popular village Chinley and ideally positioned for all local amenities, an attractive, stone-built, two bedroom end of terrace. Superbly presented and overlooking a green with golden gravel frontage and enclosed private cottage garden. Pvc double glazing, gas central heating with combi boiler and comprising: entrance porch, living room with wood burning stove, re-fitted dining kitchen with Quartz worktops, stone flagged floor and large pantry, rear utility porch, two first floor bedrooms and bathroom. \*\*\*WOULD SUIT MANY BUYERS\*\*\* Viewing highly recommended. EPC Rating D

## Locality

Chinley is a popular quaint village with many stone-built Victorian buildings and an array of local amenities, primary school and excellent community network. Situated just on the western edge of the Peak District National Park. It is a good base for exploration of the western side of the Peak District and for walks up onto Kinder and its outlying hills. Chinley has direct rail links to Manchester and Sheffield. The nearby towns of Chapel En Le Frith and Whaley Bridge have a wider array of schools, shops, pubs and sporting activity clubs



- Two Bedroom Stone End Terrace
- Immaculately Presented
- Living Room with Wood Burning Stove
- Re-fitted Dining Kitchen with Quartz Worktop & Stone Flagged Floor
- Enclosed Rear Garden
- Rear Utility Porch

Postcode - SK23 6ET

EPC Rating - D

Local Authority - High Peak

Council Tax - Band B





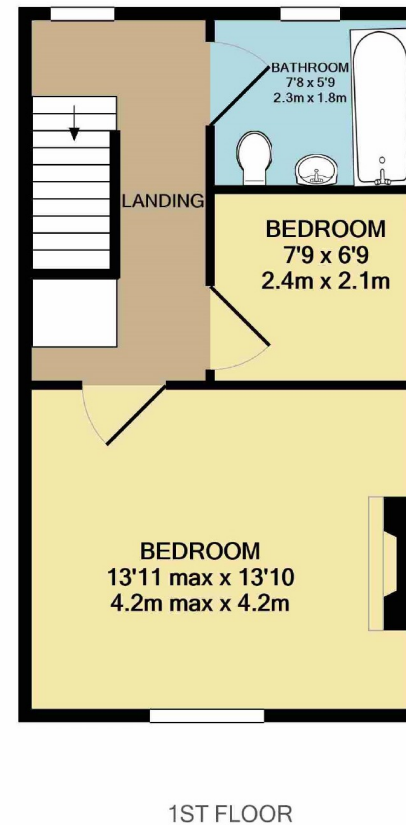
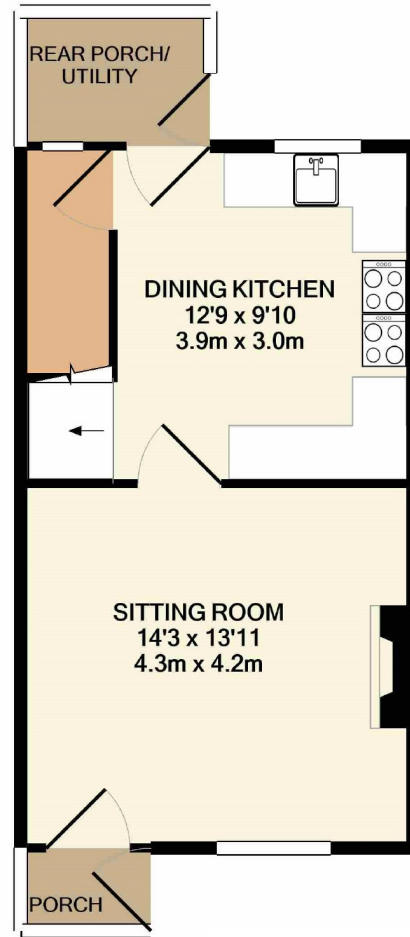

Whilst every attempt has been made to ensure the accuracy of the floor plan contained here, measurements of doors, windows, rooms and any other items are approximate and no responsibility is taken for any error, omission, or mis-statement. This plan is for illustrative purposes only and should be used as such by any prospective purchaser. The services, systems and appliances shown have not been tested and no guarantee as to their operability or efficiency can be given  
Made with Metropix ©2020



These particulars are believed to be accurate but they are not guaranteed and do not form a contract. Neither Jordan Fishwick nor the vendor or lessor accept any responsibility in respect of these particulars, which are not intended to be statements or representations of fact and any intending purchaser or lessee must satisfy himself by inspection or otherwise as to the correctness of each of the statements contained in these particulars. Any floorplans on this brochure are for illustrative purposes only and are not necessarily to scale.

Offices also at: Wilmslow, Macclesfield, Hale, Sale, Chorlton, Glossop, Manchester & Salford

14 Market Street, Disley, Cheshire, SK12 2AA

01663 76 78 78

disley@jordanfishwick.co.uk