

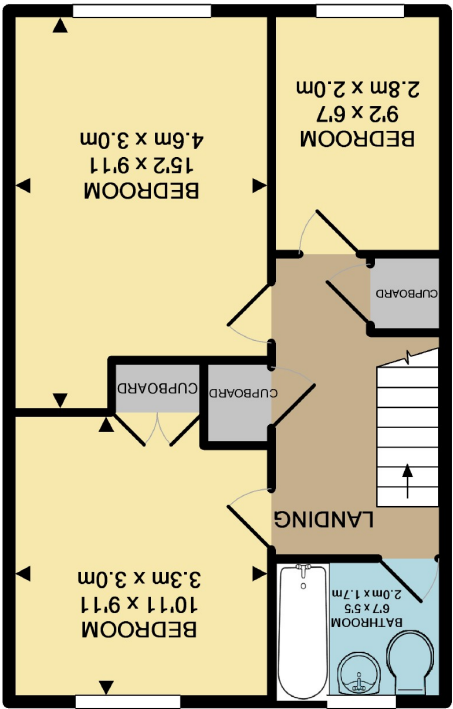

Whilst every attempt has been made to ensure the accuracy of the floor plan contained here, measurements of doors, windows, rooms and any other items are approximate and no responsibility is taken for any error, omission, or mis-statement. This plan is for illustrative purposes only and should be used as such by any prospective purchaser. The services, systems and appliances shown have not been tested and no guarantee as to their operability or efficiency can be given.
Made with Metropix ©2020

57 GYPSEY ROAD, BRIDLINGTON, YO16 4AY
TOTAL APPROX. FLOOR AREA 876 SQ.FT. (81.4 SQ.M.)

1ST FLOOR
APPROX. FLOOR
AREA 430 SQ.FT.
(39.9 SQ.M.)



GROUND FLOOR
APPROX. FLOOR
AREA 446 SQ.FT.
(41.5 SQ.M.)

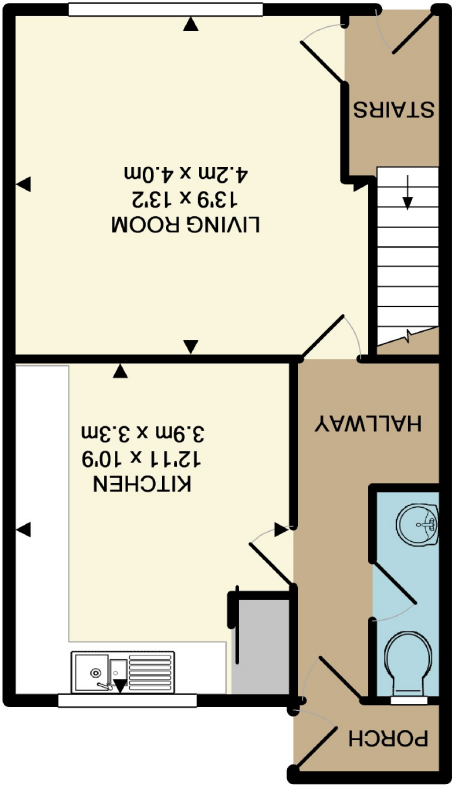

57 Gypsy Road
Bridlington YO16 4AY

Harris Shields
Collection

- ✓ End Terraced House.
- ✓ 3 Bedrooms.
- ✓ Fitted Kitchen.
- ✓ Ground Floor WC.
- ✓ Gas Central Heating.
- ✓ UPVc Double Glazing.
- ✓ Gardens Front and Rear.
- ✓ Open Aspects To Rear.

£89,950 Freehold

Harris Shields Collection

14 Promenade, Bridlington, East
Yorkshire, YO15 2PX

01262 601 704
estateagents@harrisbell.com
www.harrisbell.com

Description

THREE BEDROOM HOUSE....UNDER £90,000.
This terraced former local authority property enjoys Gas Central Heating and UPVc Double Glazing and briefly comprises:
Hallway; ground floor WC; Modern Dining Kitchen; Rear Living Room; 3 Bedrooms and combined Bathroom / WC.
Externally there is an enclosed rear Garden with open aspects over playing fields.
The property is located on the western side of Bridlington, close to the historic Old Town with its varied amenities including shops, schools, sports hall all in the near vicinity.
A great starter home at an affordable price.....arrange a viewing and see for yourself!

Additional Information
Council Tax Band A.



Opening doors
for over 60 years

Harris Shields
Collection