



1 Marlborough Court, Kings Road, Salisbury, Wiltshire, SP1 3TH

£785 PCM

A well presented 2 bedroom ground floor apartment in this prestigious block on Kings Road, a short walk from the town centre. The accommodation comprises: Communal door to entrance hall, door then to own hallway. Re fitted kitchen with wall units, base units and drawers, plumbing and space for washing machine. Electric hob and electric oven. Two double bedrooms, large reception room, re fitted bathroom with WC, basin, bath with thermostatic shower over bath. The property benefits from a communal rear garden with shed and underground parking space with cupboard. Minimum term 18 months. UNFURNISHED.

# Ground Floor

Approx. 53.9 sq. metres (580.7 sq. feet)

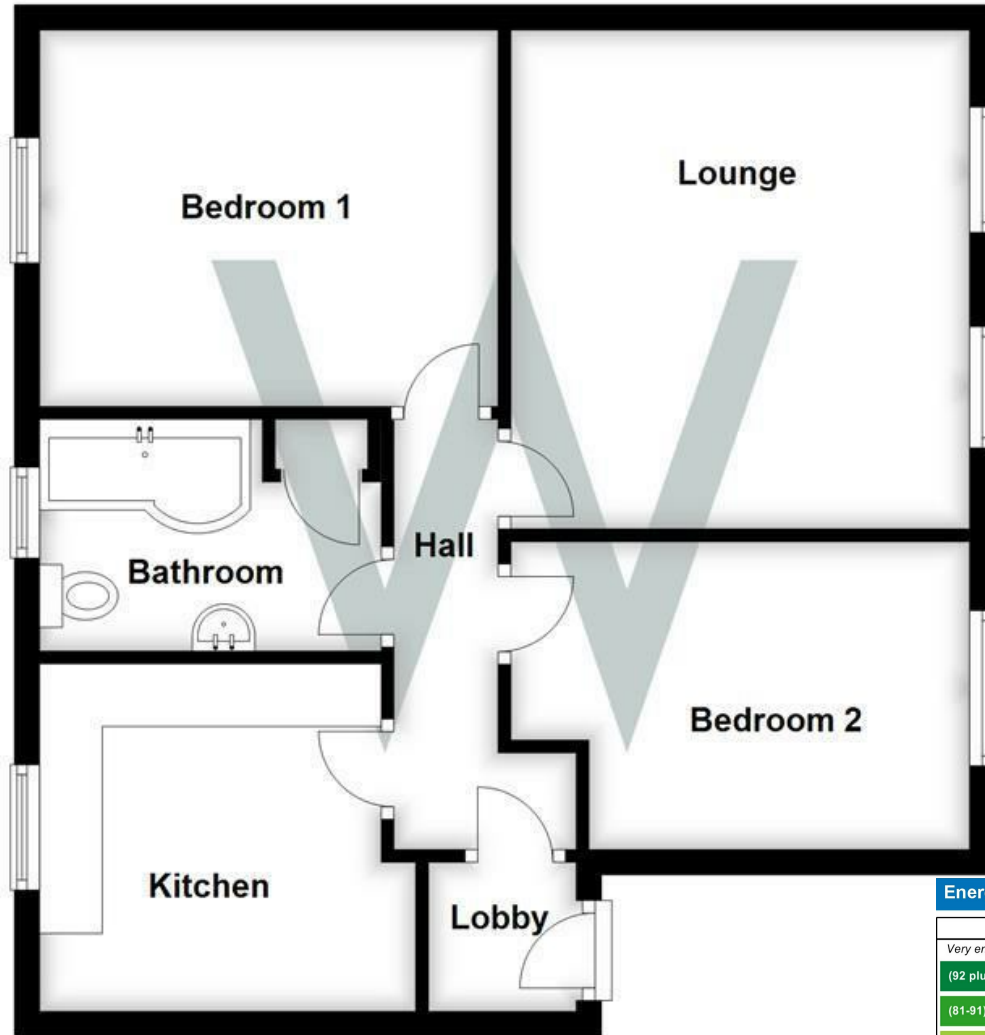

Total area: approx. 53.9 sq. metres (580.7 sq. feet)



Energy Efficiency Rating		Current	Potential
<i>Very energy efficient - lower running costs</i>			
(92 plus) <b>A</b>			
(81-91) <b>B</b>			
(69-80) <b>C</b>		69	75
(55-68) <b>D</b>			
(39-54) <b>E</b>			
(21-38) <b>F</b>			
(1-20) <b>G</b>			
<i>Not energy efficient - higher running costs</i>			
<b>England &amp; Wales</b>		EU Directive 2002/91/EC	

**WHITES**  
 Castle Chambers, 47 Castle Street,  
 Salisbury, Wiltshire, SP1 3SP  
 01722 336422  
[www.hwwhite.co.uk](http://www.hwwhite.co.uk)  
[residential-sales@hwwhite.co.uk](mailto:residential-sales@hwwhite.co.uk)

