





Located in the modern development of Repton Park is this immaculately presented three-bedroom semi-detached home with parking that is only two years old and a must see for any first time buyer!

Built by Taylor Wimpey and finished to a high standard throughout, this attractive property offers a beautiful fitted kitchen, light and airy living room and wc to the ground floor. On the first floor you will find three bedrooms, the main having an en-suite shower room and a family bathroom.

The garden is well maintained and a good size and there

is parking with a car barn to the side of the property.

Repton Park is a modern development offering a mix of modern houses located on the outskirts of Ashford, close to countryside walks via Godinton House and The Warren woods, and with good public transport links. The very popular Repton Manor Primary School is within walking distance, along with Waitrose, local pharmacy and Sainsbury's.

- Superb three-bedroom semi-detached family home
- Only two years old
- Parking
- Beautifully presented throughout



Tenure: Freehold

Local Authority: Ashford Borough Council





### Ground Floor

Approx. 43.3 sq. metres (465.6 sq. feet)

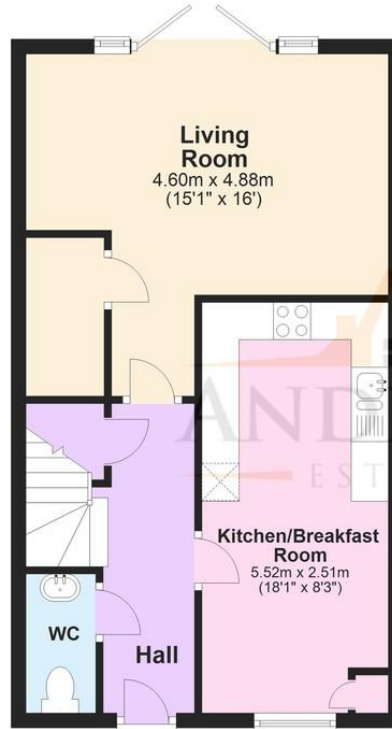

### First Floor

Approx. 41.6 sq. metres (447.2 sq. feet)



**Total area: approx. 84.8 sq. metres (912.8 sq. feet)**

Plans are for layout purposes only and are not drawn to scale, with any doors, windows and other internal features merely intended as a guide.

Plan produced using PlanUp.