





### Property Summary

To let is this split level maisonette. Located in central Brockley, just 0.3 from Brockley Station and shops/cafes. Briefly: Located on the 2nd & 3rd floors: Entrance Hall, Living Room with balcony. There is a modern stylish kitchen on the next floor there are two further bedrooms with a bathroom. Both bedrooms have small wardrobes. The flat is available from 9th Jan 2024.

### Property Features

- 0.3 Mile to Brockley Station
- Maisonette to rent
- 2 decent bedrooms
- Big Living room
- Balcony
- Modern kitted kitchen
- Wooden floors
- Near to shops/cafes'/bars
- Split level flat
- Available beginning of January





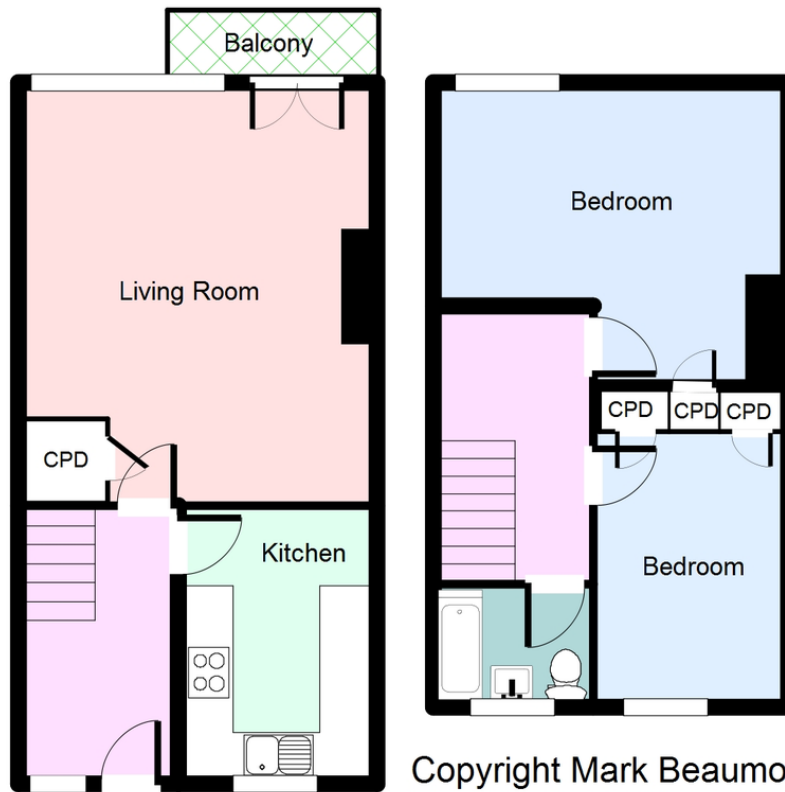

Copyright Mark Beaumont Estate Agents

717 sq. ft

Score	Energy rating	Current	Potential
92+	A		
81-91	B		82   B
69-80	C	77   C	
55-68	D		
39-54	E		
21-38	F		
1-20	G		