

Woodholls



Coppice Way, Aylesbury, HP20 1XQ
£237,000

Offered with no onward chain.

A lovely two bedroom terraced house situated on the Berton side of Aylesbury town. The town centre can be reached in moments and a local mini-market is just a few minutes walk away. The property benefits from two parking spaces to the front.

44 Buckingham Street, Aylesbury, Bucks, HP20 2LL

Telephone: 01296 433 393 Email: info@woodholls.co.uk Website: www.woodholls.co.uk



Ground Floor

Approx. 28.5 sq. metres (306.3 sq. feet)



First Floor

Approx. 27.9 sq. metres (300.5 sq. feet)

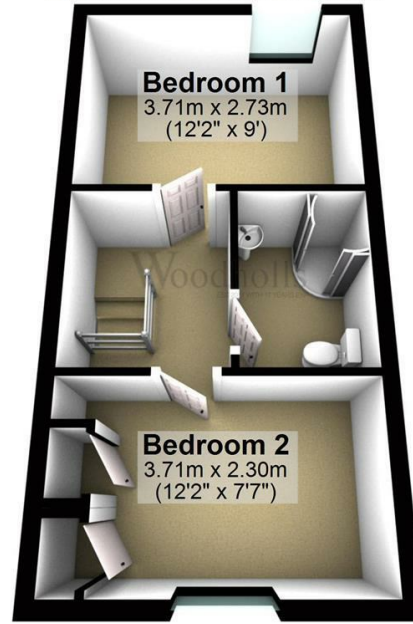

Total area: approx. 56.4 sq. metres (606.7 sq. feet)



Energy Efficiency Rating		
	Current	Potential
Very energy efficient - lower running costs		
(92 plus) A		93
(81-91) B		
(69-80) C		
(55-68) D	54	
(39-54) E		
(21-38) F		
(1-20) G		
<i>Not energy efficient - higher running costs</i>		
England & Wales EU Directive 2002/91/EC		
Environmental Impact (CO ₂) Rating		
	Current	Potential
Very environmentally friendly - lower CO ₂ emissions		
(92 plus) A		79
(81-91) B		
(69-80) C		
(55-68) D	51	
(39-54) E		
(21-38) F		
(1-20) G		
<i>Not environmentally friendly - higher CO₂ emissions</i>		
England & Wales EU Directive 2002/91/EC		

44 Buckingham Street, Aylesbury, Bucks, HP20 2LL

Telephone: 01296 433 393 Email: info@woodholls.co.uk Website: www.woodholls.co.uk