



Greensleeves



Greensleeves

Annings Lane, Burton Bradstock, Dorset DT6 4QN

Hive Beach/Jurassic Coast 0.8 Miles Bridport 3 Miles

An individual detached chalet-style home set in just under half an acre and offering extensive, versatile accommodation close to the centre of Burton Bradstock.

- Prime Coastal Village
- Annexe Potential
- Set in Approximately 0.5 of an Acre
- Double Garage and Studio/Office
- Extensive, Versatile Accommodation
- Total 5 Bedrooms, 3 Bathrooms
- Charming, Private Gardens
- Through Driveway Offering Ample Parking

Guide Price £780,000

THE PROPERTY

Greensleeves is a large, individual chalet-style property located in a peaceful position close to the centre of Burton Bradstock and therefore within easy reach of the stunning Jurassic Coast and glorious West Dorset countryside. Under the current ownership, which has spanned the past 30 years, the property has been greatly improved and has been carefully maintained throughout including recent updating of the central heating boiler, upgrading of the plumbing, rewiring in 2003 and external redecoration in 2020. As a result of a series of internal alterations and thoughtful enlargements, the accommodation is extensive and highly versatile with scope to create a self-contained annexe. Set within just under half an acre of well-kept gardens, this is a wonderful family home suitable for a broad variety of lifestyles.

The accommodation is family-orientated with a healthy balance of living, sleeping and domestic areas alongside great storage throughout. On the ground floor there are up to five reception rooms including a large sitting room with a stone fireplace, a charming sun room overlooking the garden, a dining room with two large windows to the front aspect, a recently replaced conservatory to the side and a snug/study which could also be used as a ground floor bedroom if required. There is also a kitchen/breakfast room with a door to the rear garden and adjoining gardener's loo, a utility room (or annexe kitchen) and a bathroom.



The first floor accommodation is divided into two areas which works well for an annexe arrangement, an extended family or those expecting regular guests. From the sitting room the principal staircase to a wide landing which gives access to four well proportioned bedrooms and the family bathroom. The largest bedroom is one of the many superb additions by the current owners and includes an ensuite shower room and excellent built-in wardrobes. A secondary staircase from the dining room leads up to a further double bedroom with an ensuite washroom.

OUTSIDE

Greensleeves enjoys generous, level gardens amounting to just under 0.5 of an acre with the house positioned close to the centre of the plot. To the front, the property is approached by a through driveway and is separated and well screened from the public road by a well stocked front garden. The garden continues to the side of the property to the rear and is beautifully laid out, being primarily laid to lawn with attractive, established borders and an ornamental pond. Double doors from the sun room open onto a paved sun terrace which is a lovely setting for al fresco dining, entertaining and relaxing.

A further asset to the property is the detached studio/office which is located in the rear garden and, benefitting from electricity and telephone connections, is perfect for working from home or for keen hobbyists. There is also a sizeable detached former garage.

SITUATION

Greensleeves enjoys a peaceful position within the favoured village of Burton Bradstock which lies on the coast and is considered to be one of the most attractive and sought-after villages in West Dorset. It is a Conservation Village and the centre consists mainly of period stone and thatched cottages for the area is particularly well known. There are excellent local amenities including a shop/garage, Post Office, library, public houses, church, village hall and popular primary school. There is an excellent beach which forms part of the Jurassic Coast World Heritage Site and the area as a whole is designated one of Outstanding Natural Beauty. Virtually on the doorstep there are public footpaths giving easy access to open countryside, riverside walks and to the beach and clifftops beyond.

The thriving market town of Bridport and the harbour/coastal resort of West Bay with its 18 hole golf course are both within about 3 miles to the west. The beautiful coastal road is also nearby, giving access to the larger towns of Dorchester and Weymouth, both with mainline rail services to London and the West Country.

SERVICES

Mains water, drainage, electricity and gas. Gas fired central heating.

VIEWINGS

Strictly by appointment with Stags Bridport office, telephone 01308 428000.

DIRECTIONS

From Bridport follow the B3157 coastal road to Burton Bradstock and turn left by the Anchor Inn into Shadrach. After a short distance turn right into Annings Lane and the property can be found on the left just before the turning into Northover Close



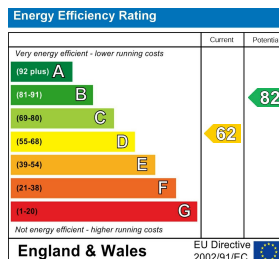
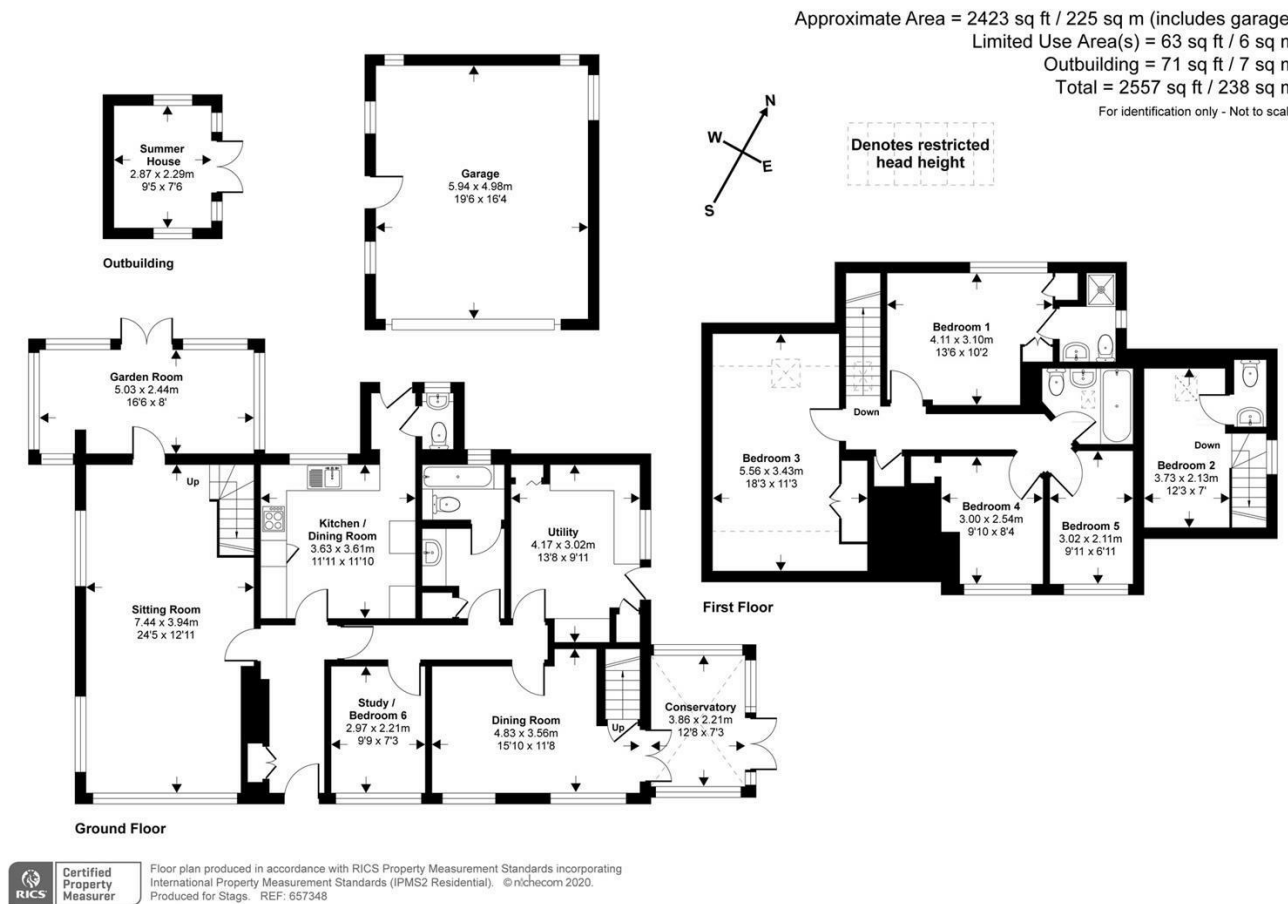

32 South Street, Bridport, Dorset, DT6 3NQ

bridport@stags.co.uk

01308 428000



@StagsProperty

Cornwall | Devon | Somerset | Dorset | London