

Stride & Son is the trading name of Stride & Son Limited. Registered Office: 4 Dukes Court, Bognor Road, Chichester, West Sussex, PO19 8FX  
 Registered in England Company Number: 5724455  
 Either: Messrs. Stride & Son for themselves and for the Vendors or Lessors of this property whose agent they are give notice that:  
 1. The particulars are set out as a general outline only for the guidance of intending purchasers or lessees, and do not constitute part of, an offer or contract;  
 2. All descriptions, dimensions, and necessary permissions for use and occupation, and other details are given in good faith and believed to be correct but any intending purchasers or tenants should not rely on them as statements or representations of fact but must satisfy themselves by inspection or otherwise as to the correctness of each of them;  
 3. No person in the employment of Messrs. Stride & Son has any authority to make or give any representation or warranty whatever in relation to this property.

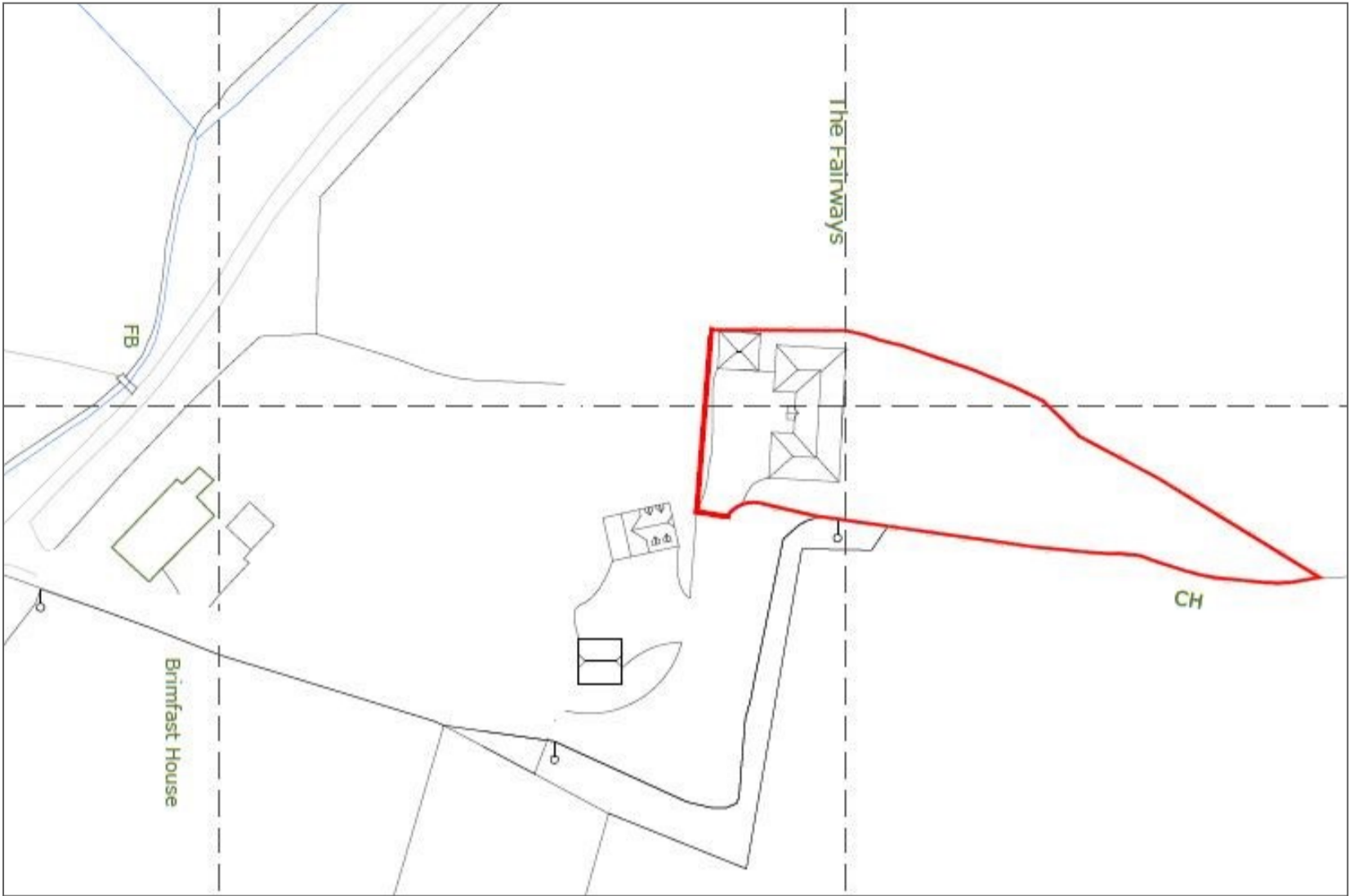

Plan not to scale—for identification purposes only.  
 Plan supplied by vendor.

# STRIDE & SON

Southdown House, St. John's Street, Chichester, PO19 1XQ

Tel: 01243 782626 Fax: 01243 786713

[www.strideandson.co.uk](http://www.strideandson.co.uk)

[properties@strideandson.co.uk](mailto:properties@strideandson.co.uk)



Brimfast Lane, Sidlesham Common



## The Fairways, Brimfast Lane, Sidlesham Common, PO20 7PZ.

Situated in semi-rural surroundings some 3 ½ miles south of Chichester, a building plot (approx. 0.4 of an acre) with detailed planning consent for a detached 4 bedroomed ranch style bungalow extending to just over 1900 sq. ft.

4 bedroomed bungalow plot  
20/00434/FUL

**GUIDE PRICE: £345,000 FREEHOLD**

### DIRECTIONS:

Leave Chichester to the south on the B2145 following signs to Selsey. After approximately 1 mile, have passed through Hunston village, turn left into Brimfast Lane where The Fairways will be found a short distance along on the left hand side.

**Please note: Neither the heating system nor the services have been checked by the Agents.**

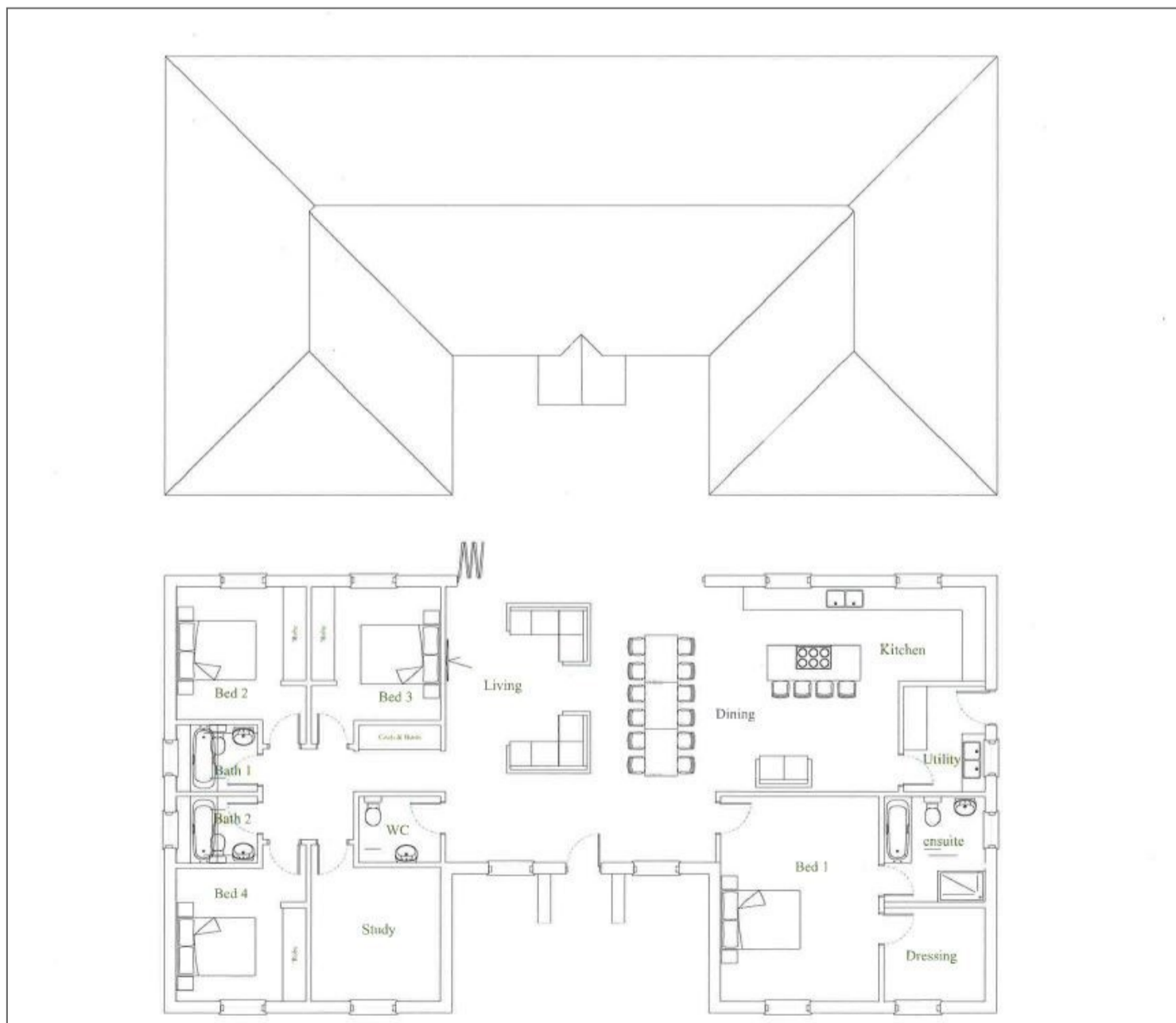

**The Bungalow Floorplan—not to scale**