



14 St. James Road, Southam, Warwickshire, CV47 0LY
£220,000



14 St. James Road, Southam, Warwickshire, CV47 0LY

SSTC BEFORE MARKETING! CALL US TO ARRANGE A FREE VALUATION ON YOUR PROPERTY.

Contact Details

For further information or to arrange a viewing please contact our Southam office, check our website, Instagram or our Facebook page (newmanestateagentsoutham)

Front Of House

Entrance Hall

Kitchen

Downstairs Toilet

Lounge/Diner

Stairs & Landing

Master Bedroom

Bedroom 2

Bathroom

Garden

Further Information

DISCLAIMER: Whilst these particulars are believed to be correct and are given in good faith, they are not warranted, and any interested parties must satisfy themselves by inspection, or otherwise, as to the correctness of each of them. These particulars do not constitute an offer or contract or part thereof and areas, measurements and distances are given as a guide only. Photographs depict only certain parts of the property. Nothing within the particulars shall be

deemed to be a statement as to the structural condition, nor the working order of services and appliances.

Council Tax

Tax Band

Please check tax bands with the link below

<http://cti.voa.gov.uk/cti/inits.asp>



NEWMAN

ESTATE AGENTS

Mark & Lorna Kermode

Your Local Property Professionals

Covering Southam, Bishops Itchington, Harbury, Long Itchington, Napton & Stockton

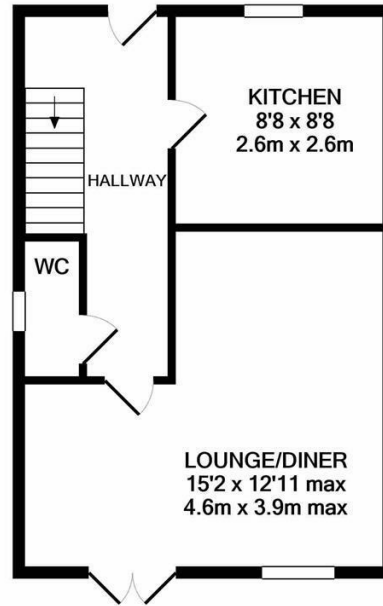

GROUND FLOOR
APPROX. FLOOR
AREA 331 SQ.FT.
(30.8 SQ.M.)

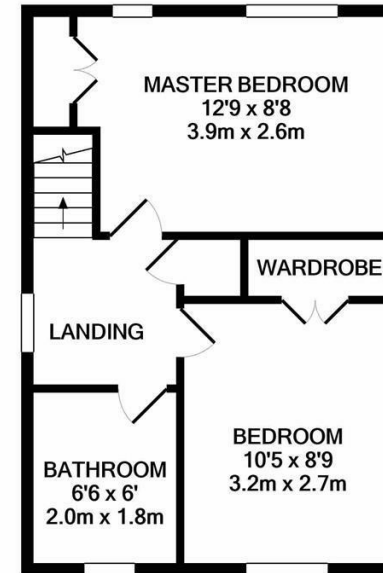

1ST FLOOR
APPROX. FLOOR
AREA 329 SQ.FT.
(30.6 SQ.M.)

TOTAL APPROX. FLOOR AREA 661 SQ.FT. (61.4 SQ.M.)

Whilst every attempt has been made to ensure the accuracy of the floor plan contained here, measurements of doors, windows, rooms and any other items are approximate and no responsibility is taken for any error, omission, or mis-statement. This plan is for illustrative purposes only and should be used as such by any prospective purchaser. The services, systems and appliances shown have not been tested and no guarantee as to their operability or efficiency can be given

Made with Metropix ©2020

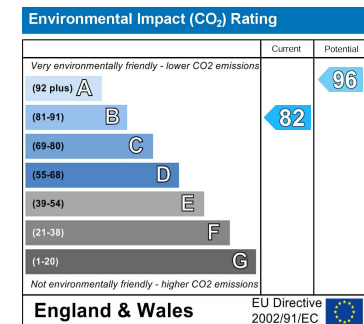
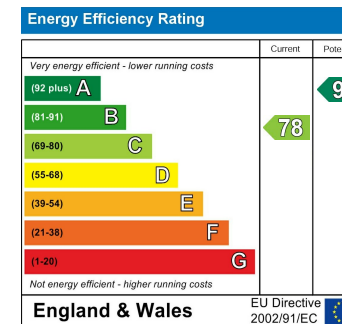

Please Note: All measurements are approximate and quoted in metric with imperial equivalents and for general guidance only and whilst every attempt has been made to ensure accuracy, they must not be relied on. The fixtures, fittings and appliances referred to have not been tested and therefore no guarantee can be given that they are in working order. Internal photographs are reproduced for general information and it must not be inferred that any item shown is included with the property.

