

# North Road, Heath

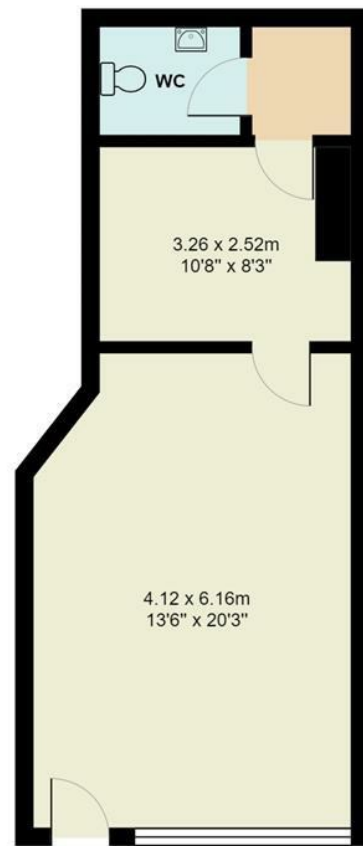

Total Area: 38.3 m<sup>2</sup> ... 412 ft<sup>2</sup>

All measurements are approximate and for display purposes only



Virtual Reality & 3D Scaled models of all of our properties for sale. You can even walk around them on our website



**Pontcanna**  
223-225 Cathedral Road  
Pontcanna, Cardiff  
CF11 9PP

**Roath**  
38 Wellfield Road  
Roath, Cardiff  
CF24 3PB

**Llanishen**  
54 Station Road  
Llanishen, Cardiff  
CF14 5LU

**Cathays**  
89 Woodville Road  
Cathays, Cardiff  
CF24 4DX

029 2049 9680  
info@jeffreycross.co.uk  
www.jeffreycross.co.uk

Jeffrey Ross Ltd. Register in England & Wales. Company No. 0641 1905 VAT No. 944 2898 82

### Agency Disclaimer

Property particulars as supplied by JeffreyRoss Estate Agents are set out as a general outline in accordance with the Property Misdescriptions Act (1991) only for the guidance of intending purchasers or lessees, and do not constitute any part of an offer or contract. Details are given without any responsibility, and any intending purchasers, lessees or third parties should not rely on them as statements or representations of fact, but must satisfy themselves by inspection or otherwise as to the correctness of each of them. We have not carried out a structural survey and the services, appliances and specific fittings have not been tested. All photographs, measurements, floor plans and distances referred to are given as a guide only and should not be relied upon for the purchase of carpets or any other fixtures or fittings Gardens, roof terraces, balconies and communal gardens as well as tenure and lease details cannot have their accuracy guaranteed for intending purchasers. Lease details, service ground rent (where applicable) are given as a guide only and should be checked and confirmed by your solicitor prior to exchange of contracts. No person in the employment of JeffreyRoss Ltd has any authority to make any representation or warranty whatever in relation to this property. Purchase prices, rents or other prices quoted are correct at the date of publication and, unless otherwise stated, exclusive of VAT. Data Protection: We retain the copyright in all advertising material used to market this Property.

Energy Efficiency Rating		Environmental Impact (CO <sub>2</sub> ) Rating	
Current	Potential	Current	Potential
Very energy efficient - lower running costs		Very environmentally friendly - lower CO <sub>2</sub> emissions	
(92 plus) <b>A</b>		(92 plus) <b>A</b>	
(81-91) <b>B</b>		(81-91) <b>B</b>	
(69-80) <b>C</b>		(69-80) <b>C</b>	
(55-68) <b>D</b>		(55-68) <b>D</b>	
(39-54) <b>E</b>		(39-54) <b>E</b>	
(21-38) <b>F</b>		(21-38) <b>F</b>	
(1-20) <b>G</b>		(1-20) <b>G</b>	
Not energy efficient - higher running costs		Not environmentally friendly - higher CO <sub>2</sub> emissions	
England & Wales	EU Directive 2002/91/EC	England & Wales	EU Directive 2002/91/EC

JeffreyRoss

find us on



# North Road

0 Bedrooms - Cardiff - CF14 3BN - £600 PCM





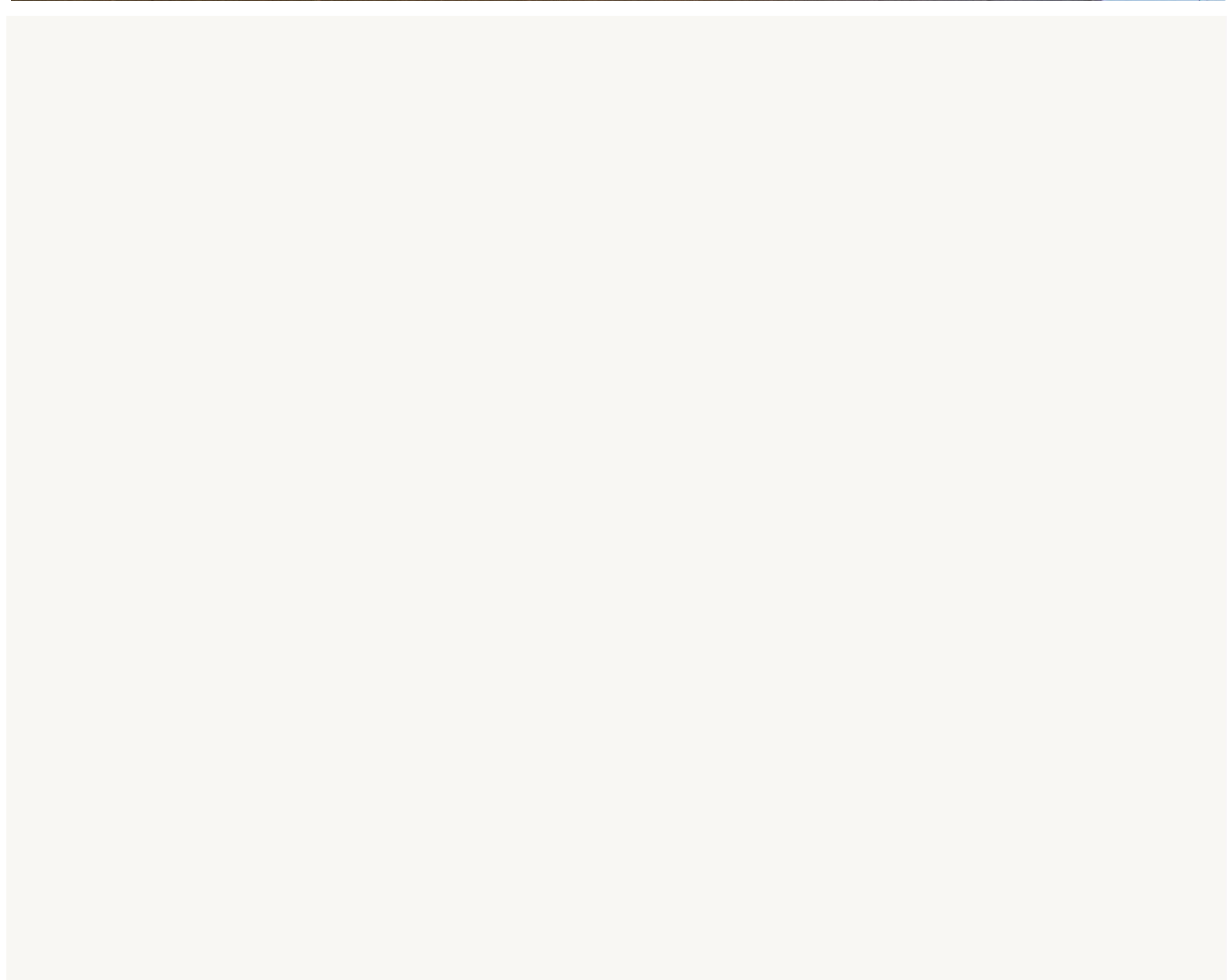



روتی  
**ROTI**  
INDIAN STREET FOOD

aboraj  
**EXPRESS**

[www.thesecuritystore.uk.com](http://www.thesecuritystore.uk.com)

DragonCycles Ltd  
**Electric Bike Centre**  
[www.dragoncycles.wales](http://www.dragoncycles.wales)

**SOUTH WALES SAFETY CONSULTANCY**  
Health • Safety • Fire • Environmental  
Tel: 029 2062 8763  
Email: [mail@swsconsultancy.com](mailto:mail@swsconsultancy.com)  
[www.swstraining.co.uk](http://www.swstraining.co.uk)  
[www.swsconsultancy.com](http://www.swsconsultancy.com)

DragonCycles Ltd  
**Electric Bikes**  
South Wales/West Country  
[www.dragoncycles.wales](http://www.dragoncycles.wales)

DragonCycles Ltd  
Electric Bikes  
South Wales/West Country  
[www.dragoncycles.wales](http://www.dragoncycles.wales)

Electric Bikes  
South Wales/West Country  
[www.dragoncycles.wales](http://www.dragoncycles.wales)

Electric Bikes  
South Wales/West Country  
[www.dragoncycles.wales](http://www.dragoncycles.wales)

284 North Road, Cardiff  
CF14 3BN

CE13 EYE

**J WHITFIELD BUILDING SERVICES**  
New Builds • Extensions • Garden Walls  
• Patios • Drives • Fully Insured  
M: 07512 212 921

Specialist Bricklayer  
[JWHITFIELDBUILDINGSERVICES@GMAIL.COM](mailto:JWHITFIELDBUILDINGSERVICES@GMAIL.COM)

AD58 ZRJ

OE11 AAA



Available to rent here is a retail space in a popular part of Heath and along the convenient row of commercial space on North Road, just off the Gabalfa roundabout and there a busy through fare for traffic. Offering 412 square feet of space, the ground floor accommodation further benefits rear parking.

A 360 degree virtual tour is available for this property, check the JeffreyRoss website for further information or contact Jon in the Pontcanna office on 02920397887,

- 412 square foot
- Ground floor
- Parking

**sq ft**