



- Sought After Location
- No Chain
- Garage
- Driveway

Stonecroft Way, Croydon

No Onward Chain - An attractive three bedroom end of terrace house with original features, 3 good sized bedrooms, 2 reception rooms, large garden and potential to extend stpp. Other benefits include a first floor family bathroom, and a fitted kitchen .Garden with side access: Garage: Own
Driveway:

Asking Price Of £425,000

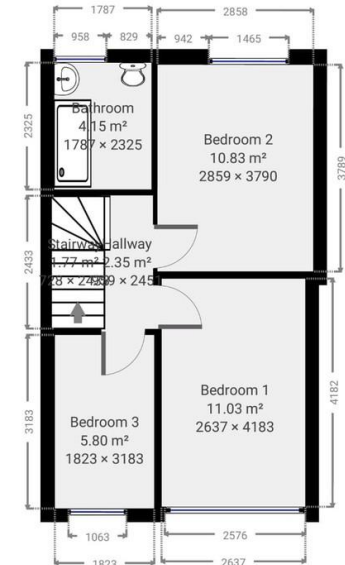
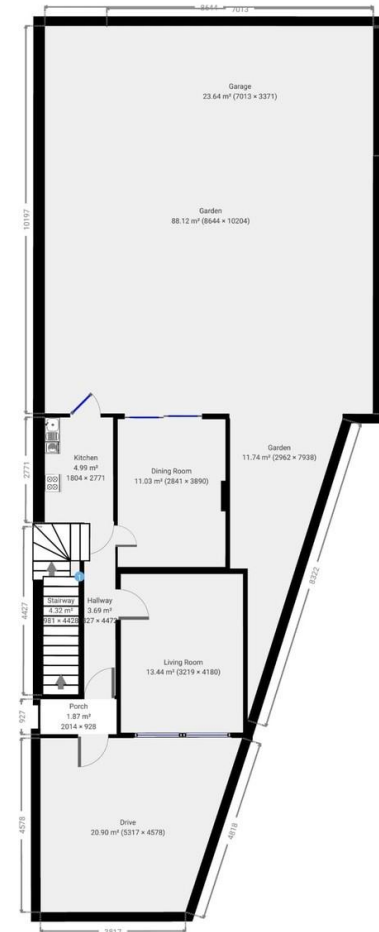

182 London Road, Croydon, Surrey,
 CR0 2TE

www.jameschiltern.com
 0208 681 8133
sales@jameschiltern.com

Agents Note: Whilst every care has been taken to prepare these sales particulars, they are for guidance purposes only. All measurements are approximate and for general guidance purposes only and whilst every care has been taken to ensure their accuracy, they should not be relied upon and potential buyers are advised to recheck the measurements