



14 Grange Road, Rodney Lodge, Clifton, Bristol, BS8 4EA

This is a lovely and well appointed first floor apartment in the sought after purpose built development on Grange Road. The furnished accommodation consists of two double bedrooms, an en suite shower room, main full bathroom, open plan fitted kitchen and living room with a south facing balcony off it. The property also has the benefit of an off street parking space. EPC rating C (79).

**£1,300 Per Calendar Month\* Fees Apply**

## Ground Floor

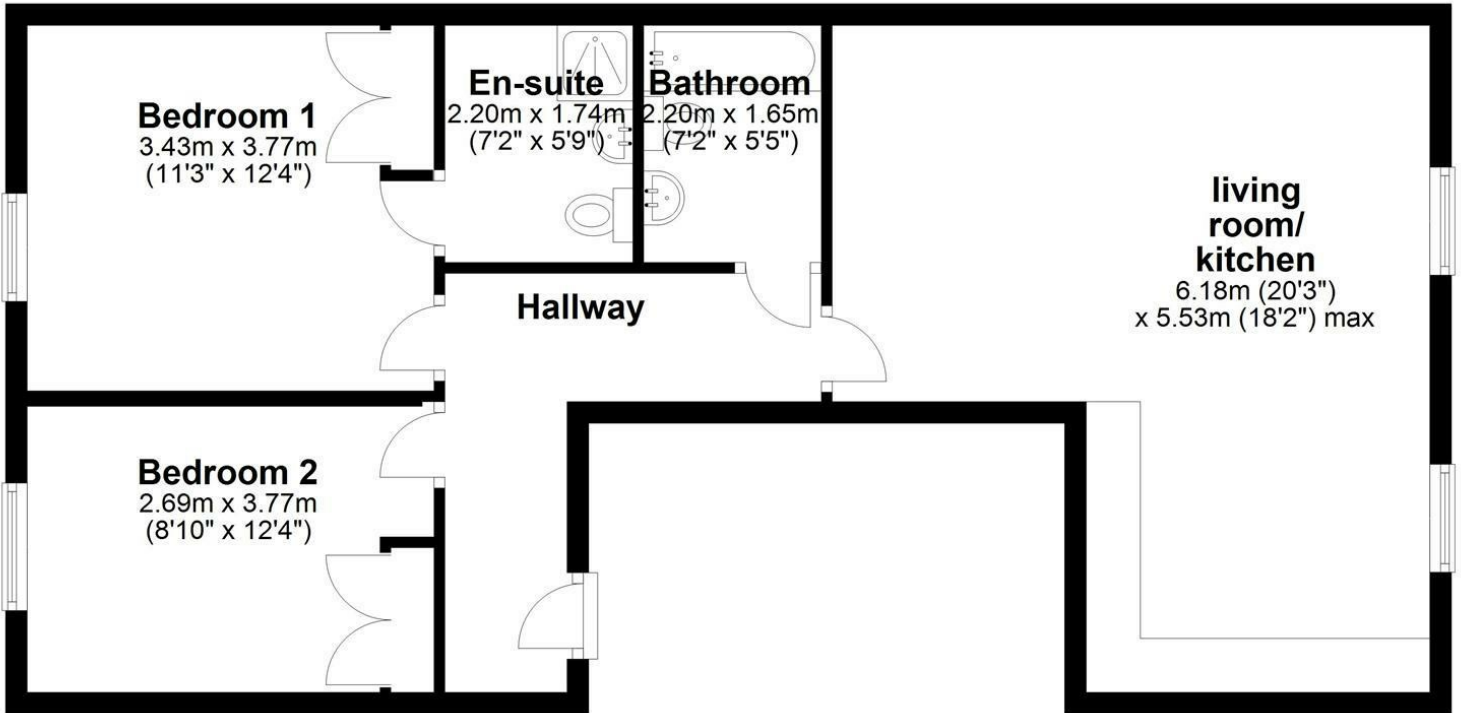

Whilst Hydes of Bristol endeavours to ensure floorplans be as accurate as possible, the measurements of any items within the property (such as windows, doors and walls) are approximate and no responsibility can be taken for any error.  
Plan produced using PlanUp.

Energy Efficiency Rating		Current	Potential
Very energy efficient - lower running costs			
(92 plus) <b>A</b>			
(81-91) <b>B</b>			
(69-80) <b>C</b>			
(55-68) <b>D</b>			
(39-54) <b>E</b>			
(21-38) <b>F</b>			
(1-20) <b>G</b>			
Not energy efficient - higher running costs			
<b>England &amp; Wales</b>		78	80
EU Directive 2002/91/EC			

Environmental Impact (CO <sub>2</sub> ) Rating		Current	Potential
Very environmentally friendly - lower CO <sub>2</sub> emissions			
(92 plus) <b>A</b>			
(81-91) <b>B</b>			
(69-80) <b>C</b>			
(55-68) <b>D</b>			
(39-54) <b>E</b>			
(21-38) <b>F</b>			
(1-20) <b>G</b>			
Not environmentally friendly - higher CO <sub>2</sub> emissions			
<b>England &amp; Wales</b>			
EU Directive 2002/91/EC			