



*Jordanfishwick*

BUXTON OLD ROAD  
Disley, Stockport





**73 Buxton Old Road, Disley,  
Stockport, Cheshire SK12 2DQ**  
**£209,950**



### **The Property**

\*\*\*WATCH THE VIDEO TOUR\*\*\* A most charming stone built end of terrace property occupying an ideal position close to Disley Village centre and railway station. Full of character and boasting extended ground floor accommodation together with delightful enclosed gardens. Double glazing, gas central heating and comprising: living room, separate dining room, kitchen, two first floor bedrooms and a bathroom. Wealth of features including exposed stone and beams. Viewing recommended. Energy rating TBC

### **Locality**

Disley is situated on the east of Cheshire and is the gateway to the Peak District. It lays claim to the famous National Trust owned Lyme Park which offers the largest house in Cheshire and was used for filming part of Pride and Prejudice. Disley maintains the charming village feel with many amenities including the local infant school, independent shops, public houses and restaurants. Ideally placed on the Manchester Piccadilly to Buxton railway line and the recently completed of the new relief road to Manchester airport, make the village ideal for the commuter of today. With the High Peak on our doorstep, those wanting the escape to outdoors wont have to travel too far!



- Full Of Character
- Charming Stone Built End Of Terrace
- Two Bedrooms
- Beautiful Private Gardens With Large Shed and Frontage
- Extended Ground Floor Accommodation
- Pvc Double Glazing and Gas Central Heating

Postcode - SK12 2DQ

EPC Rating -

Local Authority - Cheshire East

Council Tax - Band C



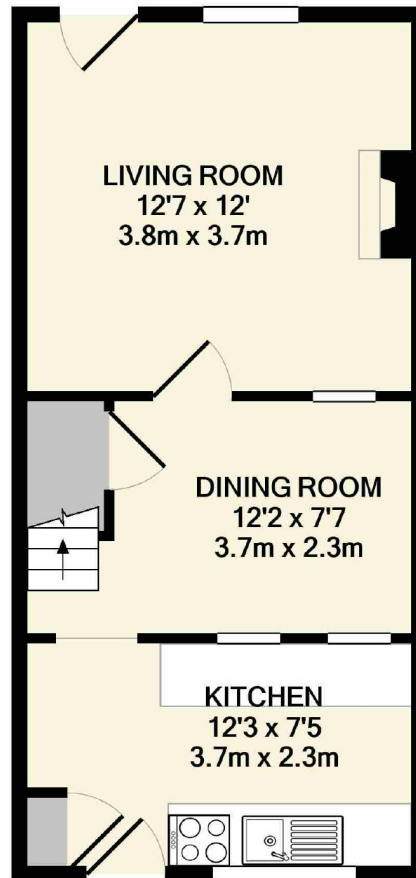

GROUND FLOOR

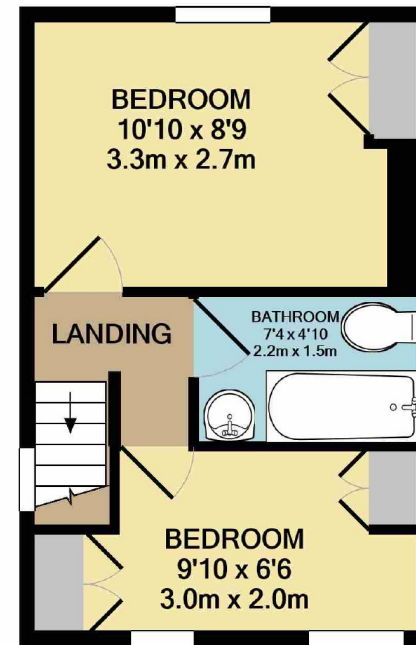

1ST FLOOR

Whilst every attempt has been made to ensure the accuracy of the floor plan contained here, measurements of doors, windows, rooms and any other items are approximate and no responsibility is taken for any error, omission, or mis-statement. This plan is for illustrative purposes only and should be used as such by any prospective purchaser. The services, systems and appliances shown have not been tested and no guarantee as to their operability or efficiency can be given  
 Made with Metropix ©2020



These particulars are believed to be accurate but they are not guaranteed and do not form a contract. Neither Jordan Fishwick nor the vendor or lessor accept any responsibility in respect of these particulars, which are not intended to be statements or representations of fact and any intending purchaser or lessee must satisfy himself by inspection or otherwise as to the correctness of each of the statements contained in these particulars. Any floorplans on this brochure are for illustrative purposes only and are not necessarily to scale.

Offices also at: Wilmslow, Macclesfield, Hale, Sale, Chorlton, Glossop, Manchester & Salford

14 Market Street, Disley, Cheshire, SK12 2AA

01663 76 78 78

disley@jordanfishwick.co.uk