



Estate Agents • Lettings • Land & New Homes



14 Chilworth Gate, Silverfield, Broxbourne, EN10 6NN

£195,000

Lanes are pleased to present this ground floor one bedroom purpose built flat. Located within easy reach to Broxbourne Station this property benefits from communal parking, entry phone system, electric heating and double glazing. This property has the added incentive of being sold with no onward chain. Call now to avoid disappointment.



Hallway

Airing cupboard, storage heater, storage cupboard doors leading to lounge and bedroom.

Lounge/Diner

18'6 x 9'6 (5.64m x 2.90m)

Double glazed window to front aspect, dado rail, electric heater, coving and access to kitchen.

Kitchen

8'1 x 7'0 (2.46m x 2.13m)

Double glazed window to side aspect, part tiled walls, eye and base level units with worktop surfaces, fitted hob, oven and extractor, stainless steel sink with mixer tap, space for fridge/freezer and washing machine.

Bedroom

12'6 x 8'6 (3.81m x 2.59m)

(into fitted wardrobe) Double glazed window to side aspect, fitted wardrobe and electric heater.

Bathroom

Panel enclosed bath with shower over, vanity wash hand basin with mixer tap, low flush W.C, tiled floor and tiled walls.

Reference

CH6080/AX/AX/AX/23102020

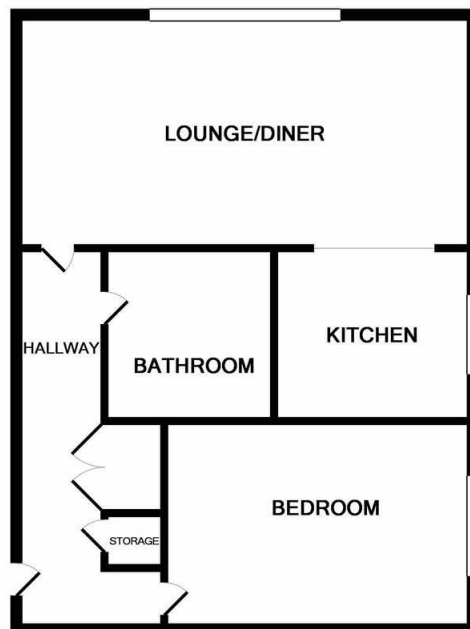
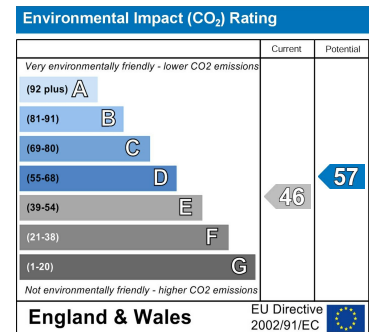
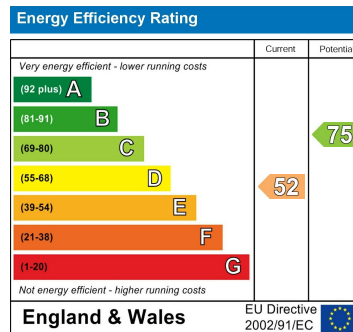

Whilst every attempt has been made to ensure the accuracy of the floor plan contained here, measurements of doors, windows, rooms and any other items are approximate and no responsibility is taken for any error, omission, or mis-statement. This plan is for illustrative purposes only and should be used as such by any prospective purchaser. The services, systems and appliances shown have not been tested and no guarantee as to their operability or efficiency can be given
Made with Metropix ©2018

IMPORTANT NOTICE TO PROSPECTIVE PURCHASERS

We are not qualified to test any apparatus, equipment, fixtures and fittings or services so cannot that they are in working order or fit for their intended purpose. We do not have access to property deeds or lease documents so prospective purchasers should rely only on information given by their solicitors on relevant matters. Measurements are approximate and are only intended to provide a guide.

