



Victoria Road, Slough, SL2 5ND

Guide Price £300,000 Freehold

Two bedroom mid terraced house, conveniently located within walking distance of local shops and amenities. The property has been modernised by the current owners and benefits from uPVC double glazing, downstairs bathroom, well presented modern kitchen and large garden. Viewing highly recommended.



Victoria Road, Slough, Berkshire, SL2 5ND

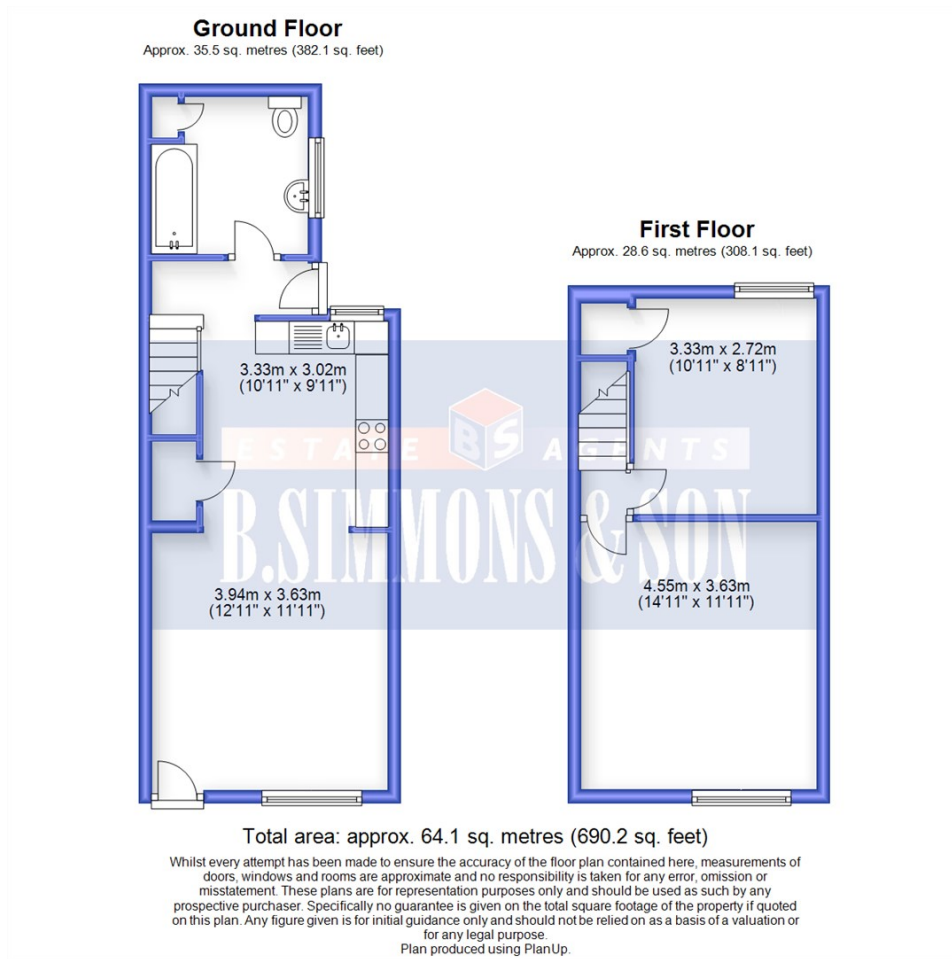

- 2 Double Bedroom House
- Large Garden
- Modernised by the current owners
- Walking distance of local shops
- Mid Terrace
- Beautifully Presented
- Freehold
- EPC: D



Energy Efficiency Rating	
Current	Potential
Very energy efficient - lower running costs	
(92 plus) A	
(81-91) B	
(69-80) C	
(55-68) D	
(39-54) E	
(21-38) F	
(1-20) G	
Not energy efficient - higher running costs	
England & Wales	
EU Directive 2002/91/EC	

Environmental Impact (CO ₂) Rating	
Current	Potential
Very environmentally friendly - lower CO ₂ emissions	
(92 plus) A	
(81-91) B	
(69-80) C	
(55-68) D	
(39-54) E	
(21-38) F	
(1-20) G	
Not environmentally friendly - higher CO ₂ emissions	
England & Wales	
EU Directive 2002/91/EC	

These particulars are intended as a general guide only and do not constitute any part of an offer or contract. All descriptions, dimensions, references to condition and necessary permissions for use and occupation, and other details are given without responsibility. Intending purchasers or tenants should satisfy themselves as to the accuracy of all statements and representations before entering into any agreement. We have not carried out a survey or checked the services, appliances or fixtures and fittings. Room dimensions should not be relied upon for carpets or furnishings. No employee or partner of B Simmons & Son has authority to make or give any representation or warranty in relation to the property. All negotiations for this purchase must be made through B Simmons & Son.