



20 Gillingham Street, London
SW1V

GARTONJONES.COM



20 Gillingham Street, London
, SW1V

GARTON JONES.COM

49 Marsham Street Lettings:
London +44 (0) 20 7340 0480
SW1P 3DP westminster@gartonjones.com
www.gartonjones.com

£450 Per Week

A 2 double bedroom apartment to let of approx. 697sq.ft (65sq.m) on the 1st floor (with lift) of this small residential development in Pimlico, moments from the excellent transport services of Victoria Station which include rail, tube, bus and taxi services, as well as the Gatwick Express. This furnished property further benefits from of an open plan reception room, a kitchen with Siemens integrated appliances, there is a utility cupboard housing a washer dryer, wood flooring, 2 bathrooms (1 en-suite), good storage, comfort cooling and a day porter. 20 Gillingham Street is located at the junction with Wilton Road and is also moments from Victoria Street. You will have access to an abundance of shops and brand new restaurants which are all on the door step. The transport links of St James's Park and Westminster are also within easy reach.

- 697sq.ft (65sq.m)
- 1st Floor (with Lift)
- 2 Double Bedrooms
- Open Plan Reception Room
- Kitchen with Siemens Integrated Appliances
- 2 Bathrooms (1 En-suite)
- Day Porter
- Wood Flooring & Comfort Cooling
- Close to Local Amenities Including Shops, Restaurants & Transport Links
- Walking Distance to Pimlico and Victoria Station



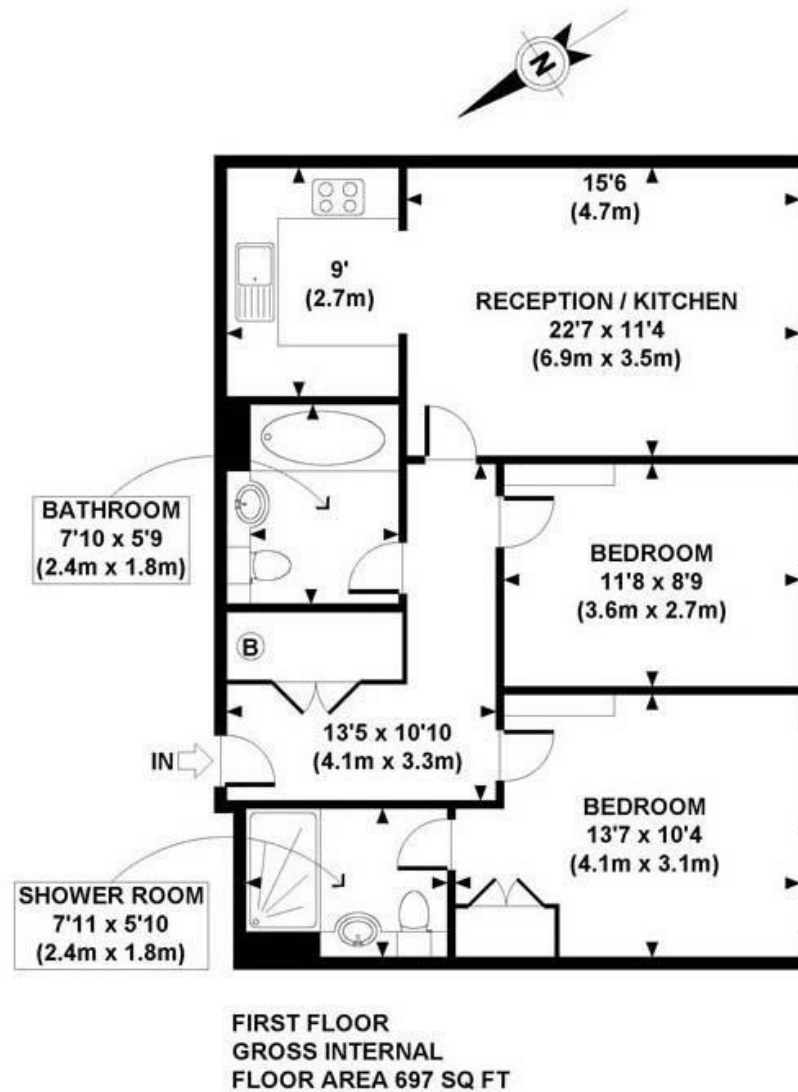

APPROX. GROSS INTERNAL FLOOR AREA 697 SQ FT / 65 SQ M

