



To arrange a viewing
please call 01908 675747

****VIDEO TOUR WITHIN LISTING** OFFERED CHAIN FREE** is this WELL PRESENTED duplex with replacement UPVC DOUBLE GLZING throughout, PRIVATE REAR GARDEN, new bathroom and all within SHORT DISTANCE of FURZTON LAKE.

In further detail this well presented and generously sized property consists of an entrance hall, spacious living room with box window to the front aspect filing the room with natural light, kitchen breakfast room with white goods and a window to the rear aspect. Upstairs offers a large master bedroom, bedroom two and a new bathroom with a three piece suit. Outside is a nice and private rear garden with allocated parking spaces.

- Chain Free
- Short Walk To Furzton lake
- New Fitted Bathroom
- Replacement UPVC Double Glazing
- Well Presented Throughout
- Rear Garden

LOCATION:FURZTON

Furzton is a residential area boasting Furzton Lake, which has walk & cycle-ways around it. The area is situated in south-west Milton Keynes and has a linear park running through it, playing fields, children's parks, allotments and a local shopping centre. The area is also well served by local buses.

THE PROPERTY

ENTRANCE HALL

KITCHEN/BREAKFAST ROOM

LIVING ROOM

12'11" x 9'10"

STORAGE CUPBOARD

FIRST FLOOR

MASTER BEDROOM

12'11" x 9'10"

BEDROOM TWO

9'10" x 6'11"

BATHROOM

OUTSIDE

REAR GARDEN

TENURE

Leasehold
999 Years left on lease
No Service Charge
No Ground Rent

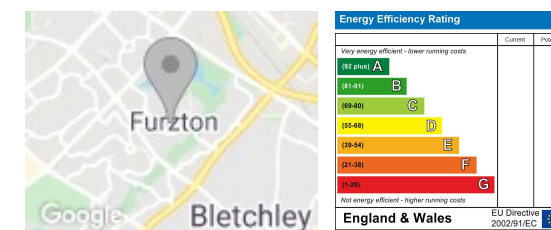
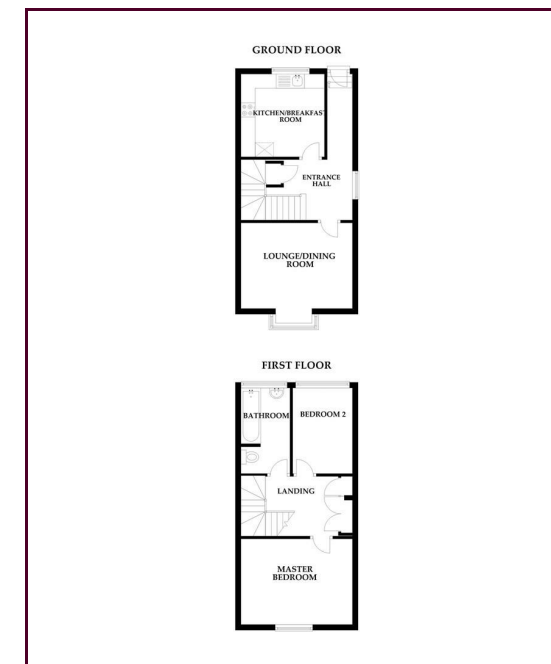

Draft Details

These details have been submitted to our clients but at the moment have not been approved by them. We therefore, cannot guarantee their accuracy and they are distributed on this basis. Please ensure you have a copy of our approved details before committing yourself to any expense.

Whilst we endeavour to make our sales details accurate and reliable, if there is any point which is of particular importance to you, please contact the office and we shall be pleased to check any information for you. Do so, especially if travelling any distance to view the property.

The mention of any appliances and/or services within these details does not imply they are in full and efficient working order.

Any plans included within these details are a GUIDE TO THE LAYOUT OF THE PROPERTY ONLY and are NOT DRAWN TO SCALE. Dimensions are approximate.

Mortgage Information

We can offer independent mortgage advice. Please call us to discuss your requirements. Your home may be repossessed if you do not keep up repayment on your mortgage or any loans secured on it.

Property Valuations

We have some of the most experienced property valuers in Milton Keynes and would welcome the opportunity to carry out a VALUATION and MARKET APPRAISAL of your home.

Viewing Arrangements

Please call us to make an appointment to view this property.

Monday to Friday 9.00 am - 6.00 pm
Saturday 9.00 am - 4.00 pm
Sunday CLOSED

