

# Linden Avenue

Cheltenham GL52 3DR



## Linden Avenue, Prestbury, Cheltenham GL52 3DR

This is a stunning, renovated, three bedroom semi-detached house in Linden Avenue, Prestbury. The current owner has extended the rear kitchen into a wonderful open plan kitchen/diner with integrated appliances, an island and bi-folding doors to the rear garden. The separate lounge is at the front and lastly downstairs is a handy cloakroom off the entrance hall. Upstairs we have two double bedrooms with built in wardrobes, a smart re-fitted family bathroom and lastly a single bedroom. The landscaped rear garden is mainly laid lawn but does have a patio area. Outside the front has off road parking for at least three cars. A stunning home to go and see for yourselves.







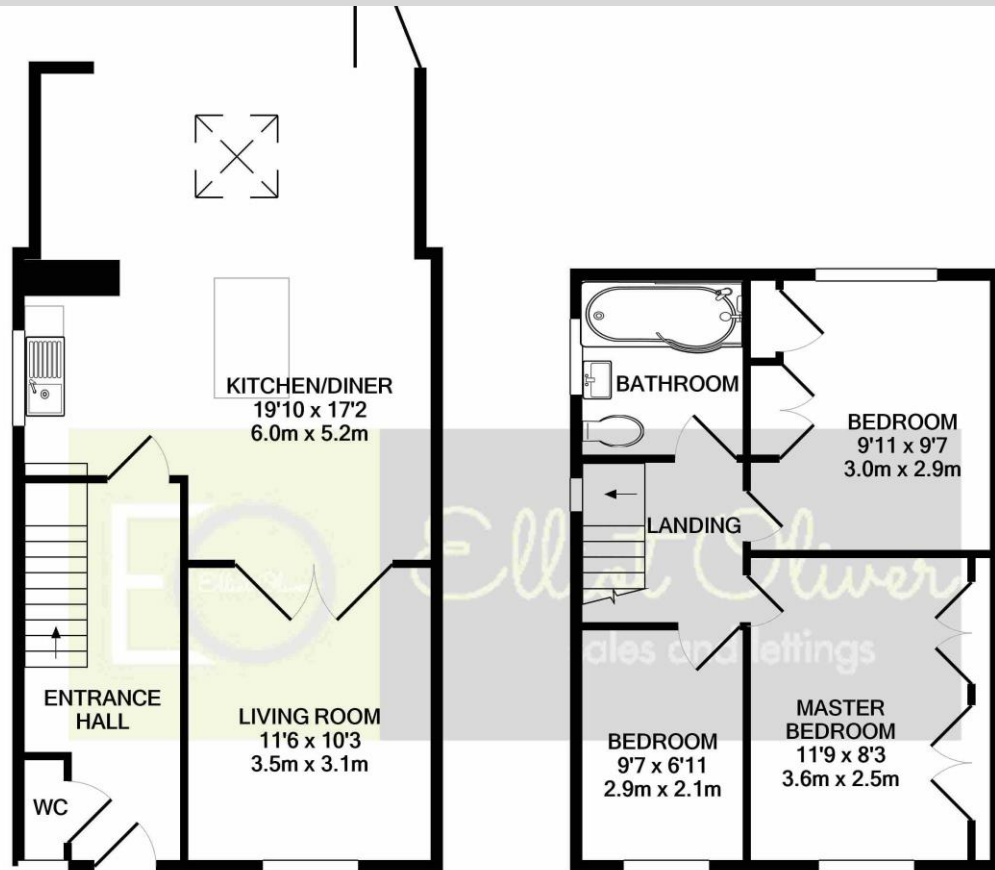

GROUND FLOOR  
APPROX. FLOOR  
AREA 518 SQ.FT.  
(48.1 SQ.M.)

1ST FLOOR  
APPROX. FLOOR  
AREA 397 SQ.FT.  
(36.9 SQ.M.)

TOTAL APPROX. FLOOR AREA 915 SQ.FT. (85.0 SQ.M.)

Whilst every attempt has been made to ensure the accuracy of the floor plan contained here, measurements of doors, windows, rooms and any other items are approximate and no responsibility is taken for any error, omission, or mis-statement. This plan is for illustrative purposes only and should be used as such by any prospective purchaser. The services, systems and appliances shown have not been tested and no guarantee as to their operability or efficiency can be given  
Made with Metropix ©2020



**OFFICE**

101 Promenade,  
Cheltenham,  
Gloucestershire, GL50  
1NW  
info@elliottoliver.co.uk