



9 Cypress Grove, Andover, SP10 3DF
Guide price £289,950



9 Cypress Grove, , Andover,
Guide price £289,950

PROPERTY DESCRIPTION BY Miss Jay Cowan

Graham & Co are delighted to present this three bedroom link detached house that has been well maintained by the current owner. Internally the property benefits from an entrance hall, kitchen, large living room and a family bathroom. Externally there is a garage with access to a private garden.





Andover offers a good range of shopping and recreational facilities including a theatre, cinema, new leisure centre, excellent selection of schools and a college for higher education. An abundance of open space and land with a selection of local nature reserve's all within walking distance of the town centre. The town itself boast a lovely "market town" feel and everything you may need is close at hand. The mainline train station offers a fast service to London Waterloo in just over an hour, and the A303 gives access to London via the M3 and the West Country.



Cypress Grove , SP10

Approximate Gross Internal Area = 71.6 sq m / 771 sq ft
 Garage = 12.5 sq m / 134 sq ft
 Total = 84.1 sq m / 905 sq ft

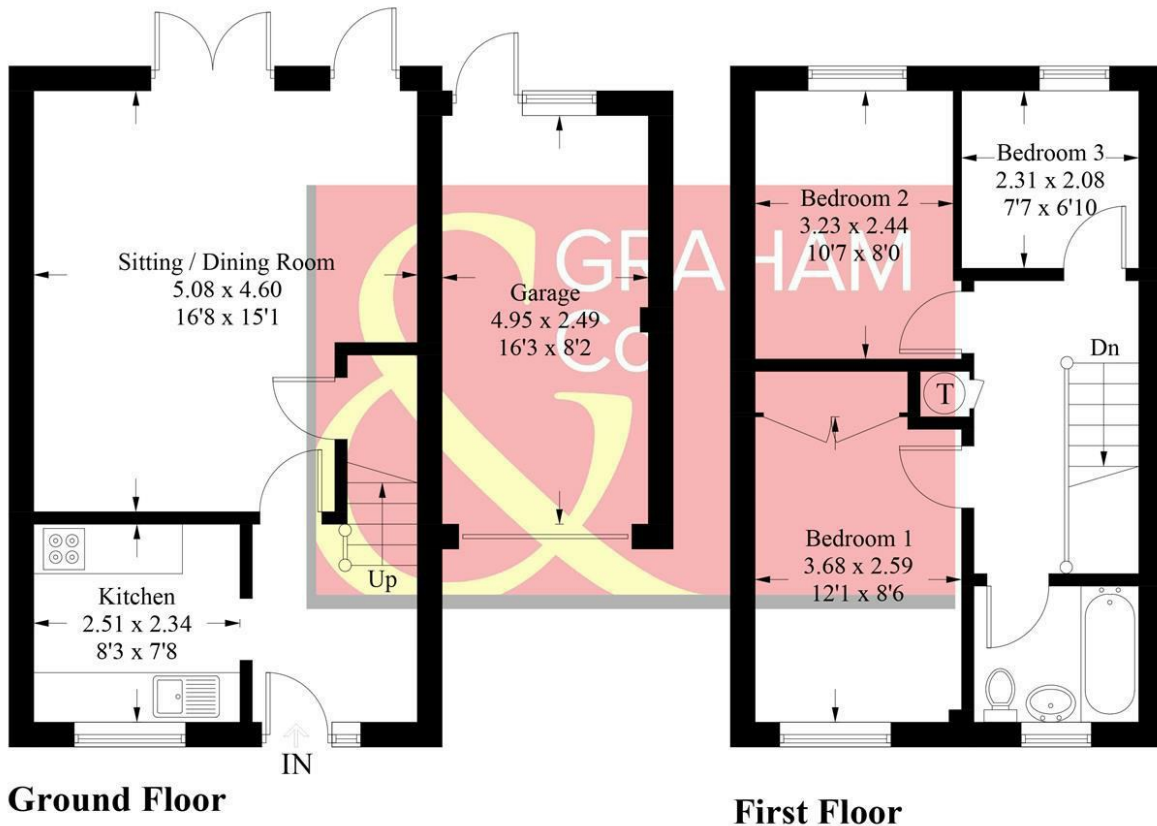

PRODUCED FOR GRAHAM AND CO

Whilst every attempt has been made to ensure the accuracy of the floorplan, measurements of doors, windows and rooms are approximate. These plans are for representation purposes only as defined by RICS Code of Measuring Practice and used as such by any prospective purchaser. © Emzo Marketing (ID702126)

DIRECTIONS

Proceed from the town along Bridge Street and at the mini roundabout veer right onto the Weyhill Road. Proceed over the next three roundabouts and opposite Aldi turn left into Monxton Road, left again into Gallaghers Mead then right into Shaw Close which leads into Cypress Grove.

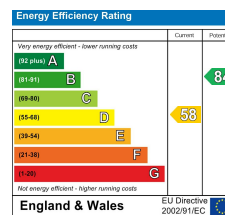

Tax Band: D



OPEN 7 DAYS

If you are considering selling your home please contact us today for your free no obligation valuation

01264 356500

IMPORTANT: we would like to inform prospective purchasers that these sales particulars have been prepared as a general guide only. A detailed survey has not been carried out, nor the services, appliances and fittings tested. Room sizes should not be relied upon for furnishing purposes and are approximate. If floor plans are included, they are for guidance only and illustration purposes only and may not be to scale. If there are any important matters likely to affect your decision to buy, please contact us before viewing the property.