



## 24 Victoria Orchard Maidstone, Kent, ME16 0ED

Greenleaf are delighted to offer TO LET this 2 bedroom duplex apartment, only a short distance from Maidstone hospital. Accommodation comprises entrance door with stairs up to first floor with two double bedrooms, en-suite shower and bathroom. Further staircase up to second floor with large open plan Kitchen with appliances provided and Living room. Benefits from off road parking for one car and gas central heating.

Sorry, pets are not permitted at this property

In order to reserve a property you will be required to pay a holding fee of the equivalent to one weeks rent, whilst we carry out reference checks this will then come off of monies due to move in which are a five week deposit and one month's advance rent. If you require any further information just give the team a call or email on [info@greenleaf-property.co.uk](mailto:info@greenleaf-property.co.uk)

Greenleaf are a member of the PRS (property redress scheme) membership number: PRS003992  
Greenleaf Property Services Ltd have client money protection – property mark - membership – C0128543

**£925 PCM**

## 24 Victoria Orchard

Maidstone, Kent, ME16 0ED



- Duplex Apartment
- En-Suite Shower Room
- Gas Central Heating
- Large Open Plan Kitchen/Living Room
- Close to Maidstone Hospital
- Two Bedrooms
- Off Road Parking



[Directions](#)

Tel: 01634730672



# Greenleaf

Sales • Lettings • Mortgages

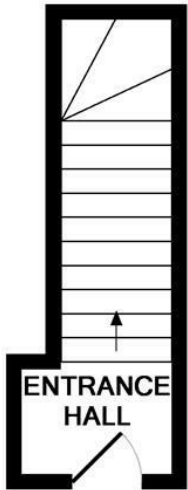

ENTRANCE FLOOR  
APPROX. FLOOR  
AREA 64 SQ.FT.  
(6.0 SQ.M.)

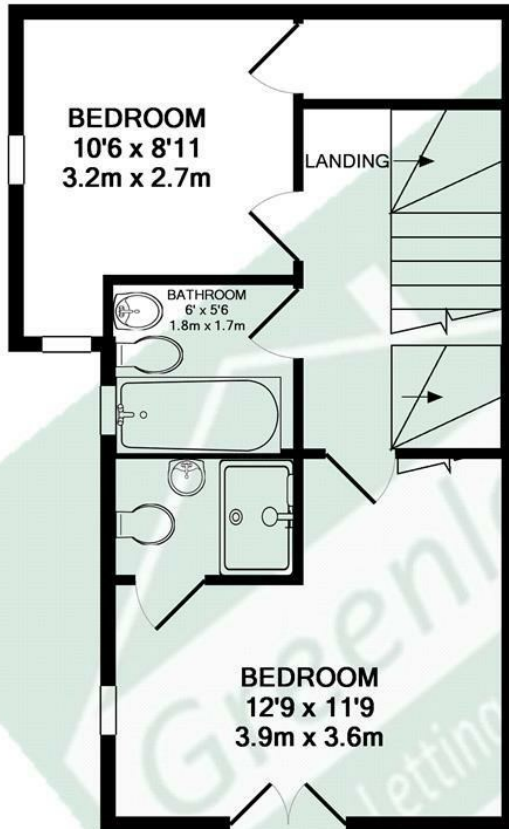

1ST FLOOR  
APPROX. FLOOR  
AREA 359 SQ.FT.  
(33.3 SQ.M.)

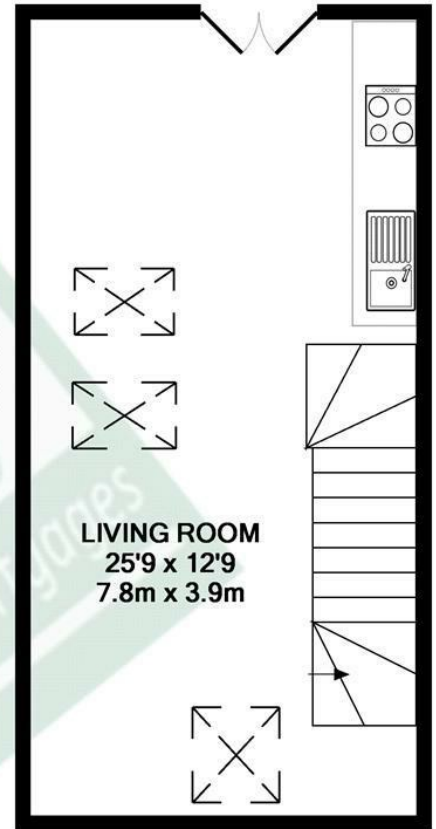

2ND FLOOR  
APPROX. FLOOR  
AREA 327 SQ.FT.  
(30.4 SQ.M.)

TOTAL APPROX. FLOOR AREA 750 SQ.FT. (69.7 SQ.M.)

Whilst every attempt has been made to ensure the accuracy of the floor plan contained here, measurements of doors, windows, rooms and any other items are approximate and no responsibility is taken for any error, omission, or mis-statement. This plan is for illustrative purposes only and should be used as such by any prospective purchaser. The services, systems and appliances shown have not been tested and no guarantee as to their operability or efficiency can be given

Made with Metropix ©2014

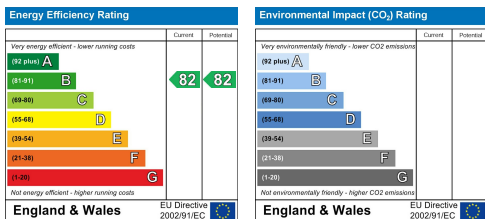

These particulars, whilst believed to be accurate are set out as a general outline only for guidance and do not constitute any part of an offer or contract. Intending purchasers should not rely on them as statements of representation of fact, but must satisfy themselves by inspection or otherwise as to their accuracy. No person in this firm's employment has the authority to make or give any representation or warranty in respect of the property.