



Flat 20 Cleveland Flats, Fairview Road, Salisbury, Wilts, SP1 1JY

£735 PCM

A redecorated/refurbished ground floor flat, situated in a popular location within walking distance of the town centre. The property has been redecorated, and has new fitted kitchen and bathroom along with new carpets. The accommodation comprises: Entrance hall, new fitted kitchen with shaker style units, plumbing and space for washing machine, space suitable for upright fridge/freezer, electric hob, extractor, electric oven. Cupboard housing gas fired central heating boiler. Lounge/diner, new bathroom suite with bath, thermostatic shower over the bath, WC and basin. Double glazing, gas fired central heating. UNFURNISHED. Communal parking.

Ground Floor

Approx. 50.3 sq. metres (540.9 sq. feet)

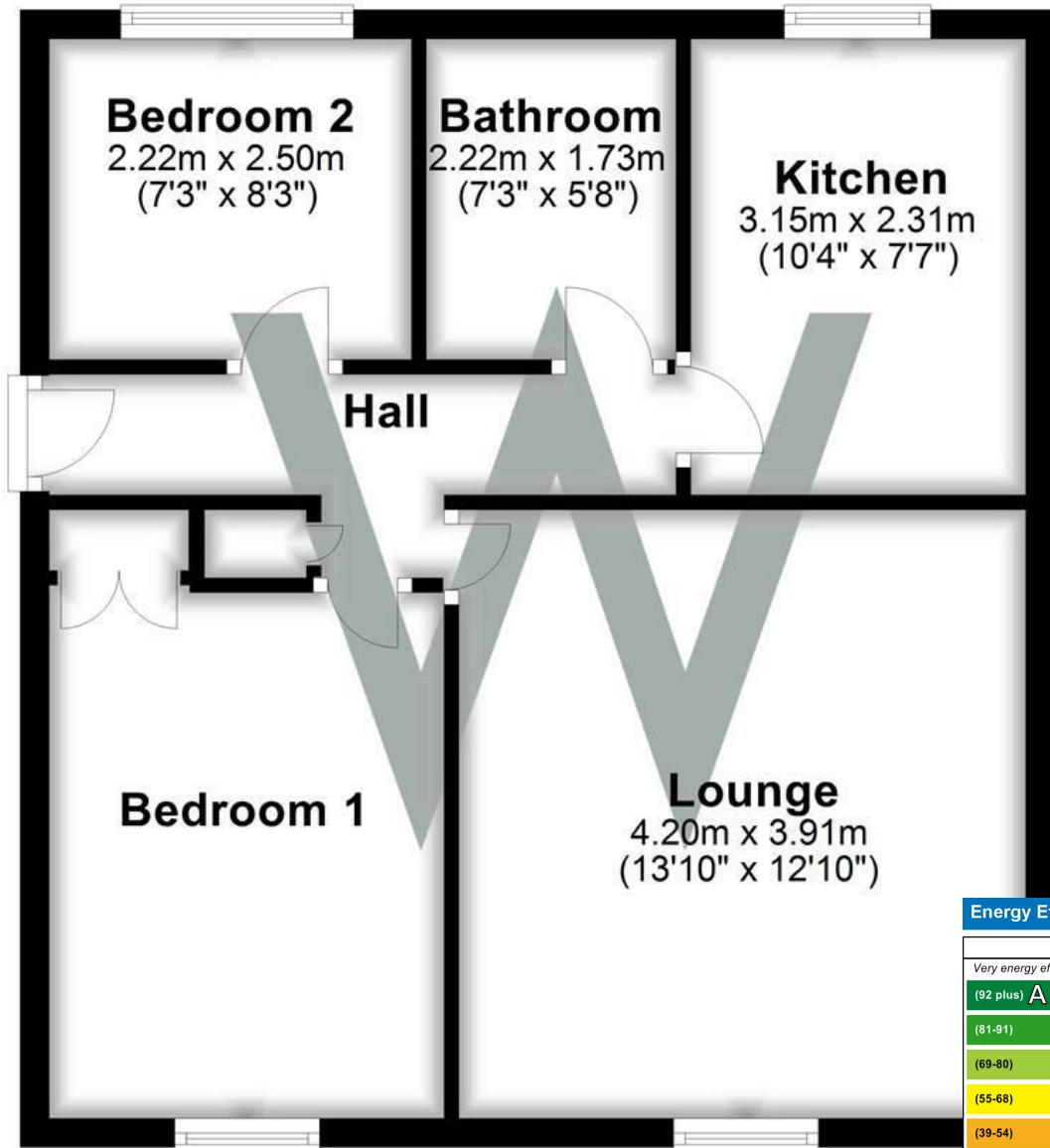

Energy Efficiency Rating		Current	Potential
Very energy efficient - lower running costs			
(92 plus) A			
(81-91) B			
(69-80) C			
(55-68) D			
(39-54) E			
(21-38) F			
(1-20) G			
Not energy efficient - higher running costs			
		73	77
England & Wales		EU Directive 2002/91/EC	

Total area: approx. 50.3 sq. metres (540.9 sq. feet)

WHITES
Castle Chambers, 47 Castle Street,
Salisbury, Wiltshire, SP1 3SP
01722 336422
www.hwwhite.co.uk
residential-sales@hwwhite.co.uk

