



15 PORTMAN SQUARE,  
MARYLEBONE, W1H  
£3,900 Per Month

T. +44 (0) 20 7935 0011  
E. [enquire@napierwatt.co.uk](mailto:enquire@napierwatt.co.uk)  
[WWW.NAPIERWATT.CO.UK](http://WWW.NAPIERWATT.CO.UK)

**NAPIER WATT**  
PROPERTY CONSULTANTS

## Description

A spacious two bedroom apartment recently refurbished to a high standard set at the rear of this sought after block with excellent security and 24 hour portage. The apartment also benefits from private access to Portman Square Garden.

The apartment is located with close proximity to Baker Street, Oxford Street, Selfridges and Bond Street station. (Jubilee & Central Lines) The accommodation comprises a large reception room with able dining space and a modern kitchen and a beautiful bathroom and a separate WC.

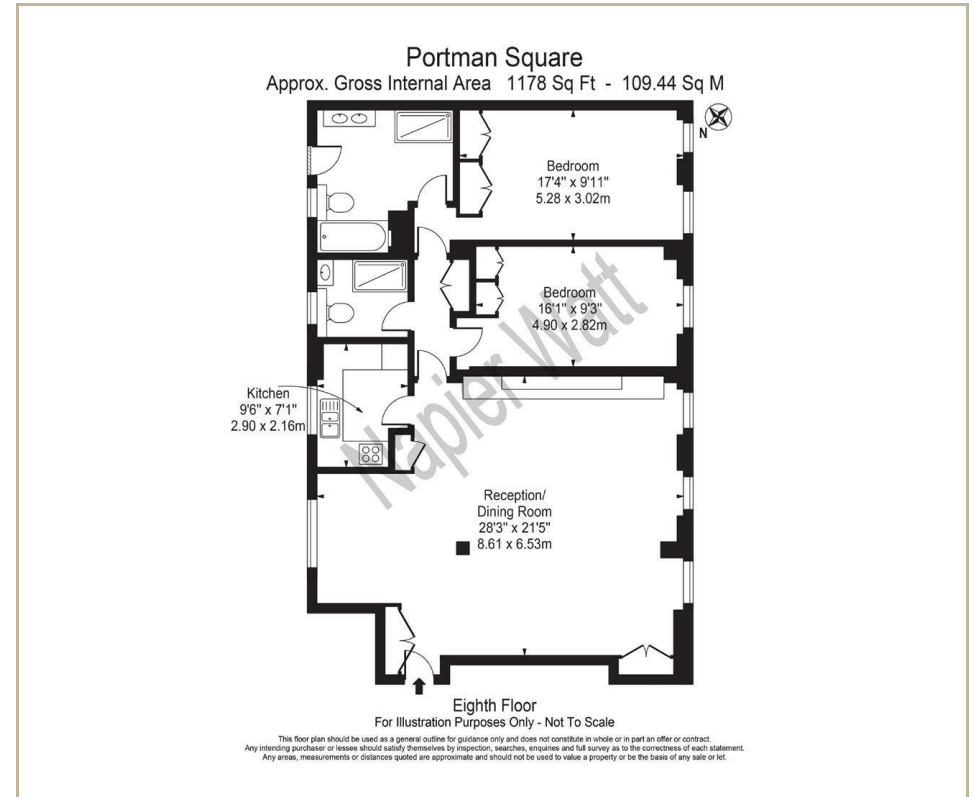

## TERMS

Fees & Charges: Tenancies exceeding £100,000 Per annum £480 inc VAT, Tenancies where a company is a tenant £480 Inc VAT.

**For Clarification** we wish to inform prospective purchasers that we have prepared these sales particulars as a general guide. We have not carried out a survey, nor tested the services, appliances and specific fittings. Room sizes are approximate and rounded: they are taken between internal wall surfaces and therefore include cupboards/shelves, etc. Accordingly, they should not be relied upon for carpets and furnishings. Formal notice is given that all fixtures and fittings, carpeting, curtains/blinds and kitchen equipment, whether fitted or not, are deemed to be removable by the vendor unless specifically itemised within these sales particulars.

T. +44 (0) 20 7935 0011  
E. [enquire@napierwatt.co.uk](mailto:enquire@napierwatt.co.uk)  
WWW.NAPIERWATT.CO.UK

**NAPIER WATT**  
PROPERTY CONSULTANTS