

12 Eleanor Road, Chorlton Green, M21 9FZ



Price: £360,000

****VIDEO TOUR AVAILABLE**** A beautifully presented & spacious, TWO DOUBLE BEDROOMED, garden fronted, period, mid terrace property with a relaxing feel throughout. Positioned on a highly popular tree lined residential road off Kingshill Road in the heart of Chorlton Green. Within walking distance to good local primary schools, close to Beech Road with its cafe society and nearby to the Chorlton meadows and the Ees for walks, runs and cycling along the River Mersey. In brief the well-planned accommodation comprises; entrance hallway, lounge with bay window, inner hallway, dining room with useful under stairs storage and a fitted kitchen/breakfast room to the ground floor with access out into the enclosed lawned courtyard style garden. To the first floor there is a landing leading to two double bedrooms and a fitted three-piece white bathroom suite. The property benefits; a Worcester boiler providing gas fired central heating, period features throughout, partial double glazed, an alarm and a beautiful enclosed rear styled garden. Would suit a professional, couple or a young family due to the location.





Energy Efficiency Rating		Current	Potential
<i>Very energy efficient - lower running costs</i> <div> <div>(92-100) A</div> <div>(81-91) B</div> <div>(69-80) C</div> <div>(55-68) D</div> <div>(39-54) E</div> <div>(21-38) F</div> <div>(1-20) G</div> </div>		<div>64</div>	<div>83</div>
<i>Not energy efficient - higher running costs</i>			
England & Wales		EU Directive 2002/91/EC	



Leasehold With an original lease of 999 years and 912 years remaining. The annual buildings insurance premium is £240. Annual ground rent of £3.25. (Information as per current vendor) October 2020. Council Tax Band: B

Ground Floor

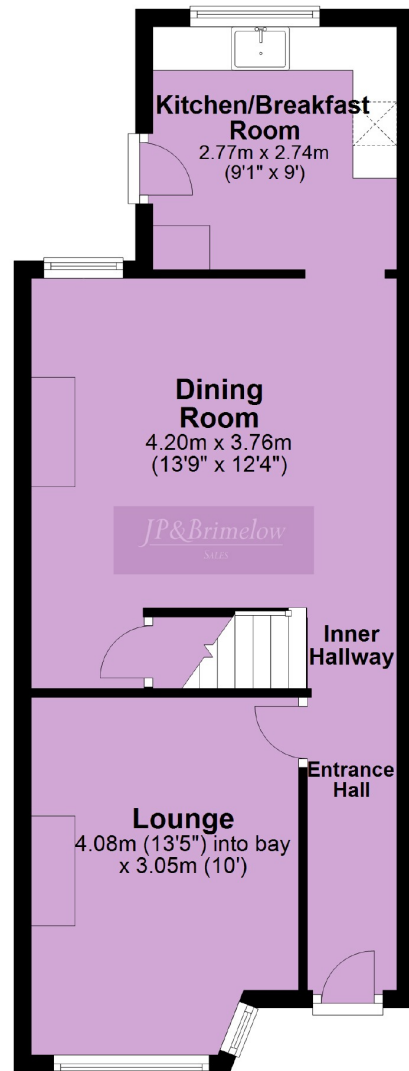

First Floor

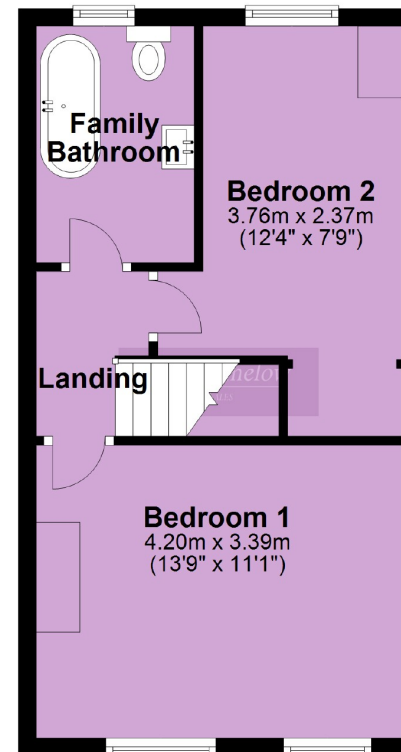

Chorlton & Didsbury Sales

430 Barlow Moor Road, Chorlton, Manchester, M21 8AD

Chorlton: 0161 882 2233 Didsbury: 0161 448 0622

E: chorlton@jpbrimelow.co.uk www.jpandbrimelow.co.uk



JP&Brimelow
SALES

NOTICE: JP & Brimelow Chorlton & Didsbury Ltd for themselves and for the vendors or lessors of this property whose agents they are give notice that:

- (i) the particulars are set out as a general outline only for the guidance of intending purchasers or lessees, and do not constitute, nor constitute part of, an offer or contract;
- (ii) all descriptions, dimensions, references to the condition and necessary permissions for use and occupation, and other details are given in good faith and are believed to be correct but any intending purchasers or tenants should not rely on them as statements or representations of fact but must satisfy themselves by inspection or otherwise as to the correctness of each of them;
- (iii) no person in the employment of JP & Brimelow Ltd has any authority to make or give any representation or warranty whatever in relation to this property.



Follow us on Twitter @jpandbrimelows