







### PROPERTY DESCRIPTION

If you're looking for a property that has good living space, a good size rear garden, and something that you can make your own mark on, then this could be ideal for you.

Tucked away on a corner plot and within walking distance of local amenities, schools and transport links this superb two double bedroom home has plenty to offer anyone either taking their first step onto the property ladder or even

a downsize step.

Internally the rooms are spacious, with a good size lounge and kitchen diner on the ground floor, and two double bedrooms and the bathroom on the first.

The property in our opinion would make a great first time buy or investment property.

Ashford is undergoing an incredible transformation with regeneration happening across the area making it one of Kent's fastest

A good size two double bedroom end of terrace home, within walking distance of local shops, schools and within easy reach of Ashford International rail station and the town centre. Available with no onward chain.

growing towns. Elwick place is already well established with a new cinema, eateries, hotel and the Curious brewery and there is more to come.

**Tenure:** Freehold

**Local Authority:** Ashford Borough Council





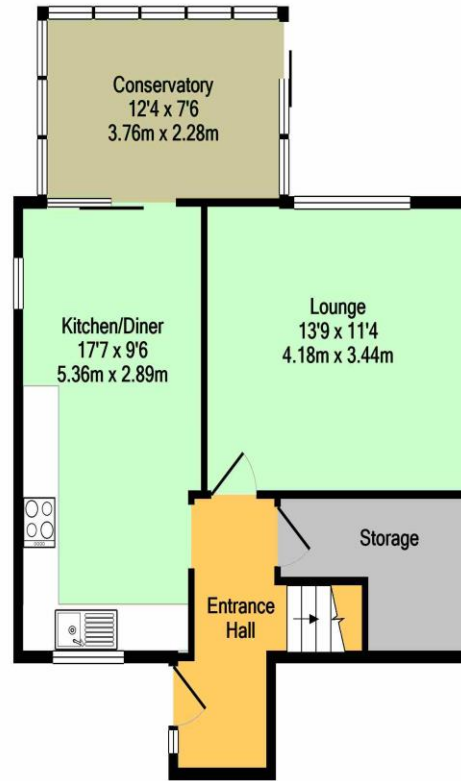

Ground Floor

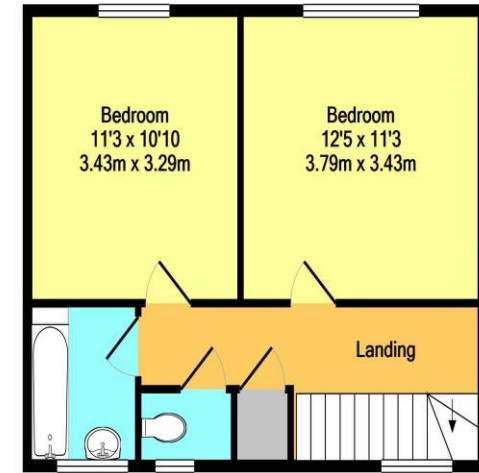

1st Floor



Whilst every attempt has been made to ensure the accuracy of the floor plan contained here, measurements of doors, windows, rooms and any other items are approximate and no responsibility is taken for any error, omission, or mis-statement. This plan is for illustrative purposes only and should be used as such by any prospective purchaser. The services, systems and appliances shown have not been tested and no guarantee as to their operability or efficiency can be given  
Made with Metropix ©2020