



# MILE



**mile...**  
estate agents



**mile...**  
estate agents



**mile...**  
estate agents



**mile...**  
estate agents

## Lothrop Street, Queens Park W10

£2,650 pcm

Mile are extremely happy to offer the market this gorgeous two bedroom house in Queens Park. This truly fantastic two bedroom Victorian end of terrace house situated on this quiet residential road. This lovely home boasts a superb 22ft reception open on to a contemporary fully fitted kitchen and a stunning three piece bathroom. There is access via French doors in the kitchen leading to a paved 14ft garden with rear access; perfect for cyclists. The first floor consists of two double bedrooms and a converted loft space which is used as a further room/study room. The house also benefits from hard wood flooring and an abundance of storage space and natural light. Offered furnished and available February 2025. Lothrop Street is ideally located within a short walk of Salisbury Road and Chamberlayne Road's restaurants, pubs, vintage shops and both Queens Park (Bakerloo Line & Overground), Kensal Rise (Overground) and numerous bus routes. The wide open-space of Queens Park is also within few minutes walk..

- End of terrace house
- Two double bedroom
- Further attic room
- Excellent condition
- Furnished
- Available February 2025
- Private garden
- Open plan living area
- Quiet residential road
- Close to shops and transport

Approximate Gross Internal Area  
939 sq ft - 87 sq m

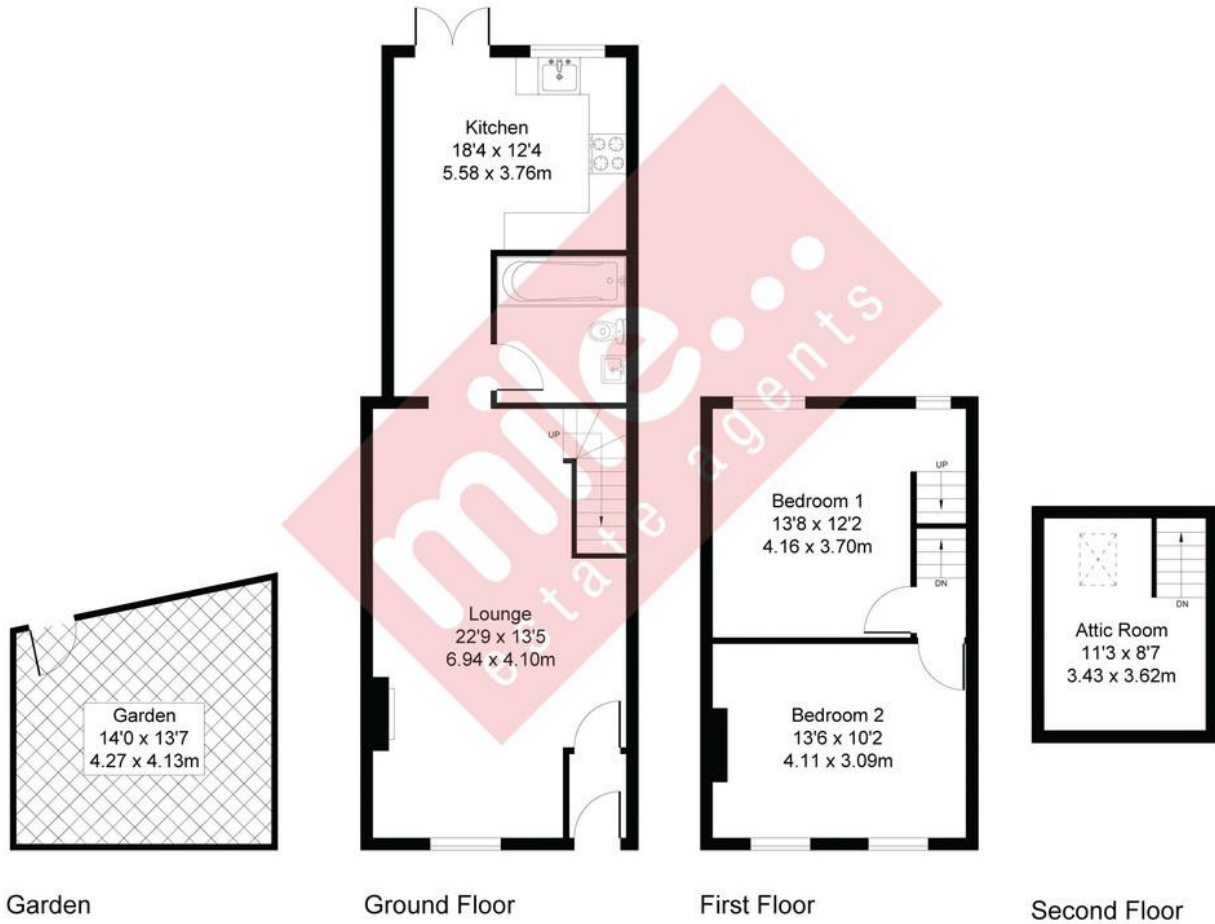

**MONEY LAUNDERING REGULATIONS 2003:** Intending purchasers will be asked to produce identification documentation at a later stage and we would ask for your co-operation in order that there will be no delay in agreeing the sale.

**General:** While we endeavour to make our sales particulars fair, accurate and reliable, they are only a general guide to the property and, accordingly, if there is any point which is of particular importance to you, please contact the office and we will be pleased to check the position for you, especially if you are contemplating travelling some distance to view the property.

**Measurements:** These approximate room sizes are only intended as general guidance. You must verify the dimensions carefully before ordering carpets or any built-in furniture.

**Services:** Please note we have not tested the services or any of the equipment or appliances in this property, accordingly we strongly advise prospective buyers to commission their own survey or service reports before finalising their offer to purchase.