



CUMBERLAND MANSIONS SEYMOUR PLACE,
LONDON, W1H
£4,333 Per Month

T. +44 (0) 20 7935 0011
E. enquire@napierwatt.co.uk
WWW.NAPIERWATT.CO.UK

NAPIER WATT

PROPERTY CONSULTANTS

Description

A compact four bedroom, two bathroom first floor apartment of 1,214 sqft / 112sqm, set within a popular red brick mansion block, with day porter, lift and well maintained communal areas.

The property is in fair decorative condition but ready for immediately occupation.

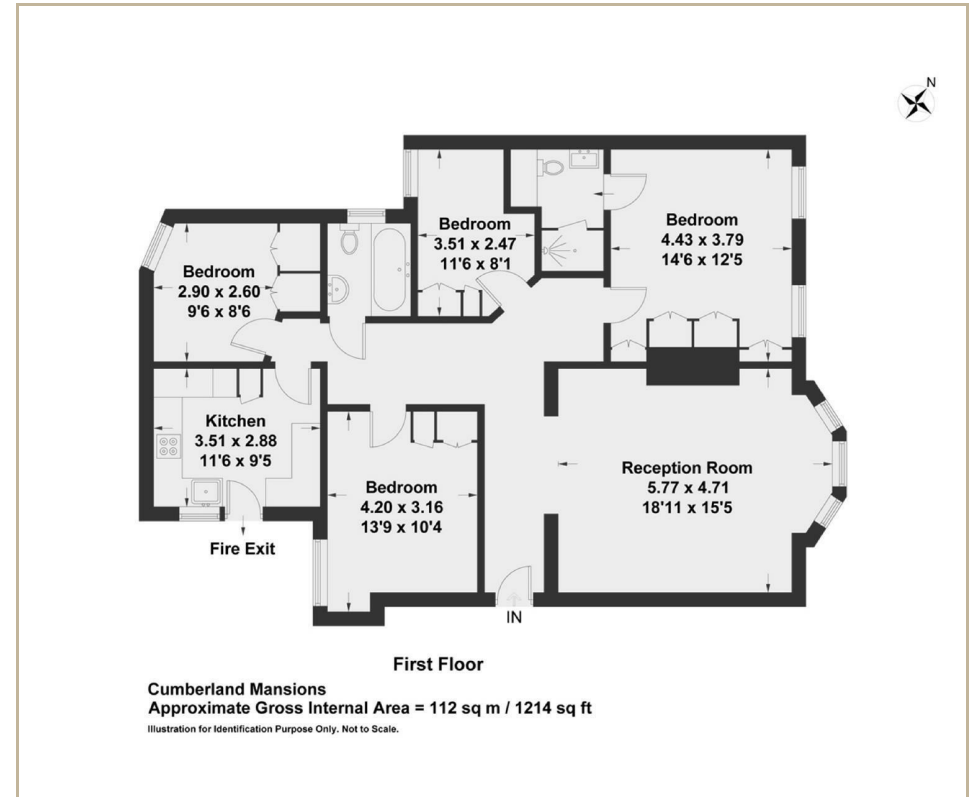

TERMS

For Clarification we wish to inform prospective purchasers that we have prepared these sales particulars as a general guide. We have not carried out a survey, nor tested the services, appliances and specific fittings. Room sizes are approximate and rounded: they are taken between internal wall surfaces and therefore include cupboards/shelves, etc. Accordingly, they should not be relied upon for carpets and furnishings. Formal notice is given that all fixtures and fittings, carpeting, curtains/blinds and kitchen equipment, whether fitted or not, are deemed to be removable by the vendor unless specifically itemised within these sales particulars.

T. +44 (0) 20 7935 0011
 E. enquire@napierwatt.co.uk
WWW.NAPIERWATT.CO.UK

NAPIER WATT
 PROPERTY CONSULTANTS