



SAMUEL WOOD



5 Lower Galdeford

Ludlow, Shropshire, SY8 1RN

This 2 bedroom centrally located cottage with accommodation that includes: Living Room, Kitchen, Rear Lobby, Bathroom, First Floor Landing with 2 Bedrooms, small rear yard and store. The property is available unfurnished. EPC Rating E

Rent: **£475 Per Month**

t: 01588 672728

e: cravenarms@samuelwood.co.uk

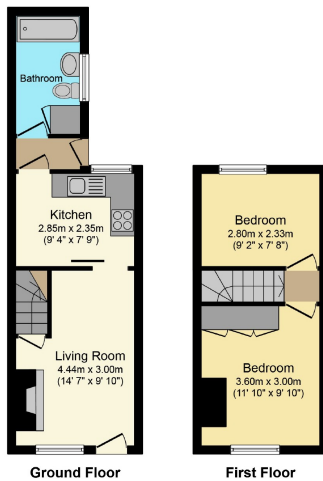

This Floor Plan is for illustration purposes only and may not be representative of the property. The position and size of doors, windows and other features are approximate. Unauthorized reproduction prohibited. © PropertyBox

Services: Mains electricity, mains water, mains drainage.

Tenancies Tenancies via Samuel Wood are normally on a Six Month Assured Shorthold Tenancy unless specified on the Front Page of the Brochure.

Application forms Available from any of our offices. NB. The submission of a referencing application is not guarantee of tenancy.

Utilities Tenants are responsible for payment of Council Tax and utility bills.

Deposit and First Month's Rent All tenants must provide these prior to signing the Tenancy Agreement. Cheque payments require a minimum of 5 days working to clear. Deposits are registered with The Tenant Deposit Scheme.

Printed on: 28th October 2020
Ref: 8662 Last Amended: 28th October 2020

UK PROPERTY
AWARD WINNING
ESTATE AGENTS FROM
2014 TO 2018



also Mayfair Office, London

We take every care in preparing our sales details. They are checked and usually verified by the Vendor. We do not guarantee appliances, alarms, electrical fittings, plumbing, showers, etc. You must satisfy yourself that they operate correctly. Room sizes are approximate; they are usually taken in metric and converted to imperial. Do not use them to buy carpets or furniture. We cannot verify the tenure, as we do not have access to the legal title; we cannot guarantee boundaries or rights of way so you must take the advice of your legal representative. No person in the employment of or representing Samuel Wood has any authority to make or give any representation or warranty whatever in relation to this property. If there is any point which is of particular importance to you, please contact the office and we will be pleased to check the information. Do so particularly if contemplating travelling some distance to view. Applicants are advised that the majority of our shots are taken with a wide angle lens.