



Churchway Piece, Inkberrow, Worcester WR7 4HB | £260,000
Three Bedroom Mid Terraced House

Features:

- Three Bedrooms
- Office/Work Space
- Lounge/Diner
- kitchen
- Guest WC
- Garage

Summary:

A well presented three bedroom mid terraced property situated in the sought after village location of Inkberrow.

Description:

This property has been well presented and is deceptively spacious. The ground floor benefits from a large lounge/diner, fitted kitchen with space for free standing appliances and access to a covered walkway leading to the garage. The first floor offers the master suite with fitted storage, bedroom two and three of good proportion and a smaller room suitable for use as an office/study. The bathroom has been modernised and benefits from a bath, sink, WC and separate shower enclosure.

Outside:

The front aspect of the property is approached via a tarmac laid drive with space for two vehicles to off road park. The rear of the property is mainly laid to lawn with fenced boundaries, a paved patio area and timber potting shed.

Location:

Inkberrow is one of the largest villages in Worcestershire, occupying an ideal rural location between Worcester (12 miles), Redditch (8 miles) and Alcester (6 miles), with public transport links to all towns. The landscape is ideal for walking, cycling, rambling, or horse-riding. In addition, Inkberrow is a well-equipped village with local shop, post office, public houses, school, doctors surgery, outstanding sports facilities and a village church.



Room Dimensions:

Hall

Downstairs WC

Lounge/Diner:

24' 9" x 11' 3" (7.55m x 3.43m)

Kitchen:

14' 3" x 7' 0" (4.35m x 2.15m)

Garage:

15' 10" x 10' 5" (4.85m x 3.18m)

Stairs To First Floor Landing

Master Bedroom:

11' 2" x 10' 5" (3.42m x 3.20m)

Bedroom Two:

10' 11" x 10' 5" (3.35m x 3.18m)

Bedroom Three:

14' 9" x 8' 2" (4.50m x 2.50m) max

Bedroom Four:

10' 5" x 4' 7" (3.20m x 1.42m)

Bathroom:

10' 5" x 5' 6" (3.20m x 1.68m)

EPC: D

Council Tax Band: C

Tenure: Freehold

For more information on Churchway Piece or to arrange a viewing, please call the Redditch Office on 01527 540 654



Churchway Piece, Inkberrow

First Floor

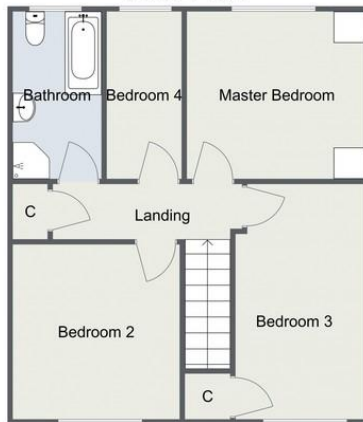

Ground Floor



Total Area Approx:
112.1 sq metres (1207 sq ft)

For illustrative purposes only. Decorative finishes, fixtures & fittings do not represent the current state of the property. Measurements are approximate & not to scale. Floor Plans made using RoomSketcher.

Churchway Piece, Inkberrow First Floor



Ground Floor



Total Area Approx:
112.1 sq metres (1207 sq ft)

For illustrative purposes only. Decorative finishes, fixtures & fittings do not represent the current state of the property. Measurements are approximate & not to scale. Floor Plans made using RoomSketcher.

Please read the following: These particulars are for general guidance only and are based on information supplied and approved by the seller. Complete accuracy cannot be guaranteed and may be subject to errors and/or omissions. They do not constitute a contract or part of a contract in any way. We are not surveyors or conveyancing experts therefore we cannot and do not comment on the condition, issues relating to title or other legal issues that may affect this property. Interested parties should employ their own professionals to make enquiries before carrying out any transactional decisions. Photographs are provided for illustrative purposes only and the items shown in these are not necessarily included in the sale, unless specifically stated. The mention of any fixtures, fittings and/or appliances does not imply that they are in full efficient working order and they have not been tested. All dimensions are approximate. We are not liable for any loss arising from the use of these details.