



144 Royal Navy Avenue | Keyham | Plymouth | PL2 2AN

Guide £150,000-£160,000

A three bedroom mid terraced property with flexible accommodation.

Upon inspection you will find this recently decorated property offers an open plan lounge, kitchen and bathroom on the ground floor, three bedrooms on the first floor and on the lower ground floor is a large utility room, walk-in storage cupboard and a cellar area. The property benefits from Upvc double glazing, low maintenance rear garden and a single garage.

Also of note is the proximity to local parks and the branch line train station.

- Three Bedrooms
- Mid Terraced House
- Upvc Double Glazing
- Flexible Accommodation
- Close To Local Facilities
- Single Garage To Rear
- Close To Train Station

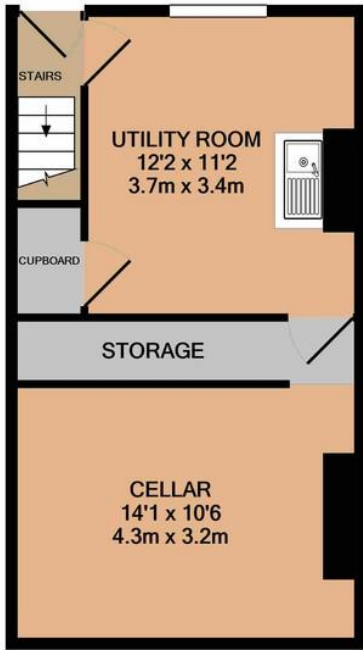

BASEMENT LEVEL  
APPROX. FLOOR  
AREA 352 SQ.FT.  
(32.7 SQ.M.)

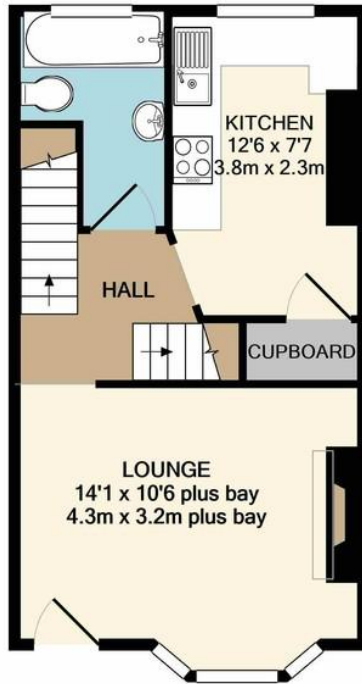

GROUND FLOOR  
APPROX. FLOOR  
AREA 364 SQ.FT.  
(33.8 SQ.M.)

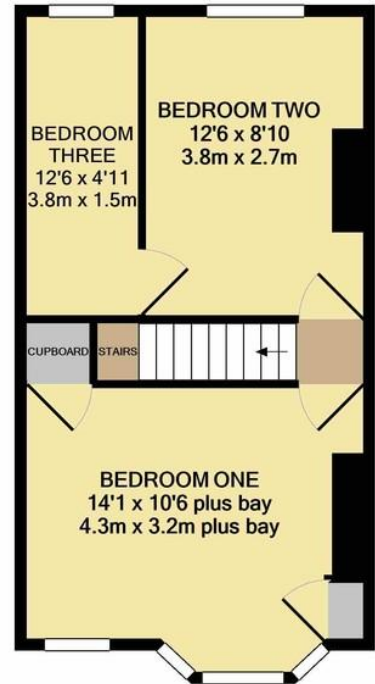

1ST FLOOR  
APPROX. FLOOR  
AREA 359 SQ.FT.  
(33.4 SQ.M.)

TOTAL APPROX. FLOOR AREA 1075 SQ.FT. (99.8 SQ.M.)

Whilst every attempt has been made to ensure the accuracy of the floor plan contained here, measurements of doors, windows, rooms and any other items are approximate and no responsibility is taken for any error, omission, or mis-statement. This plan is for illustrative purposes only and should be used as such by any prospective purchaser. The services, systems and appliances shown have not been tested and no guarantee as to their operability or efficiency can be given

Made with Metropix ©2020

## Contact Details

48 Ebrington Street  
Plymouth  
Devon  
PL4 9AD

www.athomelettings.com  
info@athomeproperty.co.uk  
01752 777070

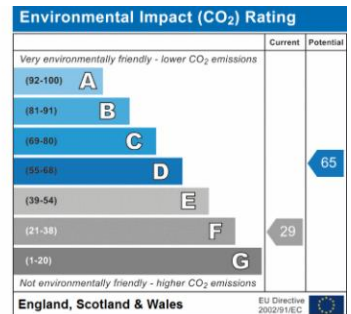
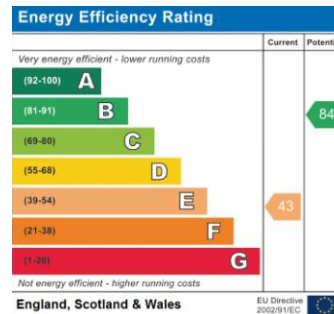

Agents Note: Whilst every care has been taken to prepare these sales particulars, they are for guidance purposes only. All measurements are approximate are for general guidance purposes only and whilst every care has been taken to ensure their accuracy, they should not be relied upon and potential buyers are advised to recheck the measurements