



Chiswick Lane, London, W4 2JQ

Price Guide £425,000



SALES · LETTINGS · COMMERCIAL

- Well presented one bedroom flat
- Share in freehold
- Close to Turnham Green Tube and Chiswick High Road
- 24' reception room
- Ideally situated overlooking Ashbourne Grove
- Fully integrated kitchen

Tenure - Share of Freehold
 Service Charge - 20% of outgoings
 Local Authority - Hounslow
 Council Tax - Band D (£1607.00 pa)

THE PROPERTY

A well presented one bedroom flat offering excellent lateral space in this period conversion flat and close to all amenities. Accommodation comprises a double bedroom, 24' reception room, fully integrated kitchen, luxury shower room, extensive built-in storage, and a share in the freehold. Ideally situated overlooking Ashbourne Grove offering close proximity to Homefield recreation ground with its children's park, sporting areas, and park. Turnham Green tube station and the extensive facilities on Chiswick High Road are also close to hand.

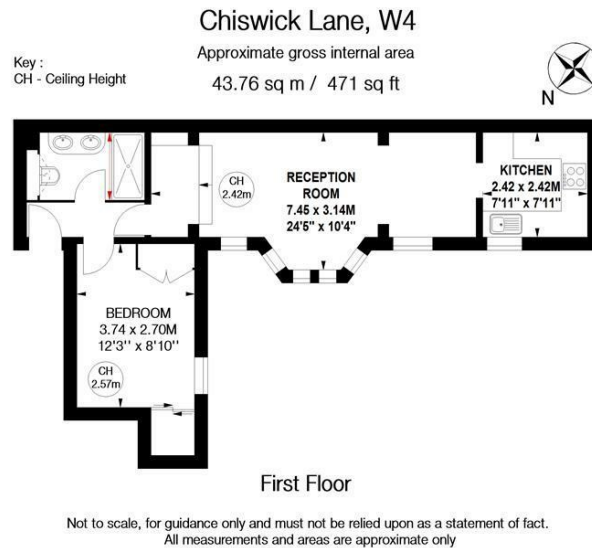

SITUATION



5-7 Turnham Green Terrace, Chiswick, London, W4 1RG

Tel 020 8747 8800

E-mail sales@whitmanandco.com

Website www.whitmanandco.com