

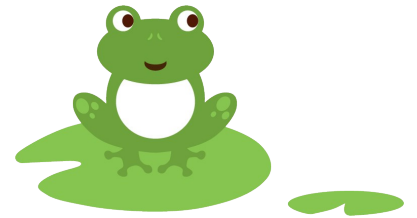

ESTATES

MANAGEMENT, SALES & LETTINGS



119 Club Garden Road, Sheffield, S11 8BW

£76.00 PPPW

5 BEDROOM HOUSE IN THE HEART OF SHARROW, conveniently located close to London Road, Ecclesall Road, Hallam University and the City Center.

A fantastic fully modernised 5 bedroom, spacious student house with a living room/dining area and extended modern kitchen.

£380 Per Week
Available: 1st July 2021

- 5 Double beds
- Fantastic location
- Fully furnished
- Great Location!
- Modern Furnishings
- 2 Bathrooms with Showers
- 43" TV INCLUDED
- Rear garden
- Kitchen / Diner
- All inclusive available



T: 0114 272 7787 | E: info@bps-estates.co.uk | www.bps-estates.co.uk



ESTATES

MANAGEMENT, SALES & LETTINGS

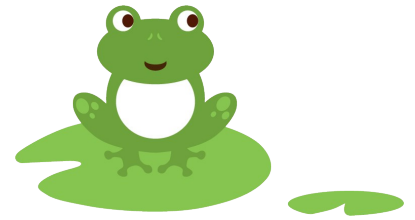

Ground Floor

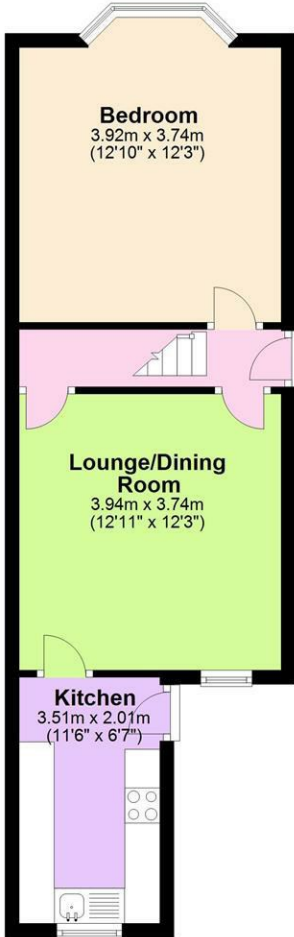

First Floor

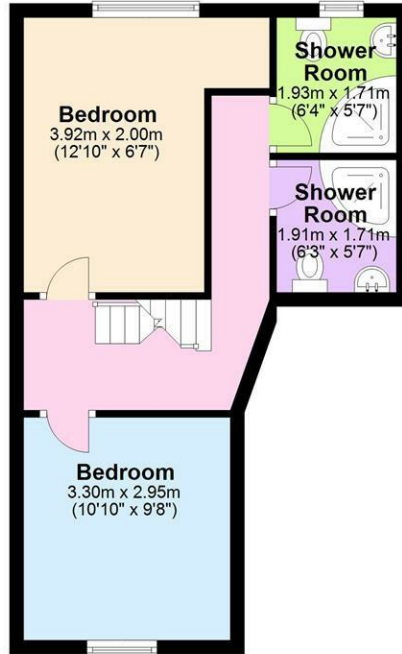

Second Floor

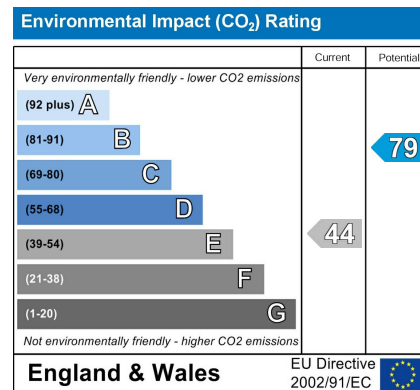
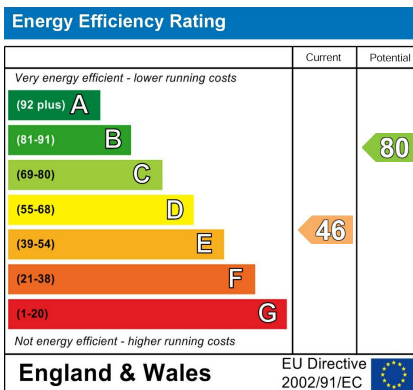
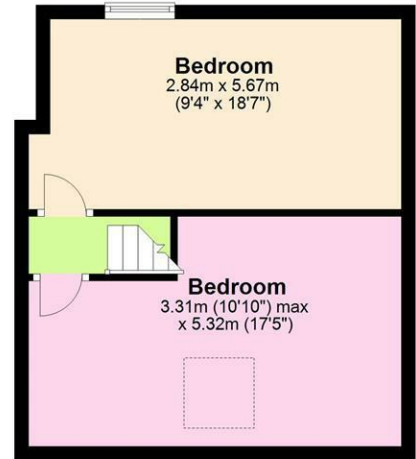

BPS Estates (Part of Broomhill Property Shop)
 319 Glossop Road, Sheffield, S10 2HP
 T: 0114 272 7787 | E: info@bps-estates.co.uk
 W: www.bps-estates.co.uk