



4 Birch Grove, Sheringham, NR26 8NT

£290,000

- Detached Bungalow
- Three bedrooms
- Open Plan Lounge Diner
- EPC Rating: TBC

This detached three bedroom bungalow lies in a quiet residential area of the sought after seaside town of Sheringham. The property consists of three bedrooms a family bathroom, fitted kitchen and large open plan lounge diner. To the outside there is a fully enclosed large garden, driveway and garage.



Property Description

OVERVIEW

This detached bungalow lies in a quiet residential area of the sought-after seaside town of Sheringham. The town has a wealth of amenities, shops, schools, restaurants, transport links, an 18-hole golf course, leisure centre and of course stunning beaches that north Norfolk has to offer.

The bungalow consists of a fully fitted kitchen, large lounge diner, three bedrooms and a family bathroom. To the rear there is a fully enclosed large garden and patio. To the front of the property there is a driveway with ample parking and a garage.

ENTRANCE HALL

Door to the front, carpets and doors off to the lounge.

KITCHEN

double glazed window to the front, fully fitted kitchen with wall and base units, sink drainer, integrated double oven and tiled floors.

LOUNGE- DINING ROOM

Large lounge with double glazed window to the front, laminated wood floor, storage heater, tv point and doors off to kitchen bedrooms and bathroom.

BEDROOM

Double bedroom with double glazed window to the rear, carpet and storage heaters.

BEDROOM

Double glazed window to the rear, carpets, and storage heater.

BEDROOM

Double bedroom with double glazed window to the rear, carpets and storage heaters.

GARDEN





Fully enclosed garden to the rear, mainly laid to lawn with patio area .

FRONT

Driveway with plenty of parking along with garage .

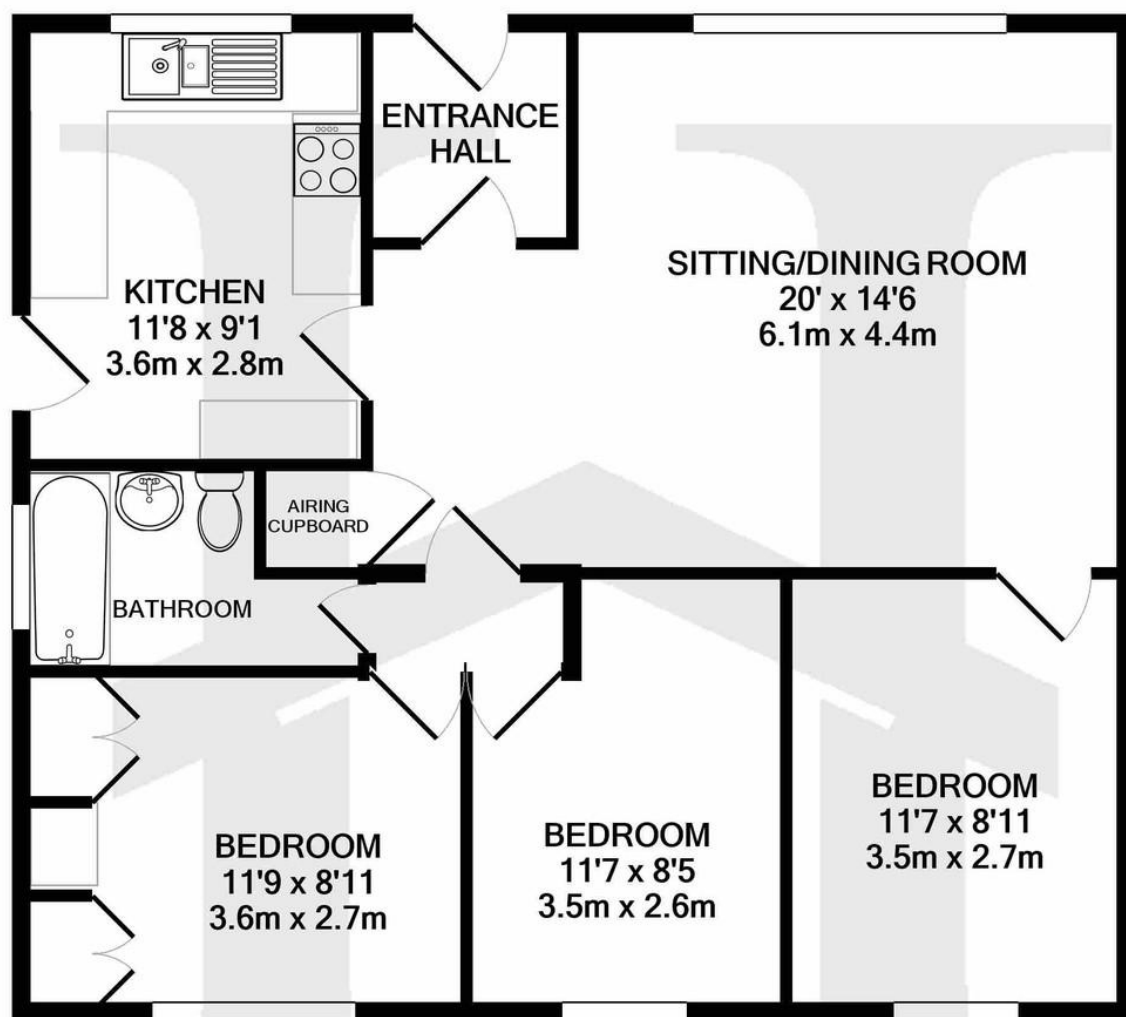

%epcGraph_c_1_334%

15 West Street, Cromer, Norfolk,
NR27 9HZ

☎ 01263 511111
✉ cromer@henleysea.co.uk
henleysea.co.uk

Agents Note: Whilst every care has been taken to prepare these sales particulars, they are for guidance purposes only. All measurements are approximate and for general guidance purposes only and whilst every care has been taken to ensure their accuracy, they should not be relied upon and potential buyers are advised to recheck the measurements.