



ASPIRE

— TO MOVE —



55 Newbridge Road Newbridge, Bath, BA1 3HF

Video and physical viewings available. Seven bedroom student property located on Newbridge Road, Bath. Available July 2021 for a 12 month contract. The property is offered fully furnished.

Newbridge occupies an area to the west of Bath city centre, just north of the River Avon. The main shopping area in Newbridge is Chelsea Road, a small area of shops, restaurants and hairdressers. Shops include a bakery, a hardware shop, a SPAR supermarket, a cycle shop and nearby on Newbridge Road a post office.

£3,325 PCM

55 Newbridge Road

Newbridge, Bath, BA1 3HF



- Seven double bedrooms
- Available July 2021
- Furnished
- Newbridge Road
- Good access for Bath spa university
- Video viewing available

Seven bedroom student property located on Newbridge Road, Bath. Available July 2021 for a 12 month contract. The property is offered fully furnished.

Newbridge occupies an area to the west of Bath city centre, just north of the River Avon. The main shopping area in Newbridge is Chelsea Road, a small area of shops, restaurants and hairdressers. Shops include a bakery, a hardware shop, a SPAR supermarket, a cycle shop and nearby on Newbridge Road a post office. Bus stops can be found at regular intervals along both Newbridge Road and Newbridge Hill which provide access to Bath city centre and both universities. Bath spa train station is 1.7 miles from Chelsea Road. The area benefits from its close proximity to the Royal United Hospital.

The living accommodation is spread over two floors. All bedrooms are doubles and come with bed, desk, chair and wardrobe. On the ground floor there are three bedrooms and the kitchen/living/dining room. This room has base and wall units, cooker, hob, fridge/freezer, and washing machine. Dining table and chairs as well as a sofa are also provided. On the second floor there are the further four bedrooms as well as a bathroom and separate WC.

Available to students from July 2021.



Directions



Floor Plan

GROUND FLOOR
874 sq.ft. (81.2 sq.m.) approx.



1ST FLOOR
766 sq.ft. (71.2 sq.m.) approx.

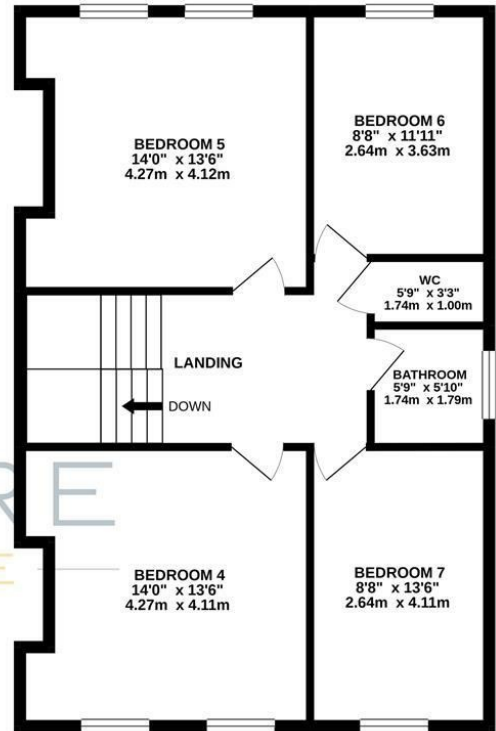

TOTAL FLOOR AREA : 1640 sq.ft. (152.4 sq.m.) approx.

Whilst every attempt has been made to ensure the accuracy of the floorplan contained here, measurements of doors, windows, rooms and any other items are approximate and no responsibility is taken for any error, omission or mis-statement. This plan is for illustrative purposes only and should be used as such by any prospective purchaser. The services, systems and appliances shown have not been tested and no guarantee as to their operability or efficiency can be given.
Made with Metropix ©2020

These particulars, whilst believed to be accurate are set out as a general outline only for guidance and do not constitute any part of an offer or contract. Intending purchasers should not rely on them as statements of representation of fact, but must satisfy themselves by inspection or otherwise as to their accuracy. No person in this firm's employment has the authority to make or give any representation or warranty in respect of the property.

