

**TO LET**



**Ethelred Close, Welwyn Garden City**

**1 Bedroom, 1 Bathroom, End Terraced House**

**£1,200 pcm**



**Ethelred Close, Welwyn Garden**

**City**

**1 Bedroom, 1 Bathroom**

**£1,200 pcm**

Date available: Available Now

Deposit: £1,384.61

Unfurnished

Council Tax band: C

- One Double Bedroom
- End of Terrace House
- Reception
- Kitchen with White Goods
- Garden
- Garage
- Gas Central Heated







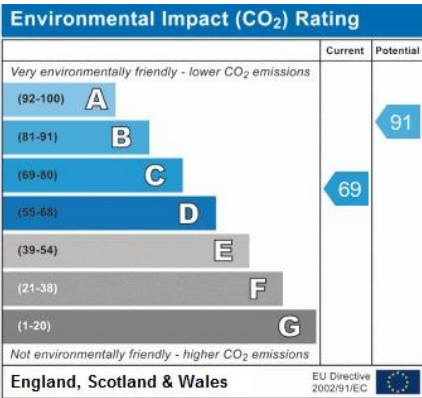
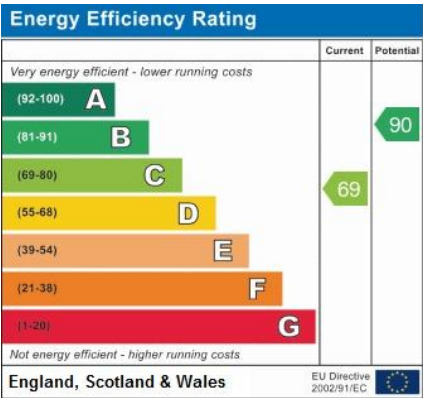







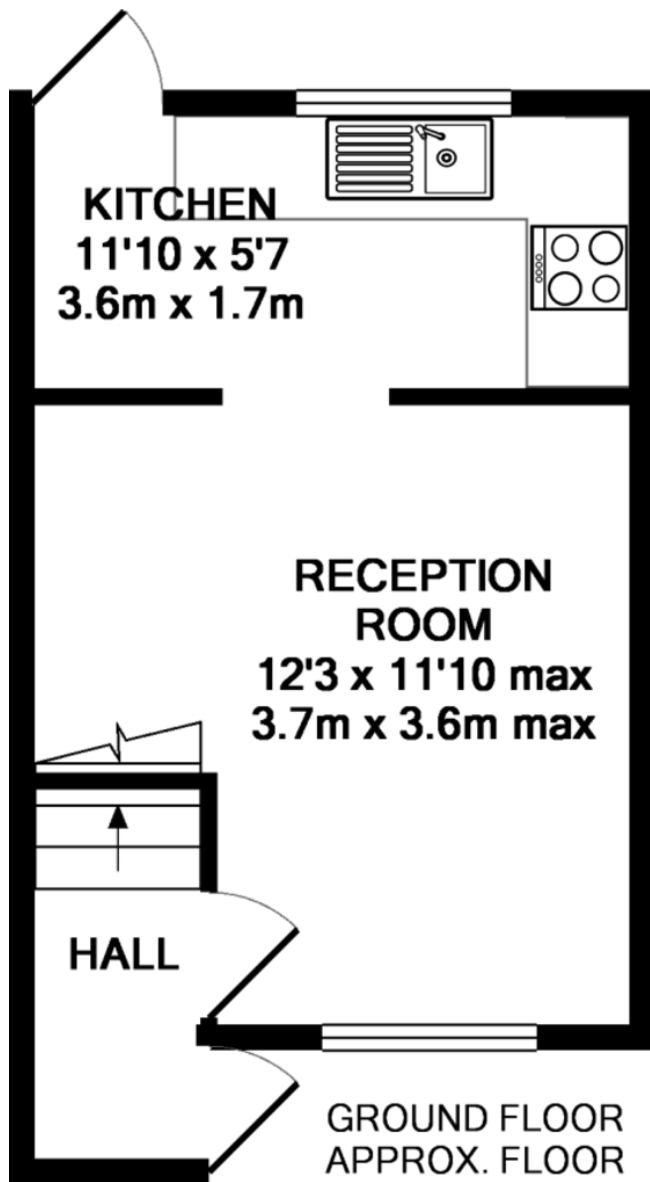

GROUND FLOOR  
APPROX. FLOOR  
AREA 221 SQ.FT.  
(20.5 SQ.M.)

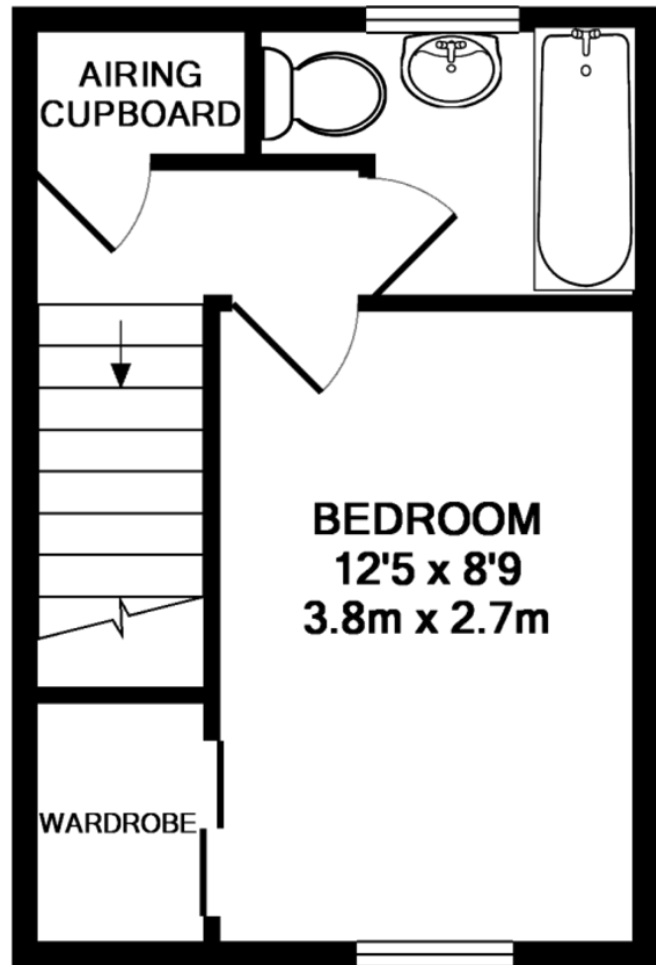

1ST FLOOR  
APPROX. FLOOR  
AREA 212 SQ.FT.  
(19.7 SQ.M.)

**TOTAL APPROX. FLOOR AREA 433 SQ.FT. (40.2 SQ.M.)**

This floor plan is for illustrative purposes only.

The measurement and position of each element is approximate and must be viewed as such.

**Martin & Co Welwyn**

16 Howardsgate • Welwyn Garden City • AL8 6BQ  
T: 01707 334576 • E: welwyn@martinco.com

**01707 334576**

<http://welwyn.martinco.com>

**MARTIN&CO**

**Accuracy:** References to the Tenure of a Property are based on information supplied by the Seller. The Agent has not had sight of the title documents. A Buyer is advised to obtain verification from their Solicitor. Items shown in photographs including but not limited to carpets, fixtures and fittings are not included unless specifically mentioned within the sales particulars. They may however be available by separate negotiation. Buyers must check the availability of any property and make an appointment to view before embarking on any journey to see a property. No person in the employment of the agent has any authority to make any representation about the property, and accordingly any information given is entirely without responsibility on the part of the agents, sellers(s) or lessors(s). Any property particulars are not an offer or contract, nor for part of one. **Sonic / Laser Tape:** Measurements taken using a sonic / laser tape measure may be subject to a small margin of error. **All Measurements:** All Measurements are Approximate. **Services Not tested:** The Agent has not tested any apparatus, equipment, fixtures and fittings or services and so cannot verify that they are in working order or fit for the purpose. A Buyer is advised to obtain verification from their Solicitor or Surveyor.