

241 Deansgate, Manchester, Lancashire, M3 4EL

Tel: 0161 637 8336

Email: contactus@ascendproperties.com

www.ascendproperties.com

Ascend

Built on higher standards



Alto, Sillavan Way, Salford

£875 PCM

Welcome to Alto: an ultra-modern development nestled in the nook of the River Irwell. Step inside and you'll see this lovely two bedroom apartment, with a contemporary design that stays bright under the sunny skies of Manchester.

You'll have the comfort of high-quality fixtures and fittings including Villeroy & Boch sanitary ware, and the open-plan kitchen/lounge has plenty of space for all your get-togethers, gatherings, shindigs and lazy Sundays. There's a large master bathroom, and for those who like a bit more privacy, there's an ensuite in one of the rooms too - so no early-morning queues. The apartment benefits from a new sofa and a full redecoration. Just down the road are Spinningfields' swanky bars and shops, and beyond that is the city centre itself. Leave the car at home and relax as there is one allocated parking space.

If you're interested in having a closer look, or have any questions, do get in touch. And just so you know, the pictures for this apartment are for marketing purposes only. The internal fixtures, fittings and furnishings may vary.

Available Now



Ascend

Built on higher standards

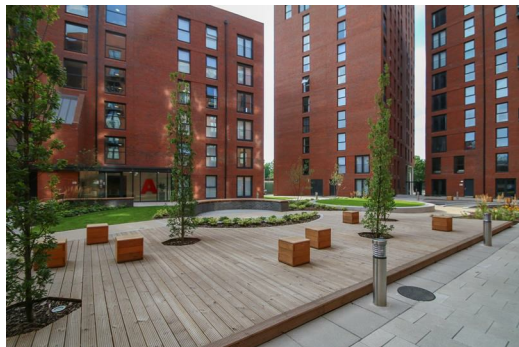

| Energy Efficiency Rating | | Environmental Impact (CO ₂) Rating | |
|--------------------------|----------|--|----------|
| Current | Target | Current | Target |
| Energy A | Energy B | Enviro A | Enviro B |
| Energy B | Energy C | Enviro B | Enviro C |
| Energy C | Energy D | Enviro C | Enviro D |
| Energy D | Energy E | Enviro D | Enviro E |
| Energy E | Energy F | Enviro E | Enviro F |
| Energy F | Energy G | Enviro F | Enviro G |
| Energy G | Energy H | Enviro G | Enviro H |
| Energy H | Energy I | Enviro H | Enviro I |
| Energy I | Energy J | Enviro I | Enviro J |

Energy Efficiency Rating: Current **B**, Target **A** (74-75)
 Environmental Impact (CO₂) Rating: Current **B**, Target **A** (78-79)

Ascend

Built on higher standards