



Kings Avenue, Clapham, SW4

2 bedroom flat to let

£330 Per Week

Furnished

Property Details

Keating Estates has the pleasure of introducing to the market a first floor purpose built flat set within a lovely art deco period mansion block. The flat is light and airy with neutral yet stylish decor. The private front door to the flat is situated off a communal entrance hall. Once inside there is a wide and elegant hallway, off the hallway are two bedrooms, a large modern bathroom, a fully fitted kitchen and a very spacious reception room. The property benefits from communal gardens and is close to Abbeville Village.

Features

- Bright and airy
- Close to transport links
- Separate kitchen
- Around a 22 minute walk to Clapham Common
- Around an 18 minute walk to Clapham North tube
- 2 double bedrooms

Council tax band C EPC rating D (65)



Kings Avenue, Clapham, SW4

K

2 bed flat.

Approx internal area:

706sqft 66sqm

While we do try our very best, floor plans are produced as a guide only and we take no responsibility for the precise accuracy with which any property is represented

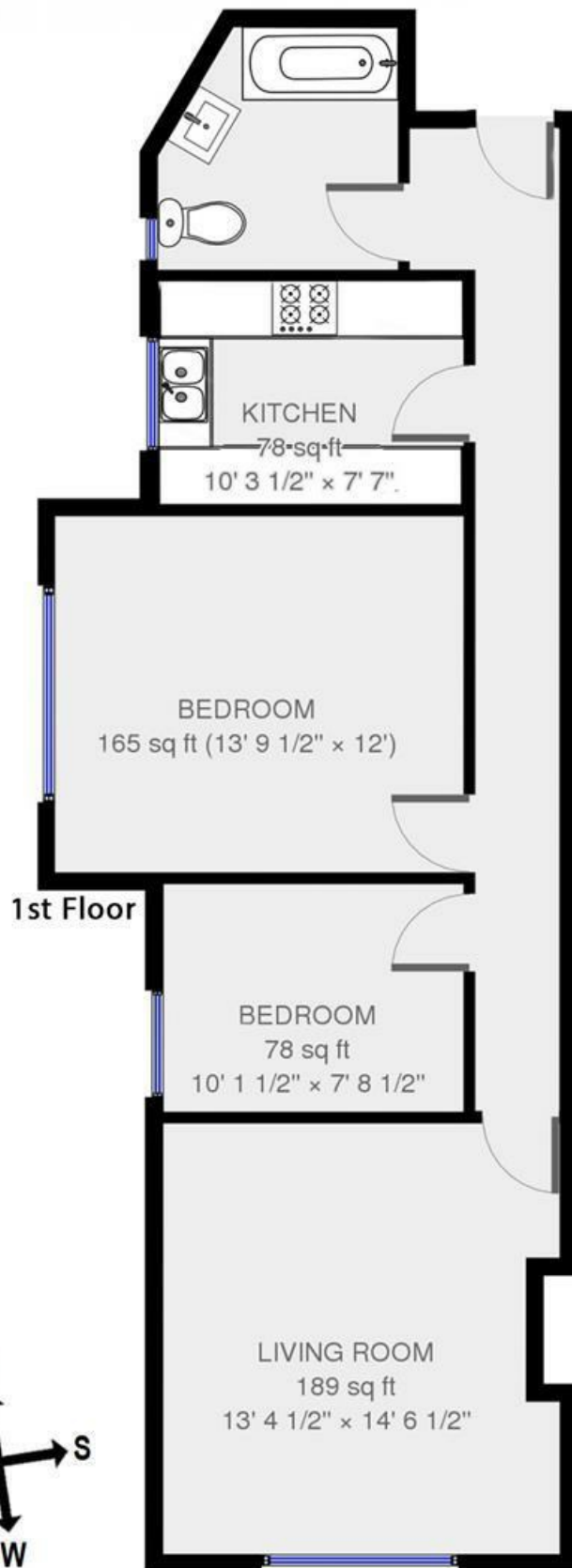

Thorncliffe Court

Kings Avenue, Clapham, SW4

