



629 sq
ft



3



1



1

REDBRIK
ESTATE AGENTS



Helping you find
your home at...

Oxclose Park Rise, Halfway

£170 pw

Occupying a quiet cul-de-sac position in the poplar suburb of Halfway is this superbly presented three bedroom town house. With a modern feel throughout, the property offers light & airy accommodation across two floors with a generous lounge/diner, modern fitted kitchen with adjoining W.C./utility space, three well proportioned bedrooms and a bathroom. Well placed for local shops/amenities and transport links including the Supertram network.

- Three Bedroom Town House
- Lounge Diner With French Doors To Garden
- Modern Fitted Kitchen With Adjoining W.C./Utility
- Quiet Cul-De-Sac Position
- Bathroom With Three Piece White Suite
- Driveway/Off Road Parking
- Rear Garden With Patio & Lawn
- Ground Floor W.C.
- uPVC DG, Gas Central Heating
- Energy Rating - C .





We endeavour to make these particulars as accurate as possible, but they should only be used as guidance and they do not constitute any part of the contract. All measurements are approximate and no guarantees are made to the services, heating systems, appliances (if any) or fittings as to their working order and no warranty can be given or implied.

Ground Floor

Approx. 30.3 sq. metres (326.1 sq. feet)

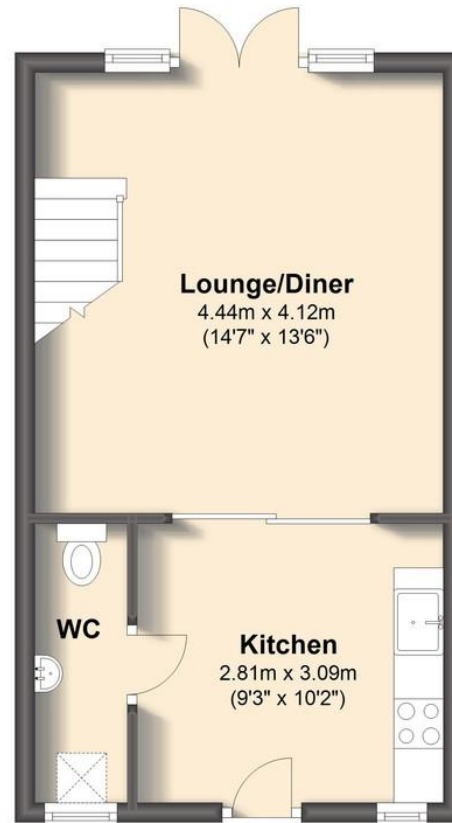

First Floor

Approx. 28.2 sq. metres (303.7 sq. feet)

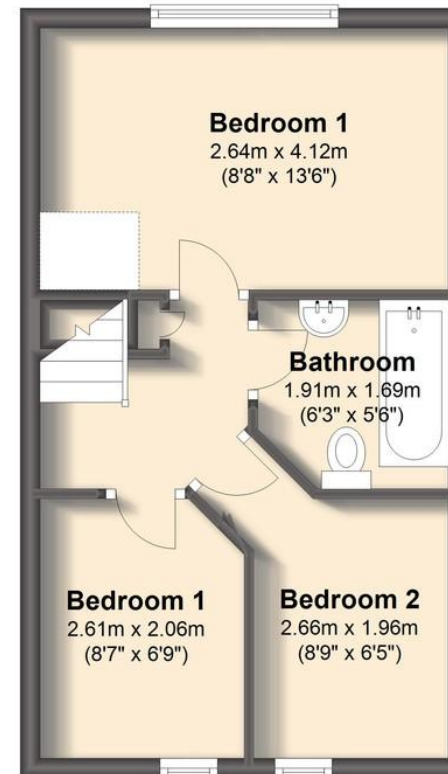

Total area: approx. 58.5 sq. metres (629.7 sq. feet)

You may download, store and use this material for your own personal use and research. You may not republish, retransmit, redistribute or otherwise make the material available to any party or make the same available on any website, on or off line service or hard copy without the website owner's express written consent. The website owner's copy right must remain on all reproductions of material taken from this website.

