



## 165C Coldharbour Lane

, SE5 9PA

**£1,100 PCM**

A first-floor one-bedroom period conversion flat offered to the market in good condition. The property is situated on the borders of Brixton and within easy reach of Loughborough Junction train station. The property benefits from having a modern fitted kitchen breakfast room, high ceilings and central heating.

- PERIOD CONVERSION FLAT
- ONE BEDROOM
- HIGH CEILINGS
- MODERN KITCHEN BREAKFAST ROOM
- CENTRAL HEATING
- SASH WINDOWS
- WHITE FITTED BATHROOM SUITE
- EXCELLENT LOCATION

### Viewing

Please contact our Galloways West Norwood Office on if you wish to arrange a viewing appointment for this property or require further information.



1



1



1



D



Floor Plan

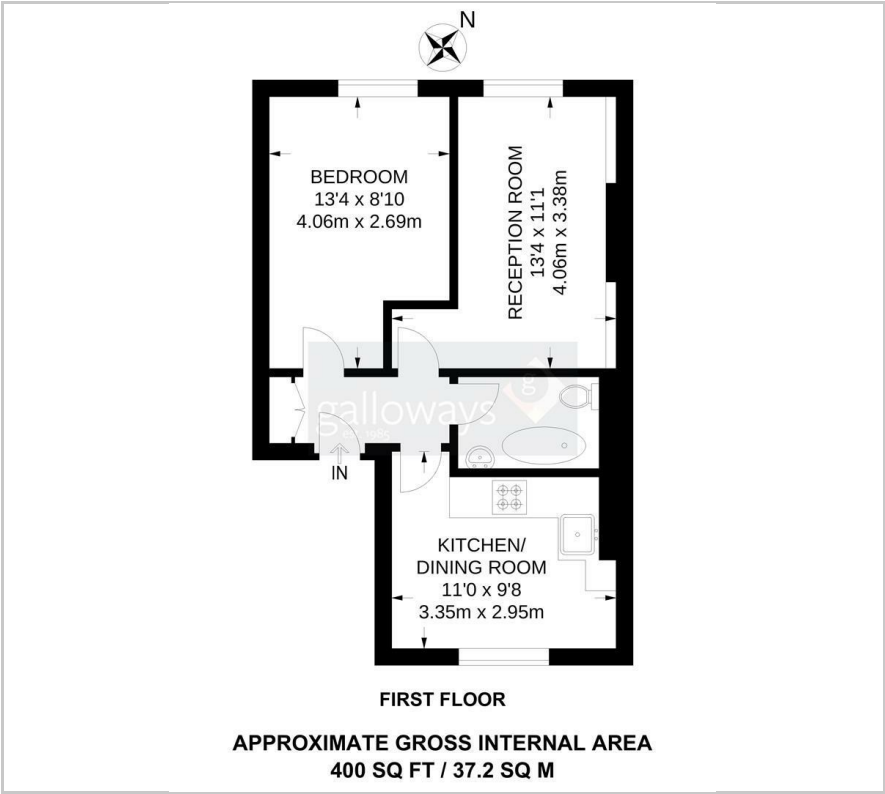

Area Map



Energy Efficiency Graph

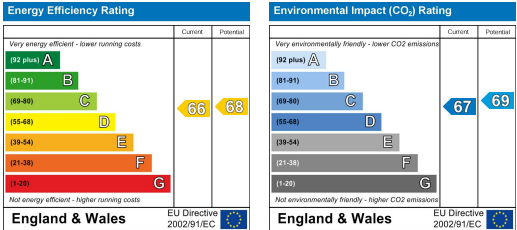

These particulars, whilst believed to be accurate are set out as a general outline only for guidance and do not constitute any part of an offer or contract. Intending purchasers should not rely on them as statements of representation of fact, but must satisfy themselves by inspection or otherwise as to their accuracy. No person in this firm's employment has the authority to make or give any representation or warranty in respect of the property.