



**THE PROPERTY CENTRE**  
THE AGENT PEOPLE RECOMMEND

**01242 504555**



## **2 BED HOUSE - SEMI-DETACHED REDDINGS ROAD, CHELTENHAM**

- SEMI-DETACHED
- TWO DOUBLE BEDROOMS
- WALK IN SHOWER
- LIVING ROOM
- DINING ROOM
- GAS CENTRAL HEATING
- GARAGE AND PARKING
- NO ONWARD CHAIN
- EPC D68

## **Agents note - should your offer be accepted**

In line with The Money Laundering Regulations 2007 we are duty bound to carry out due diligence on all of our clients to confirm their identity. Rather than traditional methods in which you would have to produce multiple utility bills and a photographic ID we use an electronic verification system. This system allows us to verify you from basic details using electronic data, however it is not a credit check of any kind so will have no effect on you or your credit history. You understand that we will undertake a



**THE PROPERTY CENTRE**  
THE AGENT PEOPLE RECOMMEND

**01242 504555**



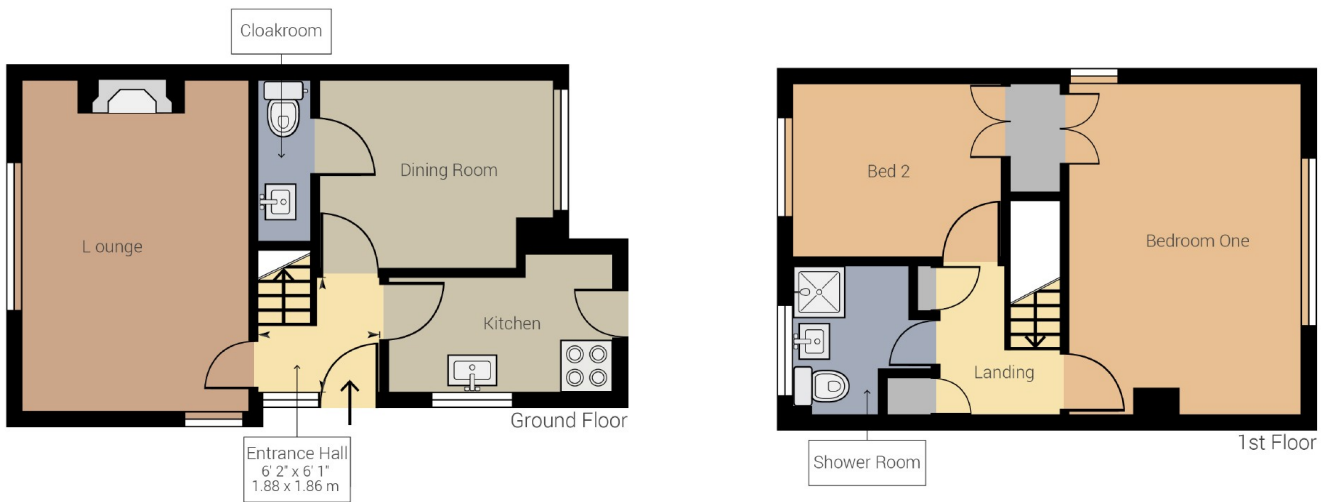

While every attempt has been made to ensure accuracy, all measurements are approximate, not to scale. This floor plan is for illustrative purpose only and should be used as such by any prospective tenant or purchaser.

Powered by Giraffe360

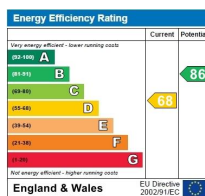

**RESIDENTIAL SALES - DISCLAIMER NOTICE:** Appliances such as radiators, heaters, boilers, fixtures or utilities (gas, water, electricity) which may have been mentioned in these details have not been tested and no guarantee can be given that they are suitable or in working order. We cannot guarantee that building regulations or planning permission has been approved and would recommend that prospective purchasers should make their own independent enquiries on these matters. All measurements are approximate.

**RESIDENTIAL LETTINGS – AGENTS NOTE:** Please note that following the introduction of the Tenant Fee Ban on 1 June 2019, most fees previously paid by tenants have now been waived. However, some charges remain. Further details can be found at [www.thepropertycentres.co.uk/lettings/lettings-service/tenant-fees-](http://www.thepropertycentres.co.uk/lettings/lettings-service/tenant-fees-)

VIEWING BY PRIOR APPOINTMENT VIA THE PROPERTY CENTRE ON 01242 504555

28 Bath Street, Cheltenham, Gloucestershire, GL50 1YA

[cheltenham@thepropertycentres.co.uk](mailto:cheltenham@thepropertycentres.co.uk) [www.thepropertycentres.co.uk](http://www.thepropertycentres.co.uk)

Follow us on [facebook.com/ThePropertyCentres](https://www.facebook.com/ThePropertyCentres) or on Twitter [@thepropertycent](https://twitter.com/thepropertycent)

