

Important notice: In accordance with the Property Misdescriptions Act (1991) we have prepared these sales particulars as a general guide to give a broad description of the property. They are not intended to constitute part of an offer or contract. We have not carried out a structural survey and the services, appliances and specific fittings have not been tested. All photographs, measurements, floor plans and distances referred to are given as a guide only and should not be relied upon for the purchase of carpets or any other fittings. Lease details, service charges and ground rent (where applicable) are given as a guide only and should be checked and confirmed by your solicitor prior to exchange of contracts.

Whilst every attempt has been made to ensure the accuracy of the floorplan contained here, measurements of doors, windows, rooms and any other items are approximate and no responsibility is taken for any error, omission or mis-statement. This plan is for illustrative purposes only and should be used as such by any prospective purchaser. The services, systems and appliances shown have not been tested and no guarantee as to their operability or efficiency can be given.
Made with Blueprints @ 2020

TOTAL FLOOR AREA: 599 sq.ft. (55.7 sq.m.) approx.

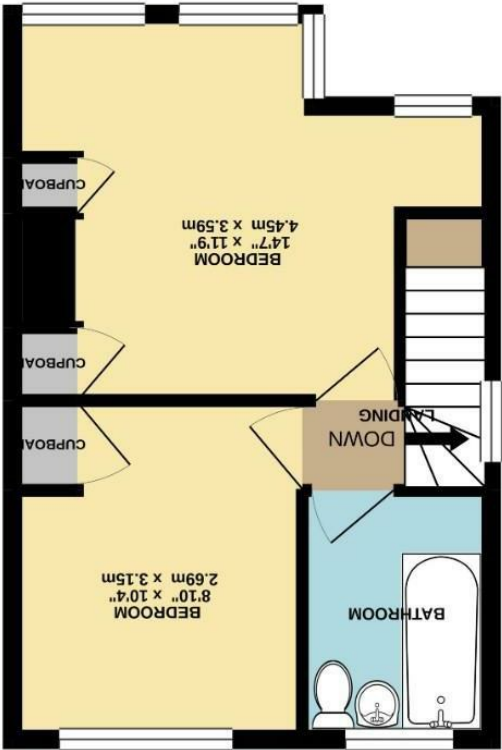
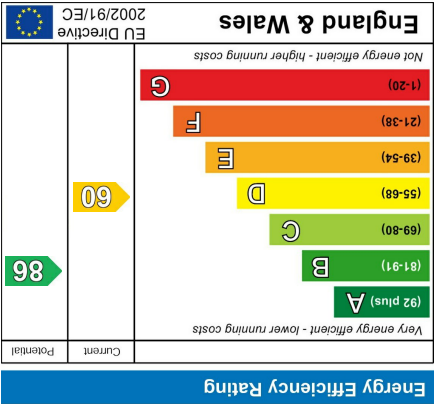

1ST FLOOR
302 sq.ft. (28.1 sq.m.) approx.

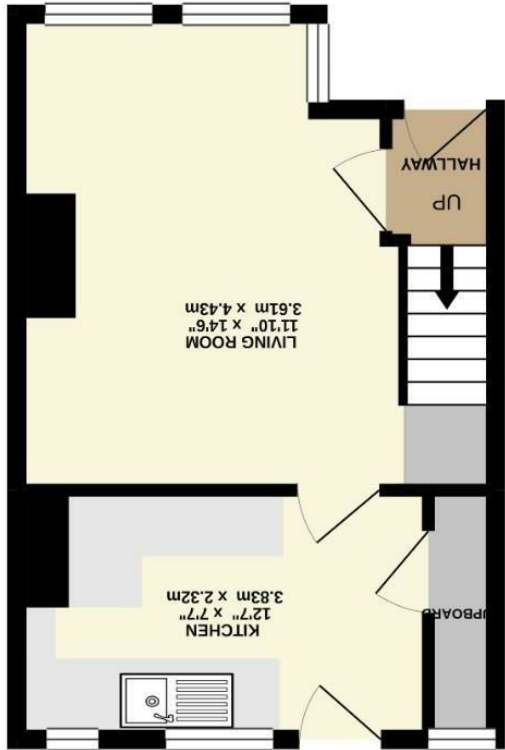

GROUND FLOOR
297 sq.ft. (27.6 sq.m.) approx.



17 Moore Avenue, York
£175,000



Ashtons



Description

In need of complete modernisation and refurbishment, this two bedroom semi detached property benefits from a corner plot with gardens to the front, side and rear.

The property is situated in this convenient location, handy for a range of shops, schools and amenities.