

1 Barlow Road, Stretford, M32 0RG



*JP & Brimelow*  
SALES



# Price: £340,000

**\*\*VIDEO TOUR AVAILABLE\*\*** An attractive & beautifully presented, FOUR BEDROOMED, period, bay fronted semi-detached property situated in a highly popular residential area off Talbot Road here in Stretford. Conveniently located for all local amenities, local Parks, Old Trafford cricket ground and Manchester United football stadium, the Trafford Centre, both Media City and Chorlton centre are a twenty-minute walk with its independent shops/restaurants/cafe society. The Metrolink in Old Trafford provides access into Media City, Deansgate and Altrincham. The well-planned accommodation comprises; vestibule, entrance hall, downstairs W.C, a lounge with bay window to the front aspect, an open plan fitted kitchen/breakfast area leading to a dining room and there is a utility room/conservatory with access out into the rear enclosed paved garden. To the first floor there is a landing leading to four well portioned bedrooms and a beautiful fitted four-piece family bathroom. The property benefits; an alarm system, double glazed, warmed by gas fired central heating and an enclosed rear with a timber storage shed. OFFERED WITH NO VENDOR CHAIN. Early internal viewing is highly recommended to appreciate this fantastic home.





EPC Chart

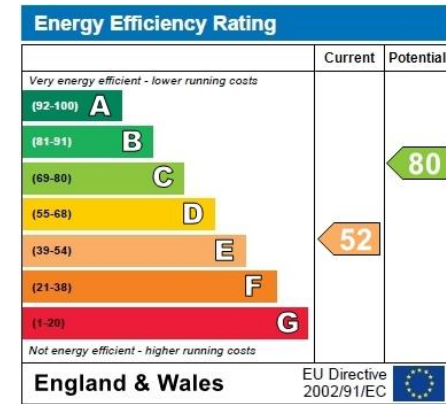

Leasehold With an original lease of 999 years with 889 years remaining. The annual ground rent charge is £5. (Information as per current vendor) October 2020. Council Tax Band: B



## Ground Floor

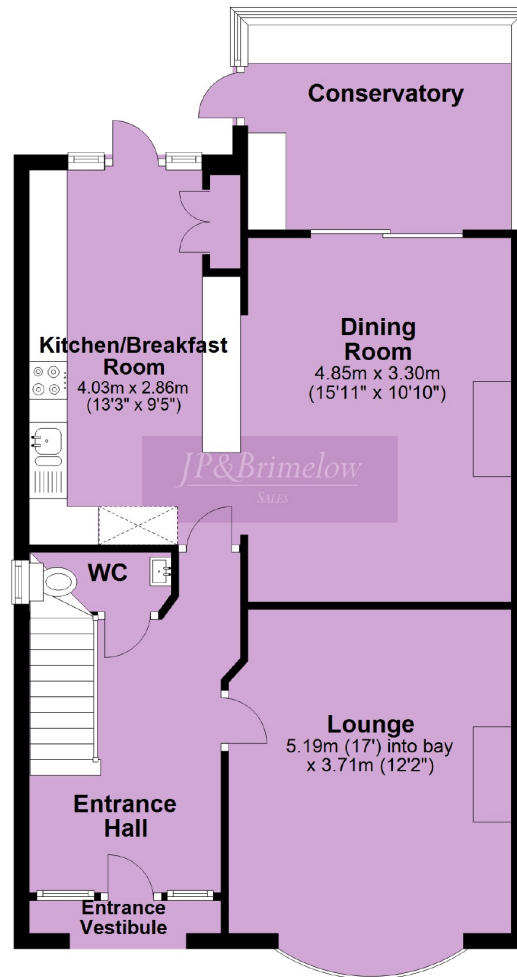

## First Floor

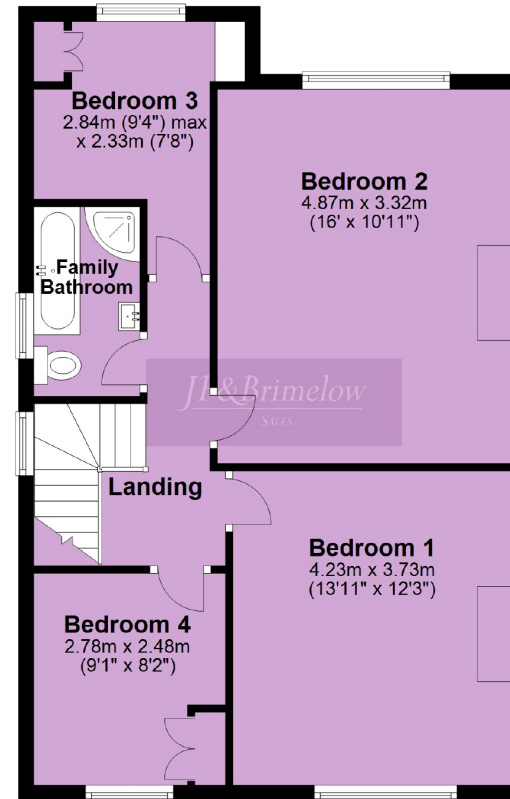

Chorlton & Didsbury Sales

430 Barlow Moor Road, Chorlton, Manchester, M21 8AD

Chorlton: 0161 882 2233 Didsbury: 0161 448 0622

E: [chorlton@jpbrimelow.co.uk](mailto:chorlton@jpbrimelow.co.uk) [www.jpandbrimelow.co.uk](http://www.jpandbrimelow.co.uk)



*JP&Brimelow*

SALES

NOTICE: JP & Brimelow Chorlton & Didsbury Ltd for themselves and for the vendors or lessors of this property whose agents they are give notice that:

- (i) the particulars are set out as a general outline only for the guidance of intending purchasers or lessees, and do not constitute, nor constitute part of, an offer or contract;
- (ii) all descriptions, dimensions, references to the condition and necessary permissions for use and occupation, and other details are given in good faith and are believed to be correct but any intending purchasers or tenants should not rely on them as statements or representations of fact but must satisfy themselves by inspection or otherwise as to the correctness of each of them;
- (iii) no person in the employment of JP & Brimelow Ltd has any authority to make or give any representation or warranty whatever in relation to this property.



Follow us on Twitter @jpandbrimelows