

Coming Soon

Two Bedroom Ground Floor Apartment
S2, Heeley

Speak to our Property Experts on
0114 245 9696 to find out more.



Myrtle Drive
Heeley, S2 3HG

£115,000

Overview

No Chain

Two Bedroom

Ground Floor

Fantastic Location

Master Bedroom with Ensuite

Close To Local Amenities



Description

SUMMARY Selling with NO CHAIN is this TWO bedroom GROUND floor apartment.

The apartment has a welcoming entrance hall with a cloak/airing cupboard, open plan lounge/dining room, and a modern fitted kitchen, this is a fantastic living area.

Two great sized bedrooms, the master benefits from an en-suite shower room, and a fully fitted bathroom services the second bedroom.

Externally you'll find allocated parking, additional residents and visitor's car parking spaces with attractive and communal gardens.

The property location is great for access into the city centre of Sheffield or a journey to Rotherham, Barnsley or Doncaster.



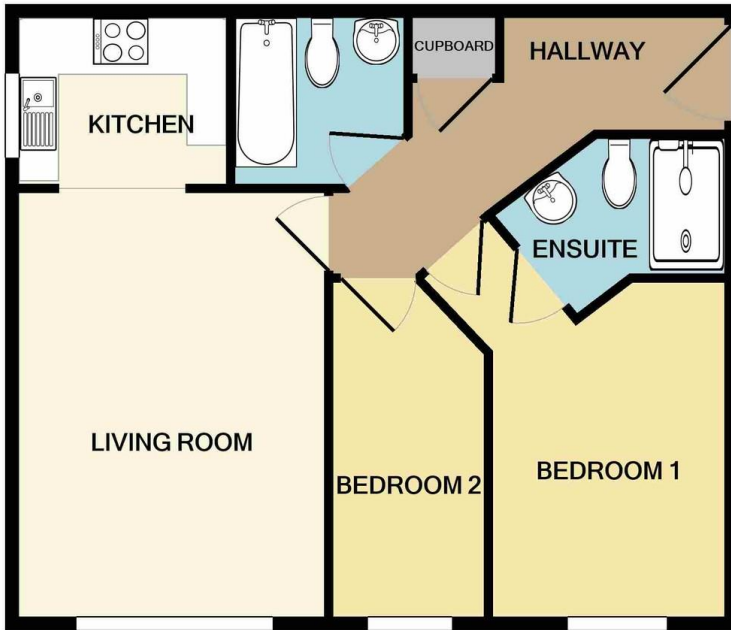

Score	Energy rating	Current	Potential
92+	A		
81-91	B		
69-80	C	80 C	80 C
55-68	D		
39-54	E		
21-38	F		
1-20	G		

Whilst every attempt has been made to ensure the accuracy of the floor plan contained here, measurements of doors, windows, rooms and any other items are approximate and no responsibility is taken for any error, omission, or mis-statement. This plan is for illustrative purposes only and should be used as such by any prospective purchaser. The services, systems and appliances shown have not been tested and no guarantee as to their operability or efficiency can be given
 Made with Metropix ©2020

AGENCY NOTE EPC Rating - C

Council Tax Band - A

Please note this apartment is currently being rented out.

Service Charge - £65 per month

Ground Rent - £100 per year

Years Remaining - 132 years

