



Steven Oates are delighted to offer for rental this very well presented two bedroom ground floor apartment in a central location in Hertford.

The property offers accommodation to include a lounge diner, fitted kitchen, two bedrooms, en suite shower room and family bathroom. The property has direct access on to the communal gardens and provides electric storage heating.

Located within minutes walk to Hertford Town Centre on Pegs Lane and convenient for access for both Hertford North and East Stations.

The property is available for immediate occupation and is offered unfurnished and has secure underground parking.

£1,100 pcm





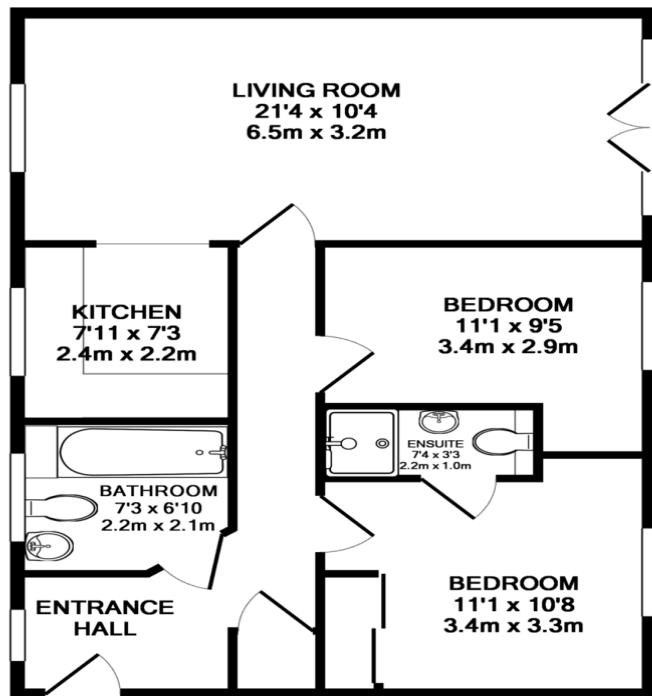

Whilst every attempt has been made to ensure the accuracy of the floor plan contained here, measurements of doors, windows, rooms and any other items are approximate and no responsibility is taken for any error, omission, or mis-statement. This plan is for illustrative purposes only and should be used as such by any prospective purchaser. The services, systems and appliances shown have not been tested and no guarantee as to their operability or efficiency can be given
Made with Metropix ©2018

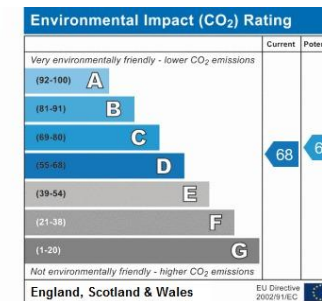
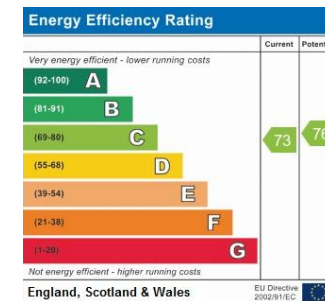



Whilst we endeavour to make our sales particulars fair, accurate and reliable, they are only intended as a general guide to the property. Measurements and distances are approximate. These particulars do not form part of any offer or contract. If there are important matters that are likely to affect your decision to buy, please contact us before viewing the property. Please note that we have not tested the services, equipment or appliances in this property, accordingly, we advise prospective buyers to commission their own survey or service reports before finalising any offer to purchase.