



Binns Road, London, W4 2BS

£1,095,000

**WHITMAN & CO.**

SALES · LETTINGS · COMMERCIAL



- Planning in place to extend into loft and side return
- Sought after 'Glebe Estate' location
- Victorian terraced cottage
- Moments from Chiswick High Road
- Private garden
- No chain

Tenure - Freehold  
Local Authority - Hounslow  
Council Tax - Band F

## THE PROPERTY

A three-bedroom period cottage, located on this quiet residential street in the heart of the 'Glebe Estate' with planning in place to extend on the ground floor and into the loft. The house is now in need of updating with the accommodation comprising a double reception room, kitchen/breakfast room, private garden, full-width master bedroom, two further bedrooms, family bathroom and a large loft. The approved plans are for a wrap-around ground floor extension incorporating a full-width kitchen/family room and a double loft conversion creating a large master suite. Binns Road is one of the most sought after roads on the Glebe Estate being just a few minutes walk from Chiswick High Road's extensive facilities. Transport links include Turnham Green station, local bus routes and the A4/M4 for routes in and out of London. No chain.

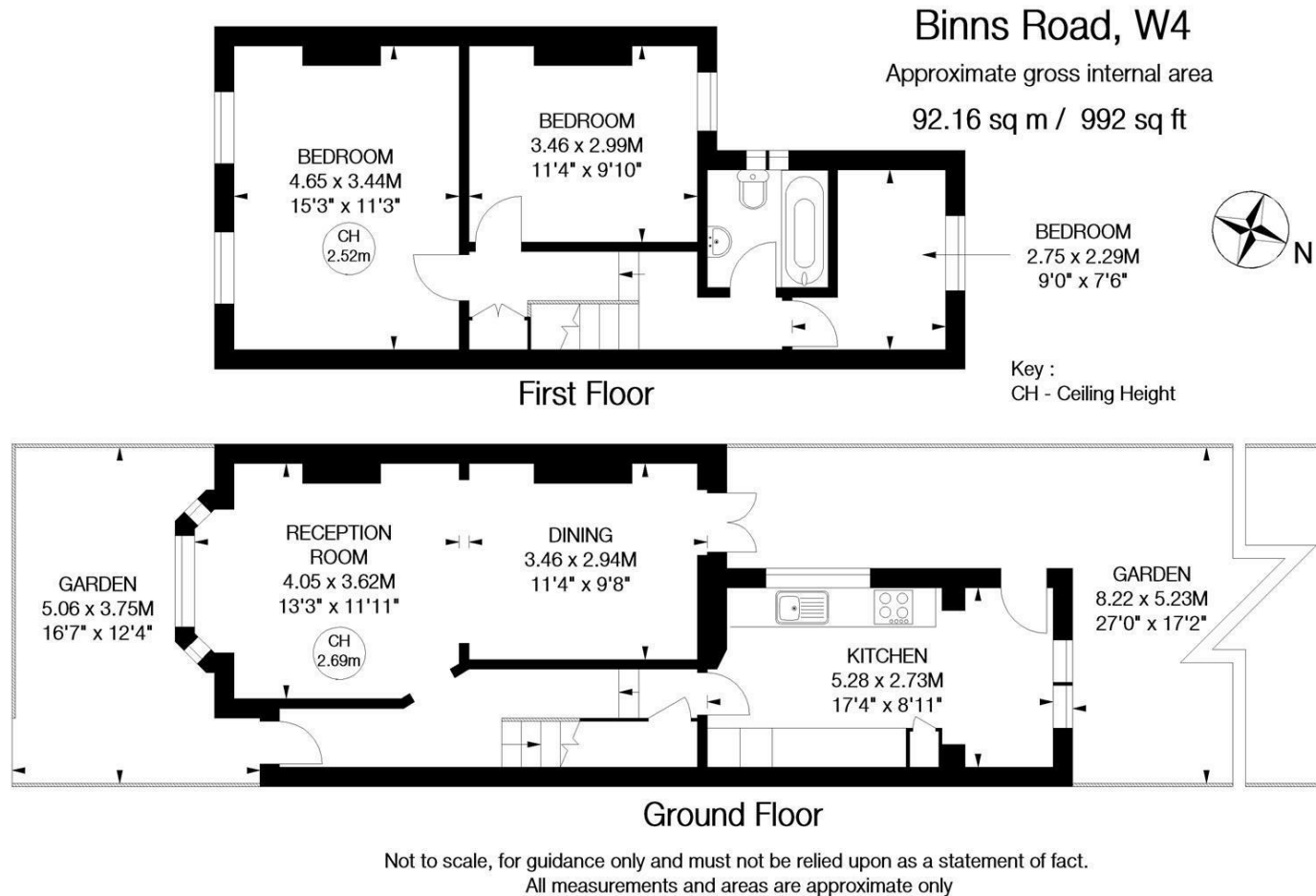

## SITUATION

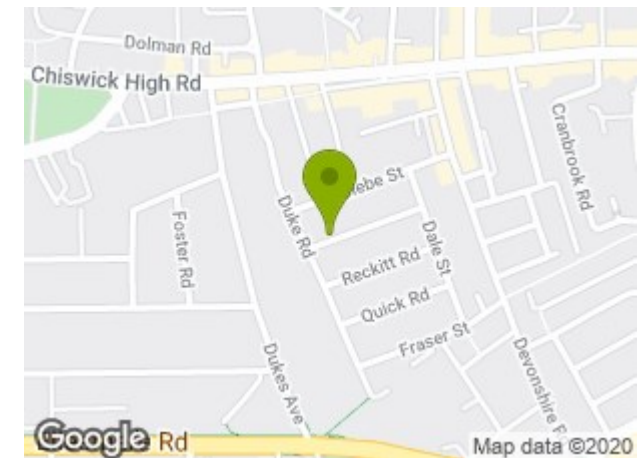

5-7 Turnham Green Terrace, Chiswick, London, W4 1RG

Tel 020 8747 8300

E-mail [sales@whitmanandco.com](mailto:sales@whitmanandco.com)

Website [www.whitmanandco.com](http://www.whitmanandco.com)