



Jordan Fishwick

WITHINGTON
Wilmslow Road



Wilmslow Road, Withington M20 4BT

Guide price £125,000



The Property

*****LANDLORDS ONLY***** An appealing ground floor apartment, forming part of an attractive period conversion with a convenient location which is within a 'short stroll' of Withington Village. Tastefully presented and benefiting from gas central heating and majority double glazing, the living space in outline comprises:- Communal entrance hall, private entrance hall, living room with walk-in bay window and high ceilings, re-fitted kitchen with modern units, good sized double bedroom with ample space for freestanding furniture and a contemporary shower room with chrome fittings. Currently tenanted till July 2021 @ £700pcm.

Directions

From our office proceed along Wilmslow Road in a northerly direction passing through the Barlow Moor Road and Fog Lane traffic lights. Continuing past 'The Christie' on the left hand side, the property can be found on the left hand side, just after passing Marriott Street. (SAT NAV:M20 3DA)



- Ground floor apartment
- Attractive period conversion
- Convenient location
- Gas central heating
- Majority double glazing
- Living room with bay window
- Re-fitted kitchen
- Double bedroom
- Contemporary shower room
- Let till July 2021 @ £700pcm

Postcode - M20 4BT

EPC Rating - D

Floor Area - 445 sq ft

Local Authority - Manchester City Council

Council Tax - Band A



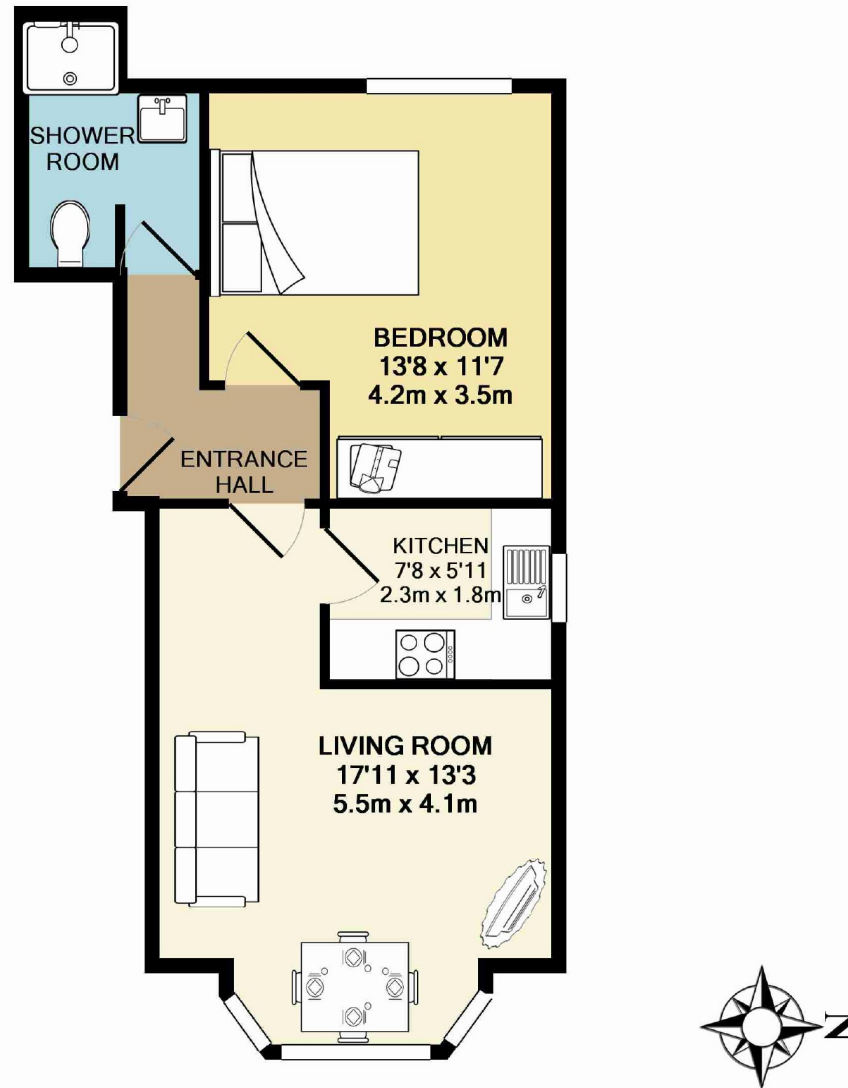

TOTAL APPROX. FLOOR AREA 445 SQ.FT. (41.3 SQ.M.)
 Measurements are approximate. Not to scale. Illustrative purposes only
 Made with Metropix ©2015



These particulars are believed to be accurate but they are not guaranteed and do not form a contract. Neither Jordan Fishwick nor the vendor or lessor accept any responsibility in respect of these particulars, which are not intended to be statements or representations of fact and any intending purchaser or lessee must satisfy himself by inspection or otherwise as to the correctness of each of the statements contained in these particulars. Any floorplans on this brochure are for illustrative purposes only and are not necessarily to scale.

Offices also at: Wilmslow, Macclesfield, Hale, Sale, Chorlton, Glossop, Manchester & Salford

757-759 Wilmslow Road, Didsbury Village, Manchester, M20

0161 445 4480

didsbury@jordanfishwick.co.uk
 www.jordanfishwick.co.uk