

****AVAILABLE SEPTEMBER 2021****

****FURNISHED**** Two bedroom first floor apartment located only a short walk from Newcastle city centre! This fantastic conversion offers a fully refurbished flat, furnished to a good standard and is walking distance to both Jesmond and the city centre, as well as being close to transport links for travelling further afield.

The accommodation briefly comprises a communal entrance hall with stairs to all floors. The apartment itself has an entrance hallway, a spacious corner lounge, modern re-fitted kitchen, two double bedrooms and a shower room WC. There is also a large storage cupboard housing a combi boiler.

With gas central heating and double glazed windows throughout, this conveniently located apartment is available to both students and professionals.

Available 3rd September 2021 | First Floor Apartment | £625pcm | 622 Sq. ft (57.8 m²) | Two Double Bedrooms | Lounge | Modern Fitted Kitchen | Shower Room WC | Permit Parking | Walking Distance To City Centre | Furnished | GCH & DG | EPC Rating: C

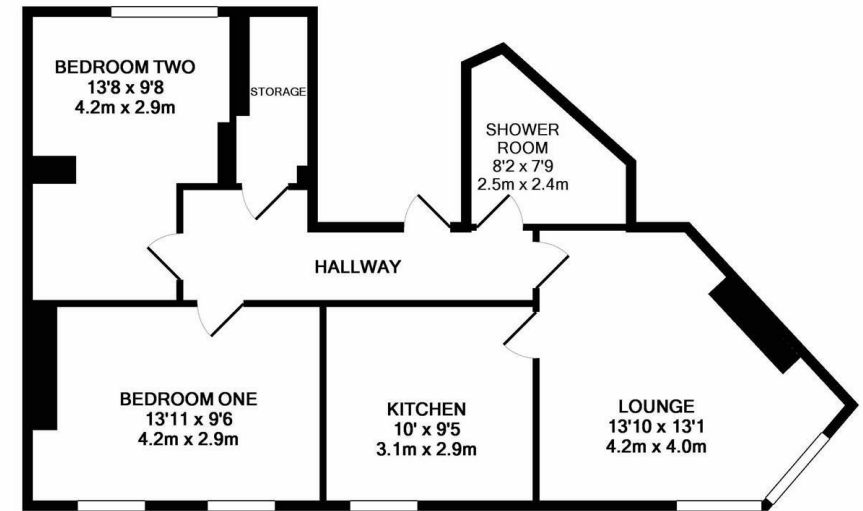

TOTAL APPROX. FLOOR AREA 622 SQ.FT. (57.8 SQ.M.)

Whilst every attempt has been made to ensure the accuracy of the floor plan contained here, measurements of doors, windows, rooms and any other items are approximate and no responsibility is taken for any error, omission, or mis-statement. This plan is for illustrative purposes only and should be used as such by any prospective purchaser. The services, systems and appliances shown have not been tested and no guarantee as to their operability or efficiency can be given
Made with Metropix ©2017

£625 PCM

Misrepresentation Act 1967. These particulars and the descriptions and measurements herein do not constitute representation and whilst every effort has been made to ensure accuracy, this cannot be guaranteed.

