



West Street, Sheerness

SUPERB INVESTMENT PURCHASE!! Lamborn & Hill are proud to offer to the market this well proportioned one bedroom flat set in a courtyard position. The flat has been refurbished to a very high standard and is just a short walk from the town centre, the train station and the beach! Accommodation comprises of a large open plan lounge and kitchen, a good size bedroom and a Shower Room. Externally the property has a shared courtyard garden. Properties in this price range are rarely available for long and as such an early call is strongly advised. **CALL NOW TO VIEW!**

Asking price £65,000

- ONE BEDROOM APARTMENT
- Shower Room
- Close To Town
- Shared Courtyard
- Lounge/Kitchen
- EPC Rating F (22)
- Central Town Location
- NO CHAIN





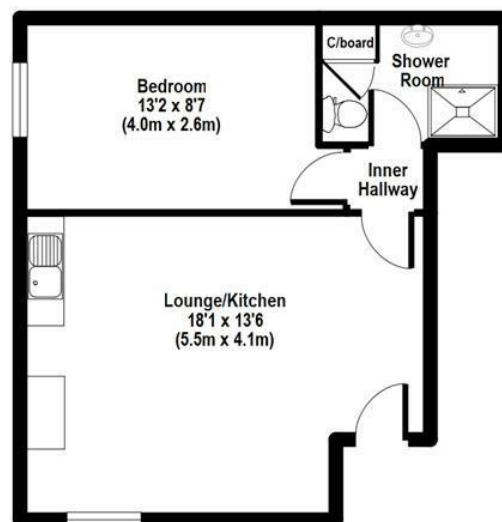

APPROX GROSS INTERNAL FLOOR AREA: 404 sq. ft / 38 sq. m

Royal Fountain Mews

FOR ILLUSTRATIVE PURPOSES ONLY. NOT TO SCALE

Whilst every attempt has been made to ensure the accuracy of the floor plan shown, all measurements, positioning, fixtures, features, fittings and any other data shown are an approximate interpretation for illustrative purposes only and are not to scale. No responsibility is taken for any error, omission, miss-statement or use of data shown.

The above statement applies to both 'The Floor Plan People' and the Company or individual displaying this floor plan.

(c) THE FLOOR PLAN PEOPLE unauthorised reproduction prohibited.

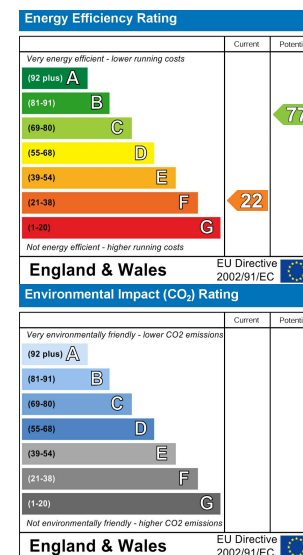

Lamborn & Hill have produced these details in good faith and believe they provide a fair and accurate description of the property being marketed. Following inspection and prior to financial commitment prospective buyers should satisfy themselves as to the property's suitability and make their own enquiries, relating to specific points of importance for example condition of items, permissions, approvals and regulations. The accuracy of these details are not guaranteed and they do not form part of any contract.

19-21 West Street, Sittingbourne, Kent, ME10 1AJ

T: 01795 293000

sittingbourne@lambornhill.com

www.lambornhill.com