



BLUEBELL ESTATES



37, Brindle Way, Lordswood, Chatham, ME5 8UA
£1,250 PCM

About this property.....

This 3 bedroom detached family home is located in a cul-de-sac position and is within a 0.3 mile walk of Swingate Primary School that was rated Good by Ofsted in November 2018. The property has a spacious, light and airy living room with French doors leading out onto a large decked area, which in turn leads to the lawned area of the garden. There is also a modern bathroom with an electric shower over the bath. The driveway offers parking for one car but please be aware the garage is not included. Call us now to arrange your viewing before you miss out.

Situation.....

The historic Medway town of Chatham is home to the major Dockyard attraction and the universities at Medway. Residents are spoilt for shopping choice, with a traffic-free High Street, the Pentagon Shopping Centre and Chatham Dockside Outlet Centre. Chatham Maritime is the place to head for leisure, with The Historic Dockyard visitor centre, a nine-screen cinema, bars, restaurants and the Royal Engineers Museum all close together. The area has road links to the M2 junction 3 giving access to London and the coast. Rail commuters can either drive to Chatham or Rochester stations which have journey times to London Victoria in around 50 minutes or our choice would be to drive for around 19 minutes to Ebbsfleet and be whisked in comfort on HS1 to London St Pancras in as little as 18 minutes.









Useful Information.....

SECURITY DEPOSIT = FIVE WEEKS' RENT

MINIMUM INCOME REQUIRED = £37,5000 pa

TENANTS WITH PETS = NOT ACCEPTABLE

TENANTS WHO SMOKE = NOT ACCEPTABLE

HOLDING DEPOSIT = ONE WEEKS' RENT

This is to reserve a property. Please Note: This will be withheld if any relevant person (including any guarantor(s)) withdraw from the tenancy, fail a Right-to-Rent check, provide materially significant false or misleading information, or fail to sign their tenancy agreement (and / or Deed of Guarantee) within 15 calendar days (or other Deadline for Agreement as mutually agreed in writing).

The pictures were taken prior to the property being rented, so condition, decoration and furnishings may vary slightly from those shown.

37, Brindle Way, Lordswood, Chatham, ME5 8UA

Ground Floor

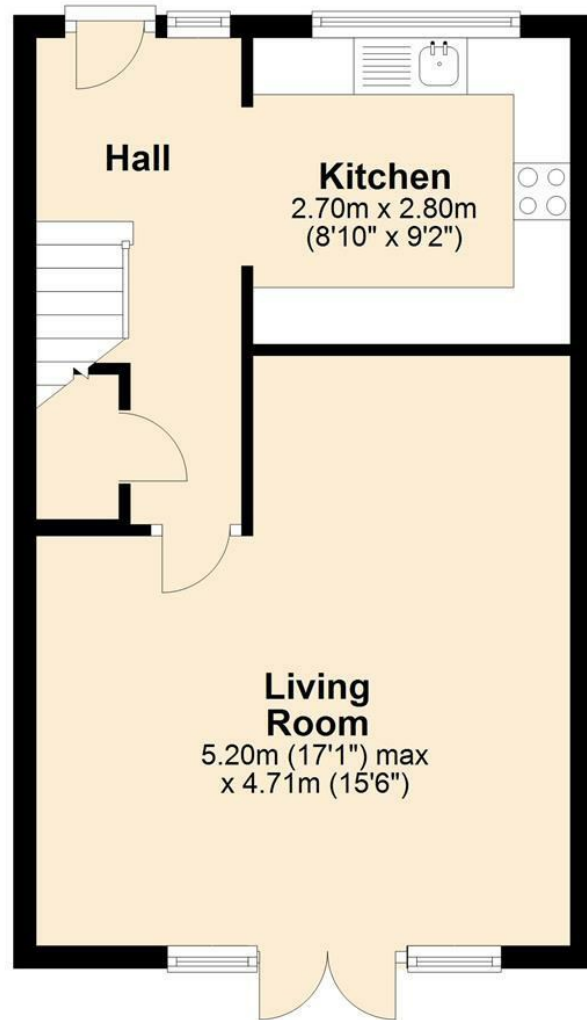

First Floor

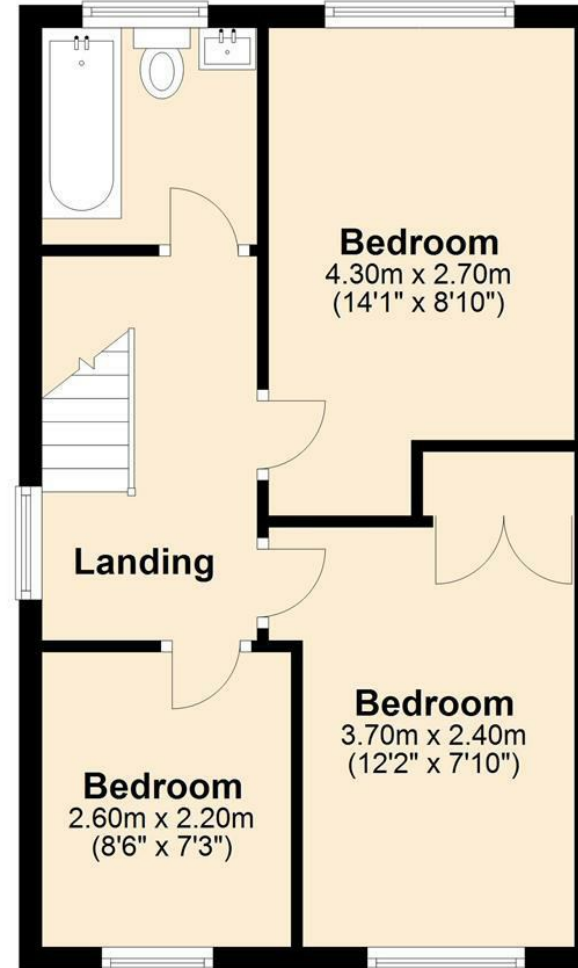

Total area: approx. 76.0 sq. metres (817.9 sq. feet)

Agents Notes

Floor plans produced for illustrative purposes only. The position and sizes of doors, windows, rooms and other items are approximate and no responsibility is taken for any error, omission or mis-statement. These particulars are produced for information only and do not form part of any contract. The agent has not had sight of any title documents. Fixtures, fittings and services not tested.

