

**Union Lane  
Isleworth  
TW7 6GL**

£1,095

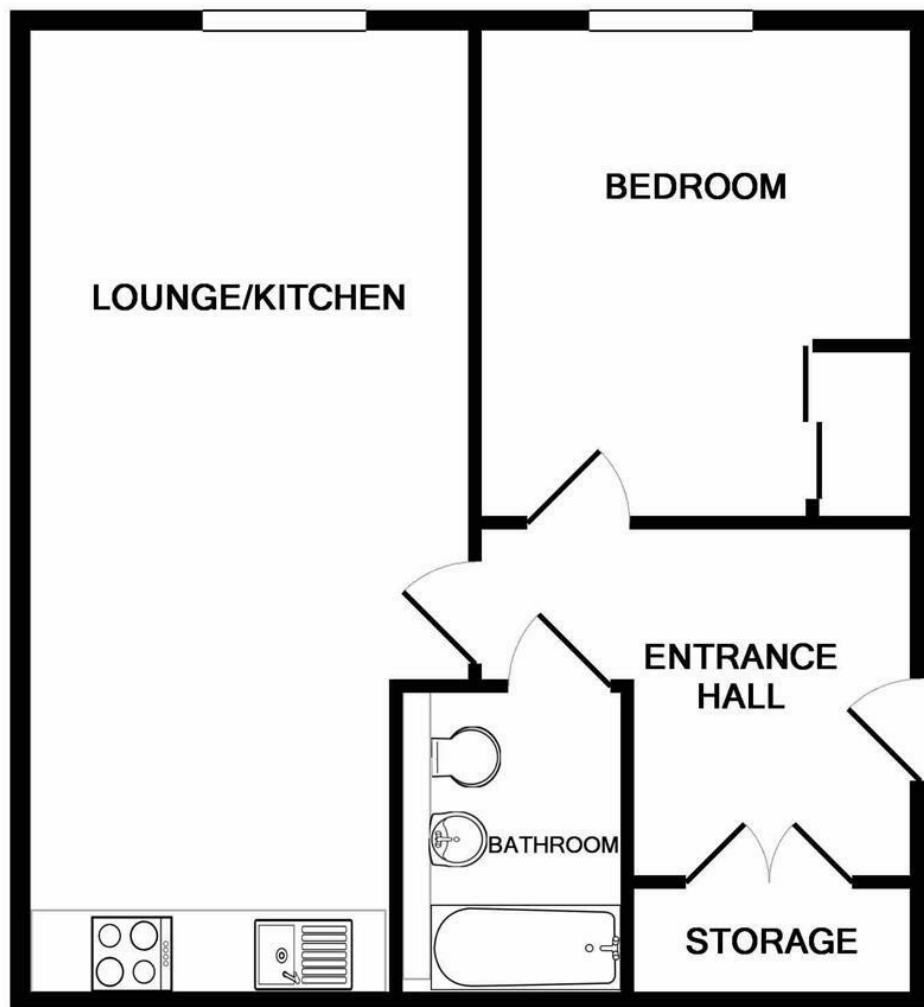



Produced solely for Chase Buchanan  
Made with Metropix ©2019

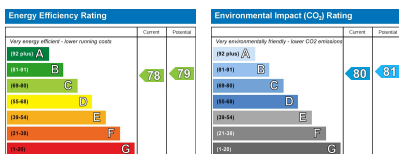

Care has been taken in the preparation of these particulars, however, their accuracy is not guaranteed and they do not form part of any contract. Measurements stated must be considered maximum.

- Modern development
- Bright and spacious
- Great location
- Communal gardens
- Ground floor
- EPC rating B

A beautiful one double bedroom apartment, offering an abundance of space.

Features include a spacious open plan lounge and modern kitchen, making this property a fantastic place to entertain family or friends. Further benefits include a double bedroom with built in wardrobes, a modern bathroom and ample storage throughout.

This is a great home that is set in a highly desirable location, with Syon Park just a short stroll away, and Syon Lane Station within a few minutes walk, great to get into London for work or a night out on the town. An ideal property for a professional couple or single tenant, viewings are highly advised.

Chase Buchanan are bonded members of ARLA Propertymark.

For more information or to book a viewing, please contact:

**020 8758 1755**

isleworth@chasebuchanan.london

7 Odeon Parade, 480 London Road,  
Isleworth, Middlesex, TW7 4DE

