



Furze Hill Crescent, Minster On Sea, Sheerness

CASH BUYERS ONLY - OFFERS IN EXCESS OF £220,000 - Call now, available to the market is this property bursting with potential for the new occupants. Decent room sizes, plenty of parking and so much scope for extension, this is an ideal opportunity for someone looking to put their own stamp on a family home. The location is superb, having the benefit of an elevated position there are spectacular views across the island from both the top of the garden and upper level of the property. Internally there is good living space on offer and whilst there is some updating required, the extensive gardens to both rear and side should more than make up for this. An internal viewing must be arranged to fully appreciate what is on offer. **NO ONWARD CHAIN!**

Offers In Excess Of £220,000

- CASH BUYERS ONLY
- Fantastic Potential
- Previous Plans Agreed for 2 Storey Side Extension (Ref SW/07/0084)
- Huge Rear Garden
- EPC Rating D (66)
- Loft Room
- Views Across Island
- **NO ONWARD CHAIN!**





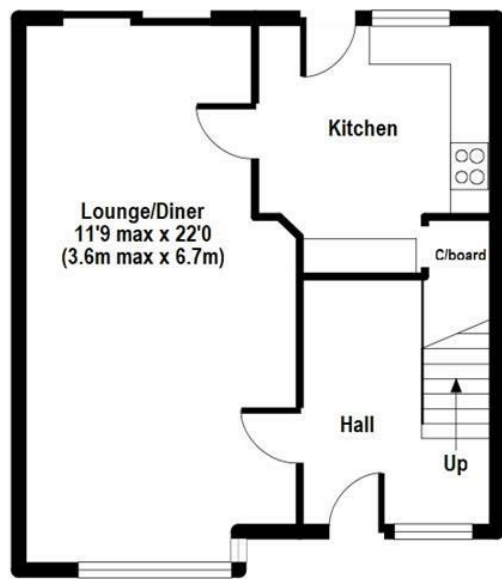

Ground Floor

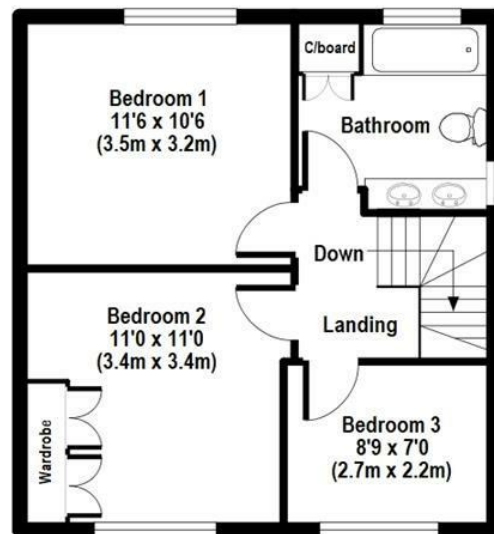

First Floor

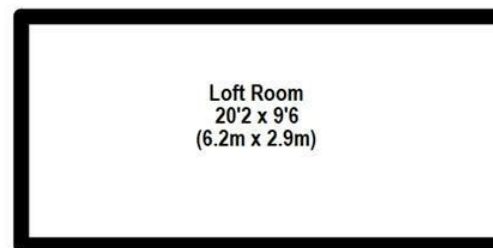

Second Floor

APPROX GROSS INTERNAL FLOOR AREA: 1067 sq. ft / 99 sq. m

Furze Hill Crescent

FOR ILLUSTRATIVE PURPOSES ONLY. NOT TO SCALE.
 Whilst every attempt has been made to ensure the accuracy of the floor plan shown, all measurements, positioning, fixtures, features, fittings and any other data shown are an approximate interpretation for illustrative purposes only and are not to scale. No responsibility is taken for any error, omission, miss-statement or use of data shown.
 The above statement applies to both 'The Floor Plan People' and the Estate Agent marketing this property.
 (c) THE FLOOR PLAN PEOPLE unauthorised reproduction prohibited.

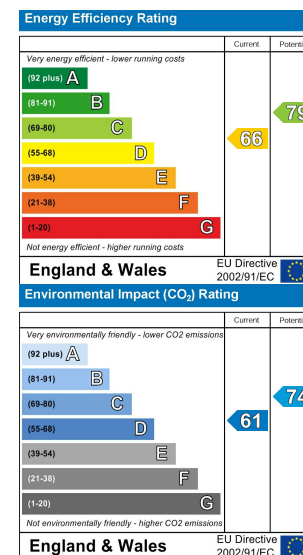

Lamborn & Hill have produced these details in good faith and believe they provide a fair and accurate description of the property being marketed. Following inspection and prior to financial commitment prospective buyers should satisfy themselves as to the property's suitability and make their own enquiries, relating to specific points of importance for example condition of items, permissions, approvals and regulations. The accuracy of these details are not guaranteed and they do not form part of any contract.